

WAREHOUSE SPACE FOR LEASE

LITTLE ORCHARD BUSINESS PARK

196 BARNARD AVENUE
SAN JOSE, CA



PROPERTY HIGHLIGHTS

- + ±24,415 Square Feet
- + ±3,288 Square Foot Office
- + ±21,031 Square Foot Warehouse
- + 4 Dock High Doors
- + 1 Grade Level Door
- + Available Now



CONTACT US

CHIP SUTHERLAND

Executive Vice President
Lic #01014633
+1 408 453 7410
chip.sutherland@cbre.com

FRANK FRIEDRICH

Senior Vice President
Lic #01159876
+1 408 282 3813
frank.friedrich@colliers.com

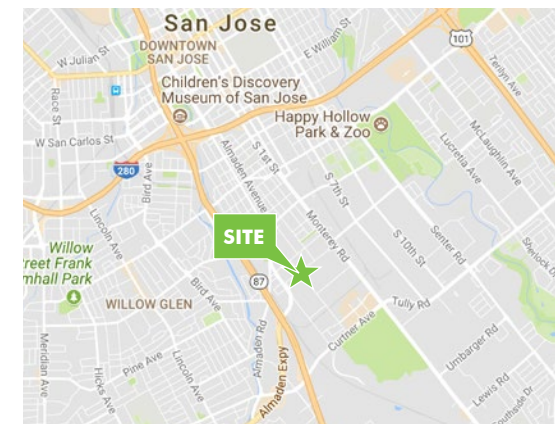

www.cbre.com/siliconvalley

CBRE

FOR LEASE LITTLE ORCHARD BUSINESS PARK

196
BARNARD AVENUE
San Jose :: CA



SITE/FLOOR PLAN

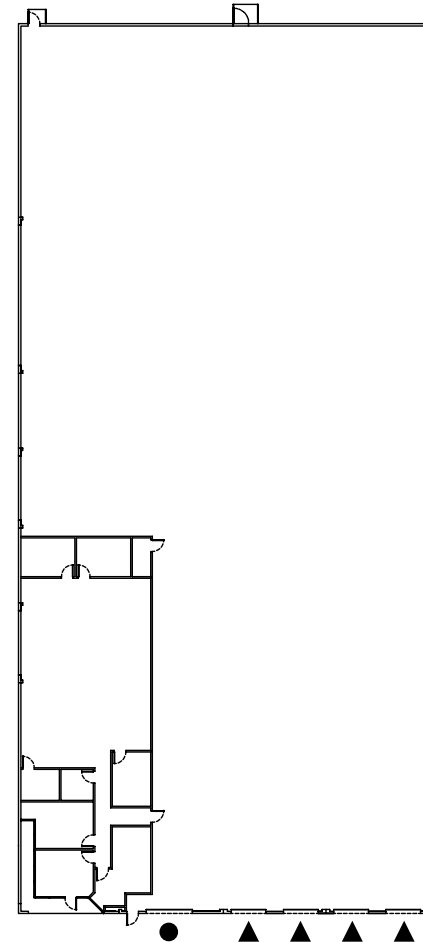
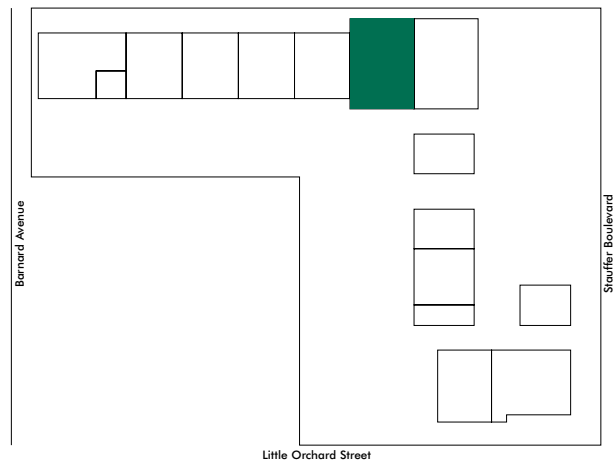

- ▲ DOCK DOORS
- GRADE LEVEL DOORS

NOT TO SCALE

© 2017 CBRE, Inc. This information has been obtained from sources believed reliable. We have not verified it and make no guarantee, warranty or representation about it. Any projections, opinions, assumptions or estimates used are for example only and do not represent the current or future performance of the property. You and your advisors should conduct a careful, independent investigation of the property to determine to your satisfaction the suitability of the property for your needs. CBRE and the CBRE logo are service marks of CBRE, Inc. and/or its affiliated or related companies in the United States and other countries. All other marks displayed on this document are the property of their respective owners. _data\15\Team-Marketing\Little Orchard Business Center\196 Barnard Ave\196 Barnard Ave_V01.indd

Photos herein are the property of their respective owners and use of these images without the express written consent of the owner is prohibited.

www.cbre.com/siliconvalley

CBRE