

FOR LEASE > ±11,044 SF

Renton Commerce Center

3600 LIND AVENUE SW, SUITE 120 | RENTON, WASHINGTON



AVAILABILITY AND FEATURES

- > 11,044 SF total
- > 2,238 SF office
- > 3 dock-high doors
- > 1 grade-level door
- > 24' clear height
- > Strong corporate image
- > Available June 1, 2019
- > Call for asking rates

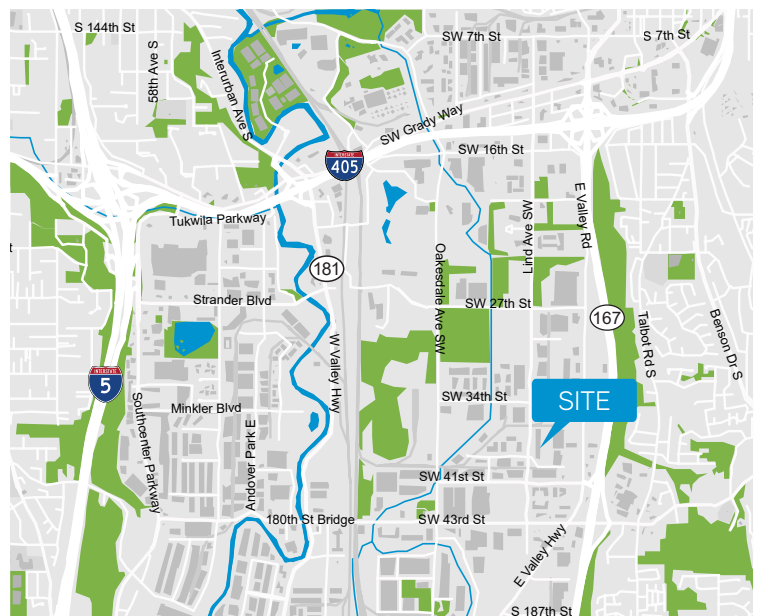

MATT MCGREGOR
+1 206 624 7401
SEATTLE, WA
matt.mcgregor@colliers.com

BILL CONDON
+1 206 624 7400
SEATTLE, WA
bill.condon@colliers.com

COLLIERS INTERNATIONAL
601 Union Street, Suite 5300
Seattle, WA 98101
www.colliers.com

FOR LEASE > ±11,044 SF

Renton Commerce Center

3600 LIND AVENUE SW, SUITE 120 | RENTON, WASHINGTON



SPACE PLAN

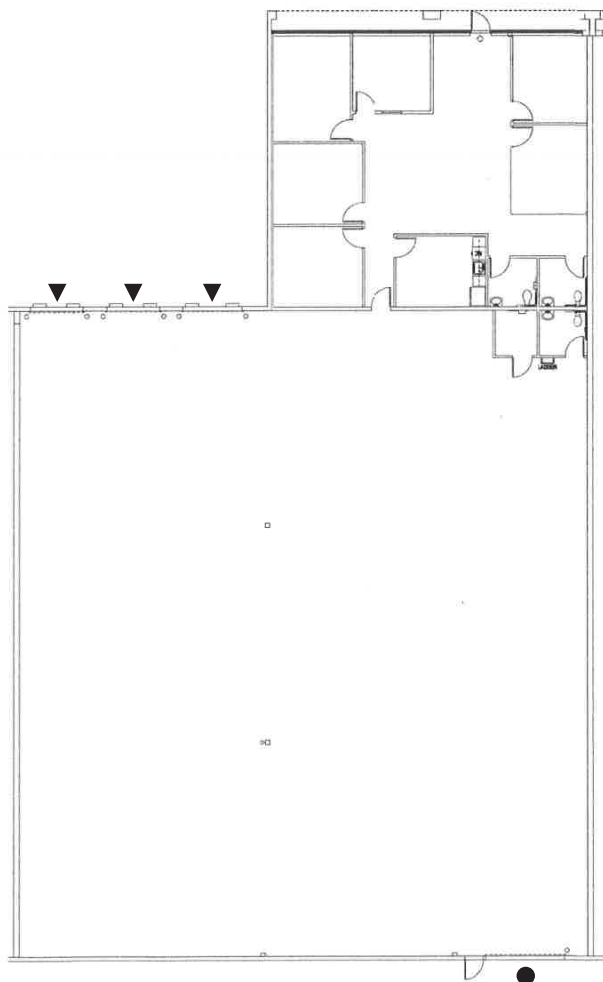

Suite 120

Warehouse	8,806 SF
Office	2,238 SF
Total Available	11,044 SF

- ▲ Dock-high door
- Grade-level door

SITE PLAN

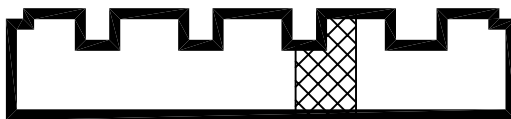

This document has been prepared by Colliers International for advertising and general information only. Colliers International makes no guarantees, representations or warranties of any kind, express or implied, regarding the information including, but not limited to, warranties of content, accuracy and reliability. Any interested party should undertake their own inquiries as to the accuracy of the information. Colliers International excludes unequivocally all inferred or implied terms, conditions and warranties arising out of this document and excludes all liability for loss and damages arising there from. Colliers International is a worldwide affiliation of independently owned and operated companies. This publication is the copyrighted property of Colliers International and /or its licensor(s). © 2018. All rights reserved.

MATT MCGREGOR
+1 206 624 7401
SEATTLE, WA
matt.mcgregor@colliers.com

BILL CONDON
+1 206 624 7400
SEATTLE, WA
bill.condon@colliers.com

COLLIERS INTERNATIONAL
601 Union Street, Suite 5300
Seattle, WA 98101
www.colliers.com