

colliers.com

# Smithfield Building

## Class A Medical/Office Space

THE  
RMR  
GROUP

### BUILDING FEATURES

- Three-story, Class A, medical/office building
- Vast open three-story atrium
- Large flexible floor plates with extensive window lines
- Pedestrian sky bridges and a grand staircase
- Centrally located off Kempsville Road in Norfolk
- Directly across from Sentara Leigh Hospital
- Excellent access to I-64 and I-264
- Professional on-site management and maintenance

Rental Rate:

**\$22.50**  
PSF FS

**FOR LEASE** | 6160 Kempsville Circle, Norfolk | VA 23502

Contact us:

**Chris Kieran**

Senior Vice President  
Healthcare Services  
+1 757 228 1867  
chris.kieran@colliers.com

**Pat Mugler**

Executive Vice President  
+1 757 228 1831  
pat.mugler@colliers.com

Accelerating success.



Colliers International  
150 West Main St | Suite 1100  
Norfolk, VA 23510  
P: +1 757 490 3300  
F: +1 757 490 1200





## Suites Available

Space	Square Footage	Availability
Suite 110A	2,584 RSF	Vacant - Available Now
Suite 300A	3,327 RSF	Vacant - Available Now
Suite 311B	1,053 RSF	Vacant - Available Now
Suite 314A	1,484 RSF	Vacant - Available Now
Suite 322A	1,268 RSF	Vacant - Available Now

Space	Square Footage	Availability
Suite 323A	2,008 RSF	Vacant - Available Now

**FOR LEASE** | 6160 Kempsville Circle, Norfolk | VA 23502

Contact us:

**Chris Kieran**

Senior Vice President

Healthcare Services

+1 757 228 1867

chris.kieran@colliers.com

**Pat Mugler**

Executive Vice President

+1 757 228 1831

pat.mugler@colliers.com



## FLOOR PLANS

### FIRST FLOOR

- Suite 110A - 2,584 RSF

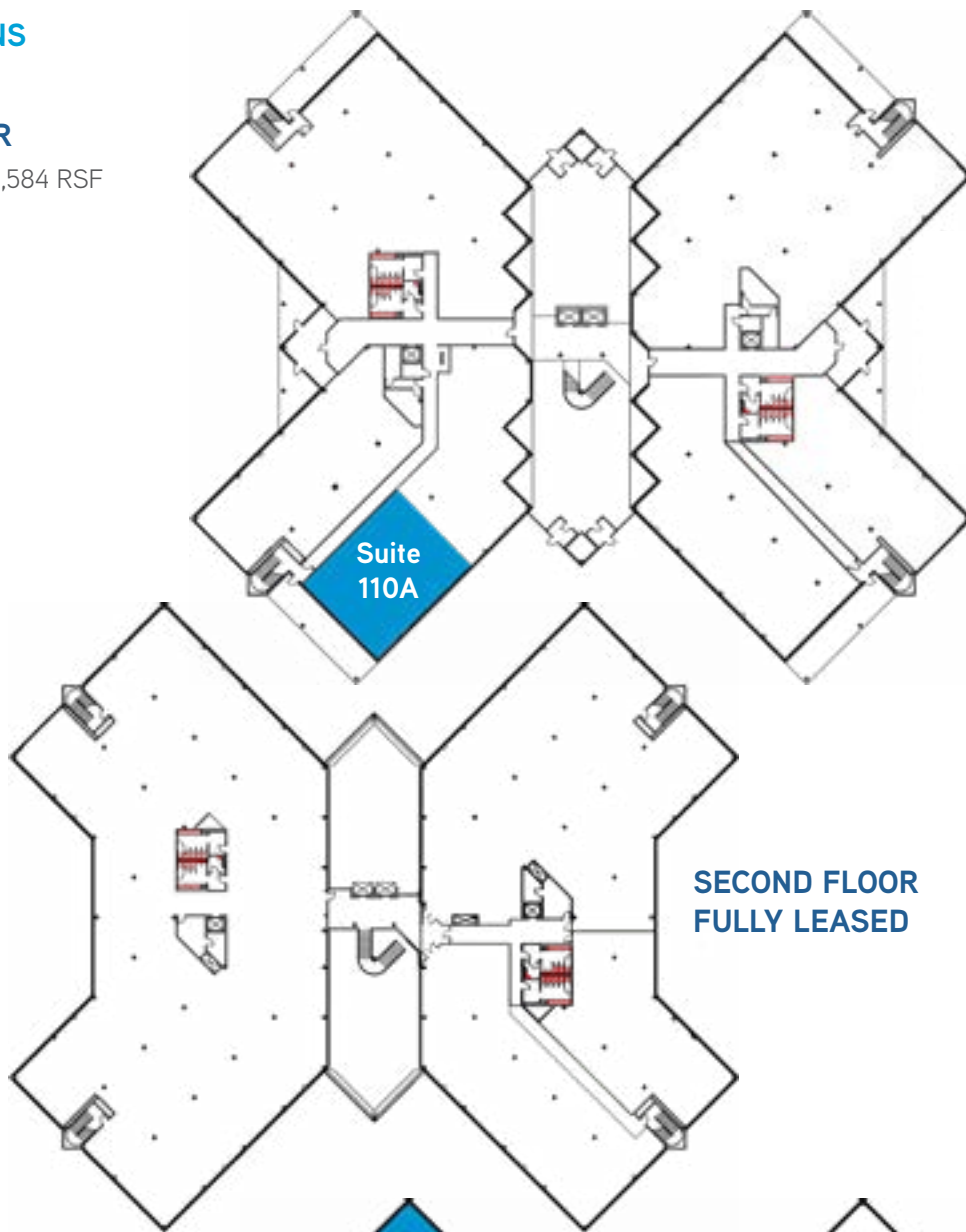

**SECOND FLOOR  
FULLY LEASED**

### THIRD FLOOR

- Suite 300A - 3,327 RSF
- Suite 311B - 1,053 RSF
- Suite 314A - 1,484 RSF
- Suite 322A - 1,268 RSF
- Suite 323A - 2,008 RSF

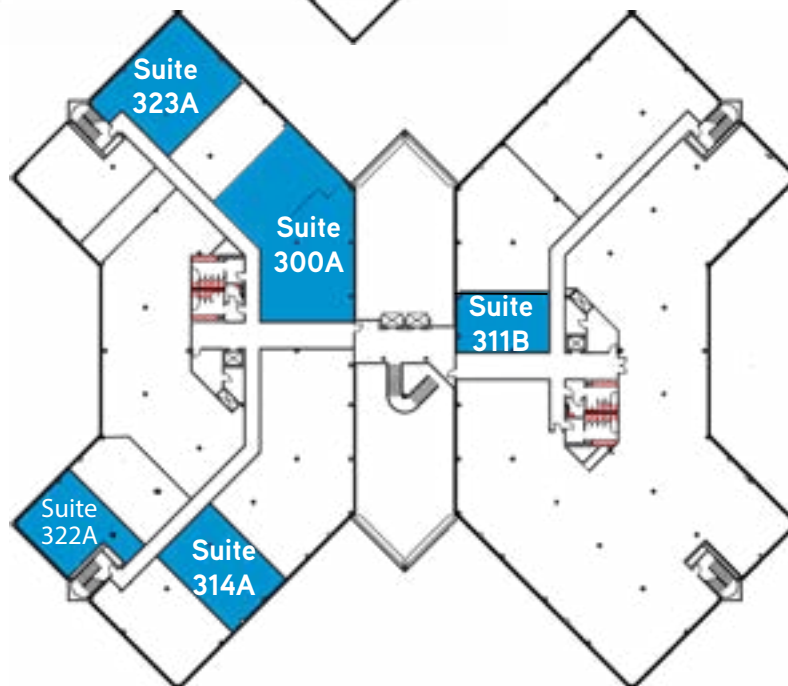

THE  
RMR  
GROUP

Colliers  
INTERNATIONAL



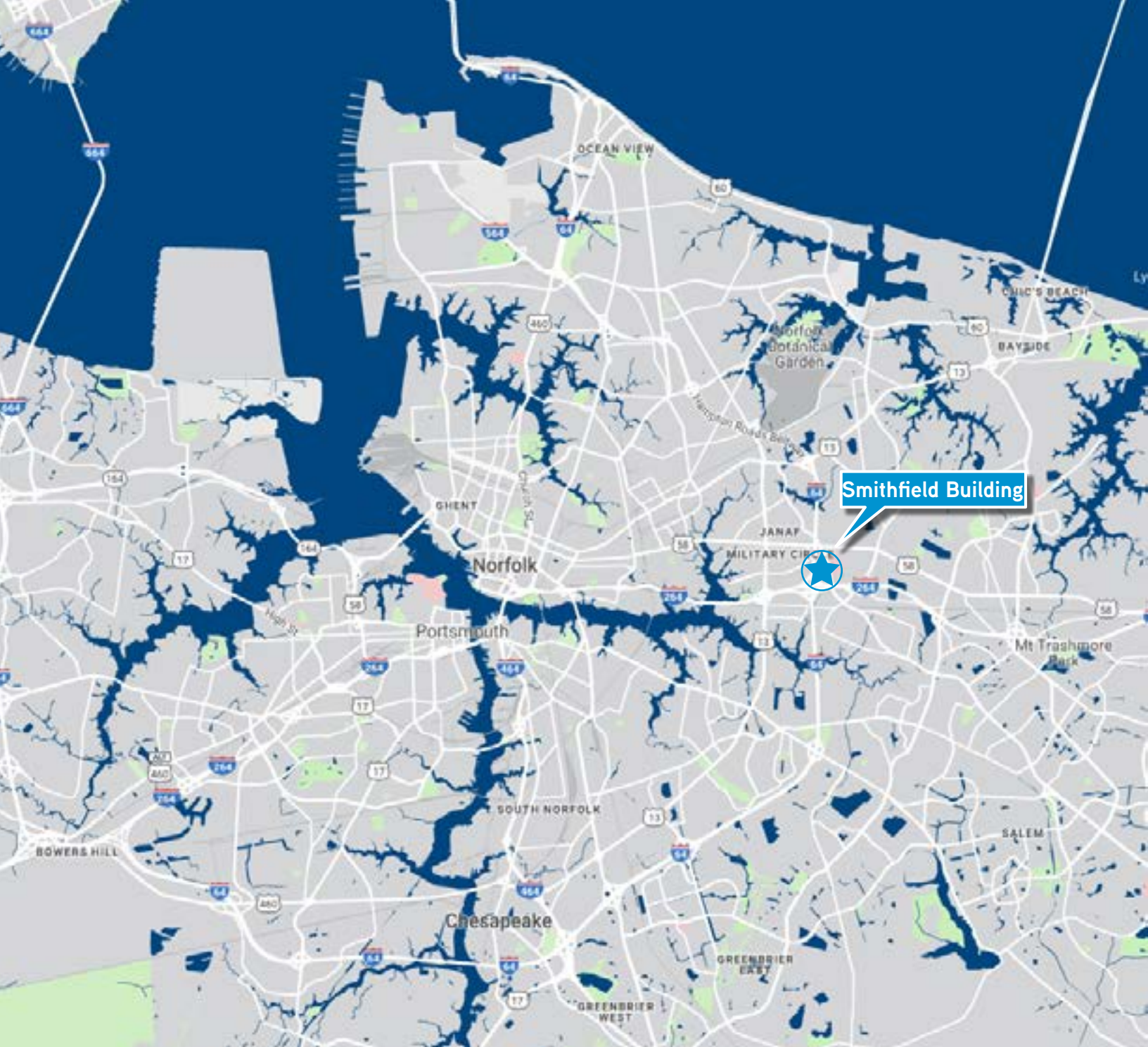

[colliers.com](https://colliers.com)

Contact us:

**Chris Kieran**

Senior Vice President

Healthcare Services

+1 757 228 1867

[chris.kieran@colliers.com](mailto:chris.kieran@colliers.com)

**Pat Mugler**

Executive Vice President

+1 757 228 1831

[pat.mugler@colliers.com](mailto:pat.mugler@colliers.com)

**Colliers International** | 150 West Main St | Suite 1100 | Norfolk, VA 23510

P: +1 757 490 3300 | F: +1 757 490 1200

This document has been prepared by Colliers International for advertising and general information only. Colliers International makes no guarantees, representations or warranties of any kind, expressed or implied, regarding the information including, but not limited to, warranties of content, accuracy and reliability. Any interested party should undertake their own inquiries as to the accuracy of the information. Colliers International excludes unequivocally all inferred or implied terms, conditions and warranties arising out of this document and excludes all liability for loss and damages arising there from. This publication is the copyrighted property of Colliers International and/or its licensor(s).

©2019. All rights reserved.

THE  
RMR  
GROUP

**Colliers**  
INTERNATIONAL