

## FIRST FLOOR

Hanco Building- 3650 Dodd Road, Eagan, MN

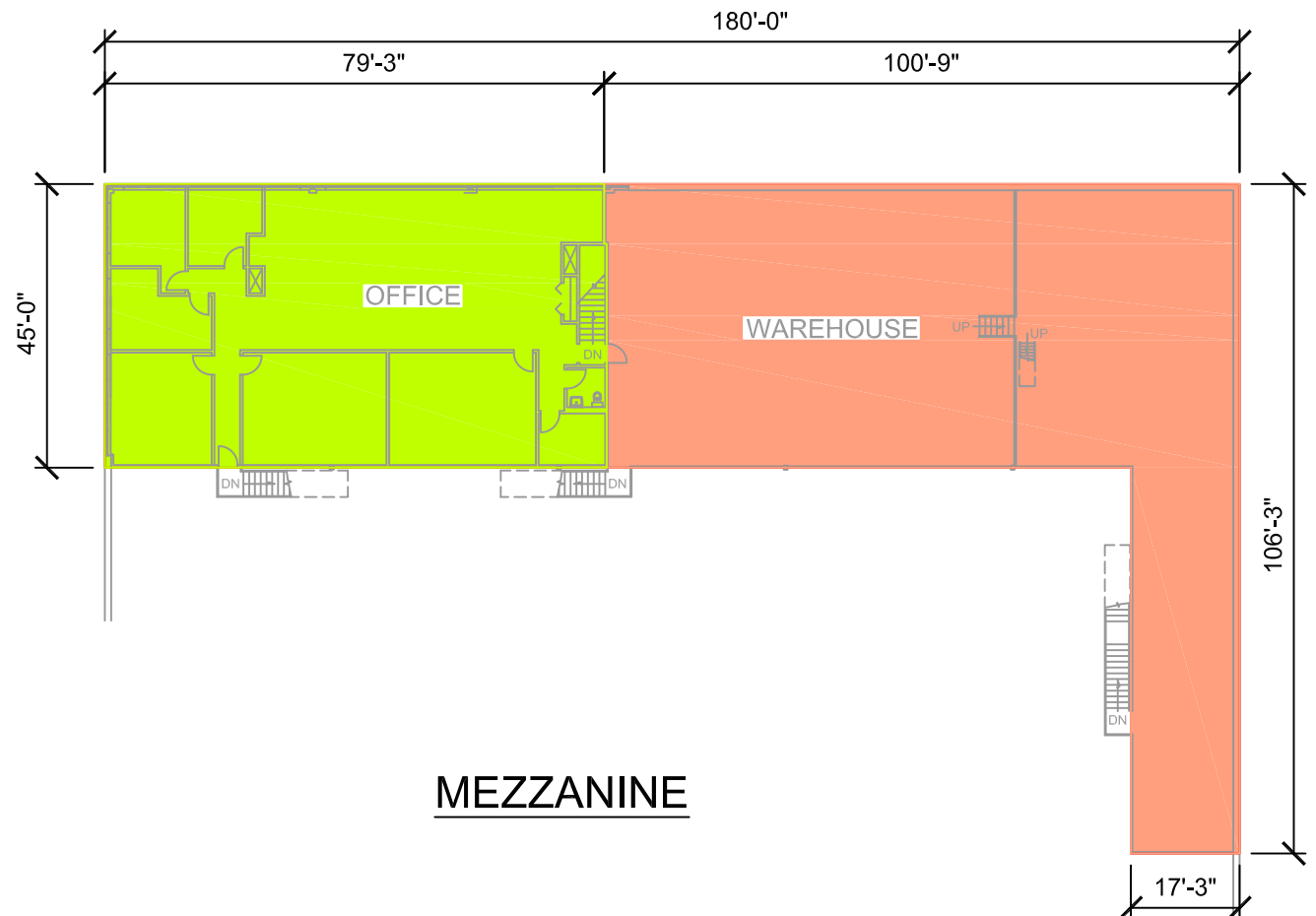

## MEZZANINE

## AREA CALCULATIONS

### FIRST FLOOR

Office Area	3,838 SF
Garage Area	1,476 SF
Warehouse Area	22,586 SF
Total First Floor Area	27,900 SF

### MEZZANINE FLOOR

Office Area	3,578 SF
Warehouse Area	5,578 SF
Total Mezzanine Floor Area	9,156 SF