



## Site Map

7004 139th Ln NW, Ramsey, Minnesota, 55303

Rings: 1, 3, 5 mile radii

Prepared by Esri

Latitude: 45.22375

Longitude: -93.44438

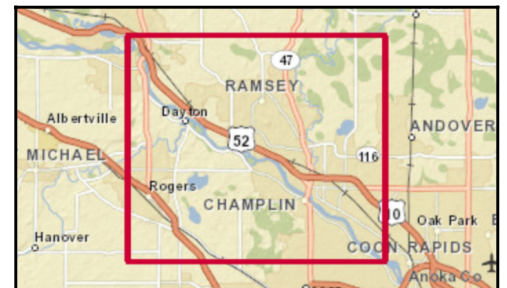
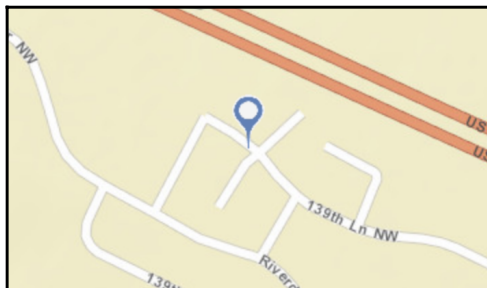
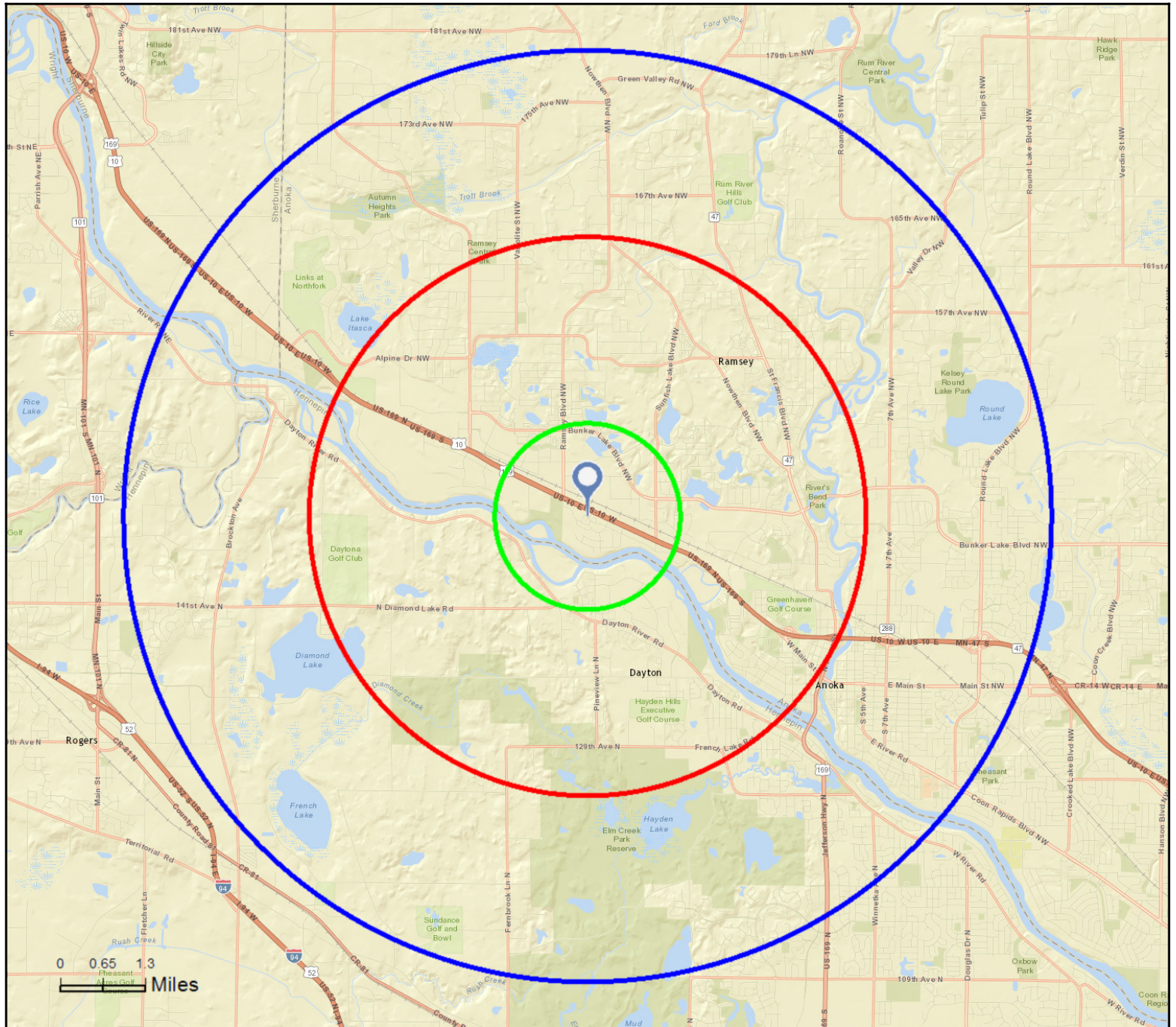

November 09, 2015



## Executive Summary

7004 139th Ln NW, Ramsey, Minnesota, 55303  
Rings: 1, 3, 5 mile radii

Prepared by Esri  
Latitude: 45.22375  
Longitude: -93.44438

	1 mile	3 miles	5 miles
<b>Population</b>			
2000 Population	2,286	22,549	63,753
2010 Population	2,622	26,776	70,459
2015 Population	2,888	27,882	72,438
2020 Population	3,096	29,225	75,313
2000-2010 Annual Rate	1.38%	1.73%	1.01%
2010-2015 Annual Rate	1.86%	0.77%	0.53%
2015-2020 Annual Rate	1.40%	0.95%	0.78%
2015 Male Population	51.4%	50.3%	50.0%
2015 Female Population	48.6%	49.7%	50.0%
2015 Median Age	36.0	35.5	37.4

In the identified area, the current year population is 72,438. In 2010, the Census count in the area was 70,459. The rate of change since 2010 was 0.53% annually. The five-year projection for the population in the area is 75,313 representing a change of 0.78% annually from 2015 to 2020. Currently, the population is 50.0% male and 50.0% female.

### Median Age

The median age in this area is 36.0, compared to U.S. median age of 37.9.

### Race and Ethnicity

2015 White Alone	87.0%	88.2%	88.3%
2015 Black Alone	6.2%	5.0%	4.5%
2015 American Indian/Alaska Native Alone	0.4%	0.5%	0.6%
2015 Asian Alone	2.2%	2.5%	2.8%
2015 Pacific Islander Alone	0.1%	0.0%	0.0%
2015 Other Race	2.1%	1.1%	1.2%
2015 Two or More Races	2.0%	2.7%	2.6%
2015 Hispanic Origin (Any Race)	5.1%	3.9%	3.5%

Persons of Hispanic origin represent 3.5% of the population in the identified area compared to 17.6% of the U.S. population. Persons of Hispanic Origin may be of any race. The Diversity Index, which measures the probability that two people from the same area will be from different race/ethnic groups, is 27.0 in the identified area, compared to 63.0 for the U.S. as a whole.

### Households

2000 Households	778	7,794	22,551
2010 Households	945	9,595	25,962
2015 Total Households	1,060	10,114	26,982
2020 Total Households	1,141	10,640	28,145
2000-2010 Annual Rate	1.96%	2.10%	1.42%
2010-2015 Annual Rate	2.21%	1.01%	0.74%
2015-2020 Annual Rate	1.48%	1.02%	0.85%
2015 Average Household Size	2.72	2.74	2.66

The household count in this area has changed from 25,962 in 2010 to 26,982 in the current year, a change of 0.74% annually. The five-year projection of households is 28,145, a change of 0.85% annually from the current year total. Average household size is currently 2.66, compared to 2.69 in the year 2010. The number of families in the current year is 19,335 in the specified area.

**Data Note:** Income is expressed in current dollars

**Source:** U.S. Census Bureau, Census 2010 Summary File 1. Esri forecasts for 2015 and 2020. Esri converted Census 2000 data into 2010 geography.

November 09, 2015



## Executive Summary

7004 139th Ln NW, Ramsey, Minnesota, 55303  
Rings: 1, 3, 5 mile radii

Prepared by Esri  
Latitude: 45.22375  
Longitude: -93.44438

	1 mile	3 miles	5 miles
<b>Median Household Income</b>			
2015 Median Household Income	\$78,845	\$75,101	\$74,751
2020 Median Household Income	\$86,721	\$83,601	\$83,025
2015-2020 Annual Rate	1.92%	2.17%	2.12%
<b>Average Household Income</b>			
2015 Average Household Income	\$93,049	\$86,550	\$87,132
2020 Average Household Income	\$103,979	\$97,229	\$98,074
2015-2020 Annual Rate	2.25%	2.35%	2.39%
<b>Per Capita Income</b>			
2015 Per Capita Income	\$33,136	\$31,381	\$32,562
2020 Per Capita Income	\$37,250	\$35,379	\$36,757
2015-2020 Annual Rate	2.37%	2.43%	2.45%

### Households by Income

Current median household income is \$74,751 in the area, compared to \$53,217 for all U.S. households. Median household income is projected to be \$83,025 in five years, compared to \$60,683 for all U.S. households

Current average household income is \$87,132 in this area, compared to \$74,699 for all U.S. households. Average household income is projected to be \$98,074 in five years, compared to \$84,910 for all U.S. households

Current per capita income is \$32,562 in the area, compared to the U.S. per capita income of \$28,597. The per capita income is projected to be \$36,757 in five years, compared to \$32,501 for all U.S. households

<b>Housing</b>			
2000 Total Housing Units	789	7,881	22,904
2000 Owner Occupied Housing Units	752	6,326	17,660
2000 Renter Occupied Housing Units	27	1,468	4,891
2000 Vacant Housing Units	10	87	353
2010 Total Housing Units	993	10,007	27,188
2010 Owner Occupied Housing Units	864	7,622	20,113
2010 Renter Occupied Housing Units	81	1,973	5,849
2010 Vacant Housing Units	48	412	1,226
2015 Total Housing Units	1,089	10,409	28,056
2015 Owner Occupied Housing Units	963	8,000	20,806
2015 Renter Occupied Housing Units	98	2,114	6,176
2015 Vacant Housing Units	29	295	1,074
2020 Total Housing Units	1,175	10,947	29,302
2020 Owner Occupied Housing Units	1,035	8,430	21,756
2020 Renter Occupied Housing Units	106	2,210	6,389
2020 Vacant Housing Units	34	307	1,157

Currently, 74.2% of the 28,056 housing units in the area are owner occupied; 22.0%, renter occupied; and 3.8% are vacant. Currently, in the U.S., 55.7% of the housing units in the area are owner occupied; 32.8% are renter occupied; and 11.6% are vacant. In 2010, there were 27,188 housing units in the area - 74.0% owner occupied, 21.5% renter occupied, and 4.5% vacant. The annual rate of change in housing units since 2010 is 1.41%. Median home value in the area is \$223,514, compared to a median home value of \$200,006 for the U.S. In five years, median value is projected to change by 2.85% annually to \$257,250.

**Data Note:** Income is expressed in current dollars

**Source:** U.S. Census Bureau, Census 2010 Summary File 1. Esri forecasts for 2015 and 2020. Esri converted Census 2000 data into 2010 geography.

November 09, 2015