

FOR LEASE > OFFICE SPACE



Northdale Plaza

13980, 14000, 14040 NORTHDAL BLVD., ROGERS, MN 55374



Medical / Retail / Office Space

Northdale Plaza is a three building, one-story office complex located on the west side of Highway 101 in Rogers, Minnesota. As medical office space, the complex offers the benefit of many practices in one easy to find location.

Building Amenities

- > Perfect for medical / retail use
- > Convenient location just off Highway 101 in Rogers
- > Easy access to I-94
- > On-building signage available
- > High visibility from Highway 101
- > Anchor tenants:
 - > Fairview
 - > Partners in Pediatrics
- > Many area amenities, including restaurants and retail shops

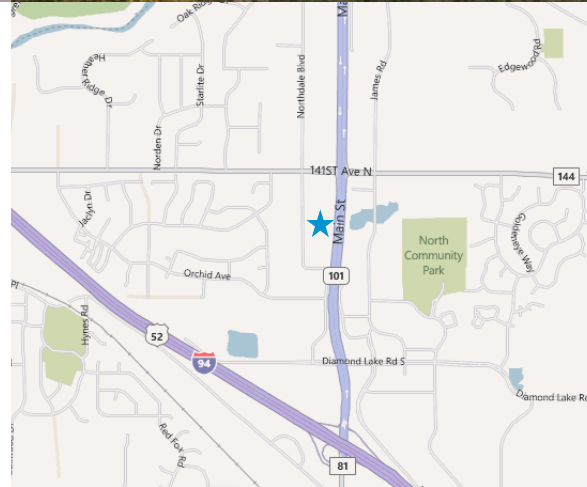

COLLIERS INTERNATIONAL
900 2nd Avenue South, Suite 1575
Minneapolis, MN 55402

www.colliers.com/msp

BRIAN BRUGGEMAN
952 837 3079
brian.bruggeman@colliers.com

LOUIS SUAREZ
952 837 3061
louis.suarez@colliers.com

PROPERTY FACT SHEET



Northdale Plaza

PROPERTY ADDRESS:

13980, 14000, 14040 Northdale Blvd
Rogers, MN 55374

CURRENTLY AVAILABLE:

13980: leased
14000: 6,274 square feet
14040: leased

DIVISIBLE TO:

1,000 square feet

YEAR BUILT:

2003

BUILDING SQUARE FEET

35,314 rentable square feet

NET RENTAL RATES:

\$12.00 - \$18.00 per square foot

2017 EST. CAM & REAL ESTATE TAX:

\$3.10 per square foot CAM
\$3.21 per square foot Tax
\$6.31 total per square foot

AMENITIES:

- Perfect for medical use
- Convenient location
- High visibility from Highway 101
- Easy access to I-94
- On-building signage available



For Leasing Information, Contact:

BRIAN BRUGGEMAN CCIM
952 837 3079
brian.bruggeman@colliers.com

LOUIS SUAREZ MBA, CCIM
952 837 3061
louis.suarez@colliers.com

COLLIERS INTERNATIONAL
900 2nd Avenue South, Suite 1575
Minneapolis, MN 55402
www.colliers.com/msp

Northdale Plaza

14000 NORTHDAL BLVD., ROGERS, MN 55374

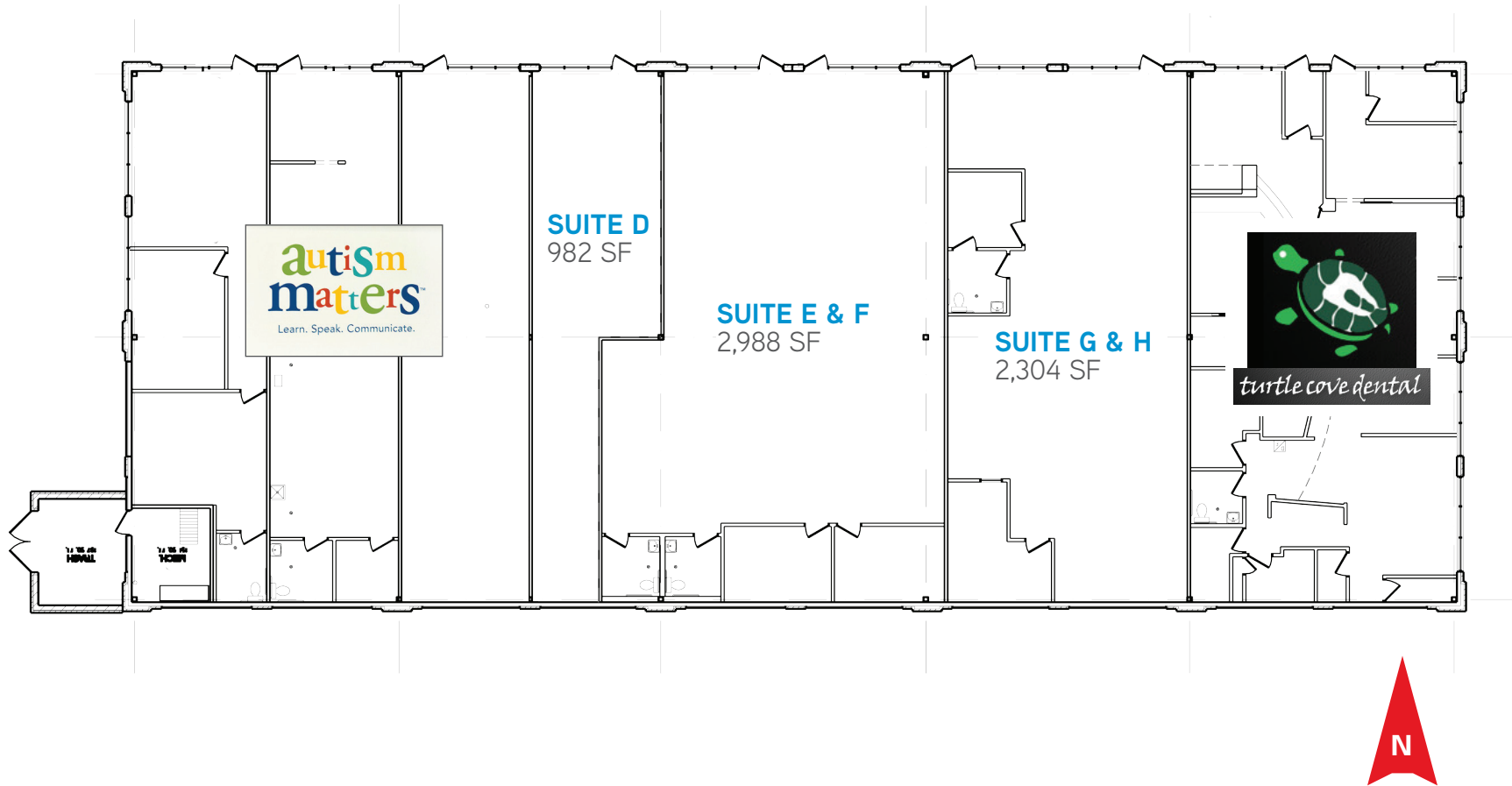

BRIAN BRUGGEMAN CCIM
952 837 3079
brian.briggeman@colliers.com

LOUIS SUAREZ MBA, CCIM
952 837 3061
louis.suarez@colliers.com

Northdale Plaza

13980, 14000, 14040 NORTHDALÉ BOULEVARD, ROGERS, MN 55374



SITE PLAN



Northdale Plaza

13980, 14000, 14040 NORTHDALÉ BOULEVARD, ROGERS, MN 55374



AERIAL
VIEW

