

54,062 Square Feet
1939 Olney Avenue
Cherry Hill Business Park
Cherry Hill Twp, Camden County, New Jersey

DESCRIPTION: One (1) story warehouse/flex facility containing approximately 54,062 square feet.

UNIT SIZE:

Office:	7,000 SF (approximate)
Warehouse:	47,062 SF
Total:	54,062 SF

CONSTRUCTION: Brick and steel.

CEILING HEIGHTS: Warehouse: 17-18' clear to underside of I-beam.

COLUMN SPACING: 20' X 40'

LOADING FACILITIES: Eight (8) 8' X 10' tailgate loading doors

Two (2) drive-in loading doors with concrete ramp

One (1) grade level drive-in loading door

PARKING: 112 spaces

HVAC: Warehouse: Heated by ceiling-hung natural gas-fired heating units.

Office: Four (4) five-ton package rooftop units.

LIGHTING: Warehouse: T-5 lighting throughout warehouse.

Exterior: Building-mounted flood lights.

TOILET FACILITIES: Warehouse: Two (2) facilities containing one (1) toilet and one (1) sink.

Shipping: One facility containing two (2) toilets and two (2) sinks.
One facility containing one (1) toilet and two (2) sinks.

Office: Women's Room: Two (2) toilets and two (2) sinks.
Men's Room: One (1) toilet and two (2) sinks.

Install Dept: Two (2) facilities each containing one (1) toilet and one (1) sink

ELECTRIC SERVICE:	Three (3) 200 amp services, two (2) 400 amp services, and (1) 1200 amp service. 3-phase. Service provided by PSE&G.
FIRE SUPPRESSION:	100% Wet system.
WATER SERVICE:	Public water provided by New Jersey American Water.
SEWER SERVICE:	Public sewer provided by Camden County Municipal Utilities Authority.
GAS SERVICE:	Service is provided by PSE&G.
ZONING:	IR (Industrial Restricted)
LOCATION:	Located in the Cherry Hill Business Park. Direct access from Springdale Road. Minutes from interchange 34 of I-295; Provides excellent access to Route 70. Close proximity to Route 73 and NJ Turnpike.

> Data Sheet

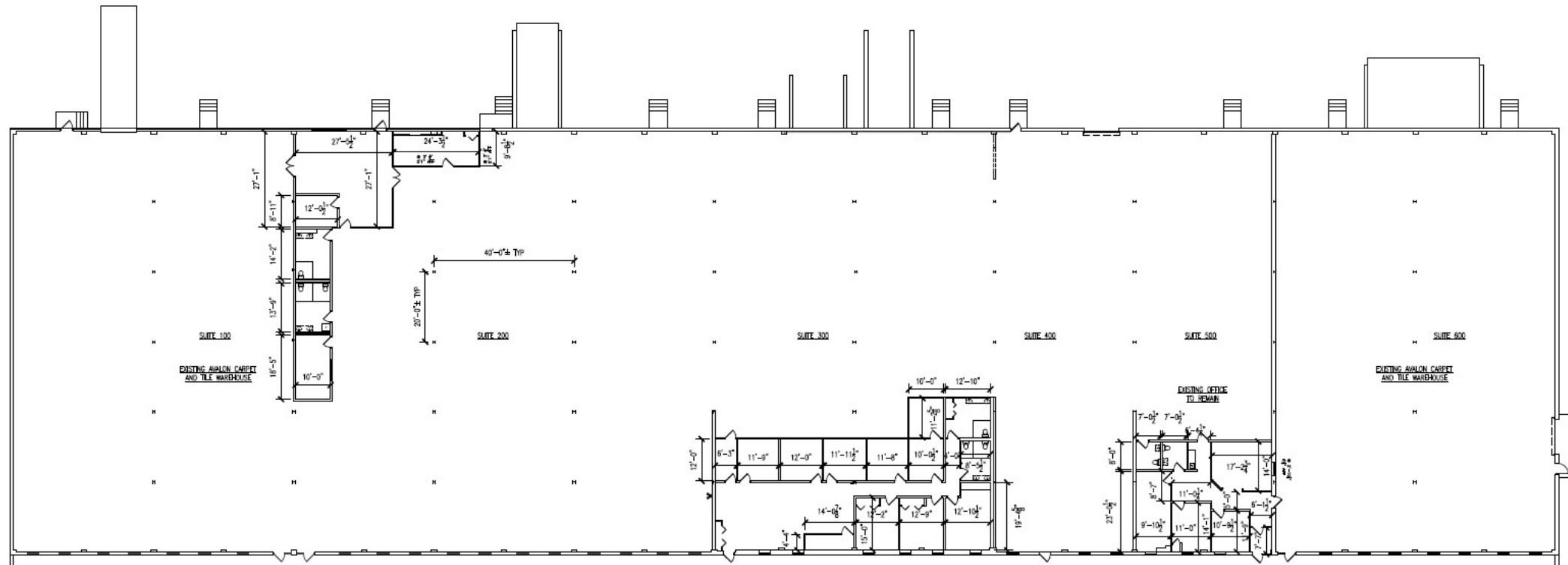

1 EXISTING PLAN SCALE: 1/16" = 1'-0"

The foregoing information was furnished to us by sources which we deem to be reliable, but no warranty or representation is made as to the accuracy thereof. Subject to correction of errors, omissions, change of price, prior sale or withdrawal from market without notice.