

For Sale

15255 Central Ave NE
Ham Lake, MN 55304

DAN FRIEDNER

952 897 7863 direct
612 599 7864 mobile
dan.friedner@colliers.com

JAY CHMIELESKI

952 897 7801 direct
612 275 3772 mobile
jay.c@colliers.com



COLLIERS INTERNATIONAL
5985 Rice Creek Parkway
Suite 105
Shoreview, MN 55126
www.colliers.com/msp

Address:	15255 Central Ave NE, Ham Lake
Building Sizes:	9,493 square feet - main building 2,450 square feet - mini storage building 11,943 square feet - total
Lot Size:	1.90 acres
Zoning:	TOD - Traditional Use Overlay District
Billboard:	Included in sale
2017 Taxes:	\$15,690.34
Sale Price:	\$519,000 \$43.46 per square foot

FOR SALE

Property Address:	15255 Central Ave NE, Ham Lake
Total Building Sizes:	9,493 square feet - main building • 4,903 square feet - north half • 4,590 square feet - south half 2,450 square feet - mini storage building
Drive-ins:	Three (3) - main building Eight (8) - outlot building
Dock:	One (1) platform dock
Billboard:	Included in sale, \$1,815 per year in gross rent
2017 Taxes:	\$15,690.34
Amenities:	Easy access to Hwy 65
Anoka County PID:	20-32-23-42-0004
Sale Price:	\$519,000.00 (\$43.46 per square foot)

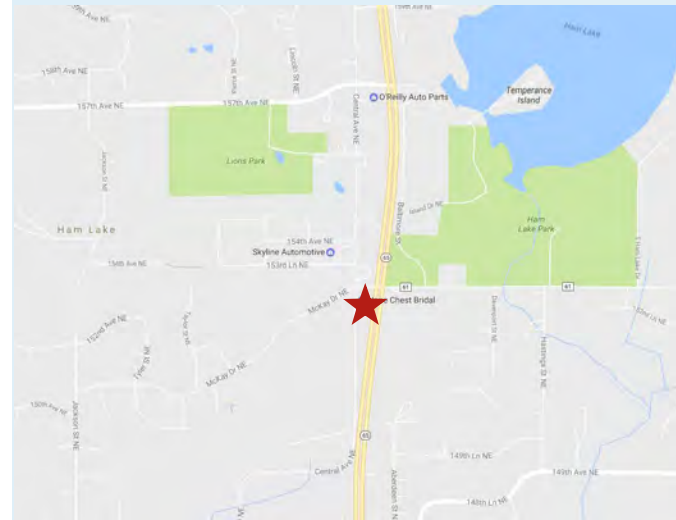

Contact Info

DAN FRIEDNER
 952 897 7863 direct
 612 599 7864 mobile
dan.friedner@colliers.com

JAY CHMIELESKI
 952 897 7801 direct
 612 275 3772 mobile
jay.c@colliers.com

This document/email has been prepared by Colliers International for advertising and general information only. Colliers International makes no guarantees, representations or warranties of any kind, expressed or implied, regarding the information including, but not limited to, warranties of content, accuracy and reliability. Any interested party should undertake their own inquiries as to the accuracy of the information. Colliers International excludes unequivocally all inferred or implied terms, conditions and warranties arising out of this document and excludes all liability for loss and damages arising there from. This publication is the copyrighted property of Colliers International and /or its licensor(s). © 2016. All rights reserved. This communication is not intended to cause or induce breach of an existing listing agreement.



COLLIERS INTERNATIONAL
 5985 Rice Creek Parkway
 Suite 105
 Shoreview, MN 55126
www.colliers.com/msp



DAN FRIEDNER
952 897 7863 direct
612 599 7864 mobile
dan.friedner@colliers.com

JAY CHMIELESKI
952 897 7801 direct
612 275 3772 mobile
jay.c@colliers.com



Anoka County, MN



June 12, 2017

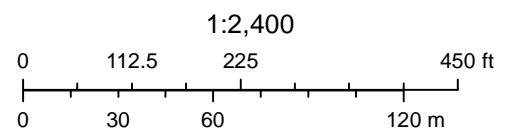



15255 Central Ave NE

Ham Lake, Minnesota



Aerial Photo: Flown Spring of 2014





DAN FRIEDNER
952 897 7863 direct
612 599 7864 mobile
dan.friedner@colliers.com

JAY CHMIELESKI
952 897 7801 direct
612 275 3772 mobile
jay.c@colliers.com

