



OFFICE/WAREHOUSE SPACE > FOR LEASE

# Valley Industrial Center III

5288 VALLEY INDUSTRIAL BLVD S, SHAKOPEE, MINNESOTA 55379

ERIC ROSSBACH CCIM, SIOR  
952 897 7872  
[eric.rossbach@colliers.com](mailto:eric.rossbach@colliers.com)

SETH ALLAN  
952 374 5827  
[seth.allan@colliers.com](mailto:seth.allan@colliers.com)



## OFFICE/WAREHOUSE SPACE > FOR LEASE

# Valley Industrial Center

5288 VALLEY INDUSTRIAL BLVD. S., SHAKOPEE, MN 55379

## SITE PLAN

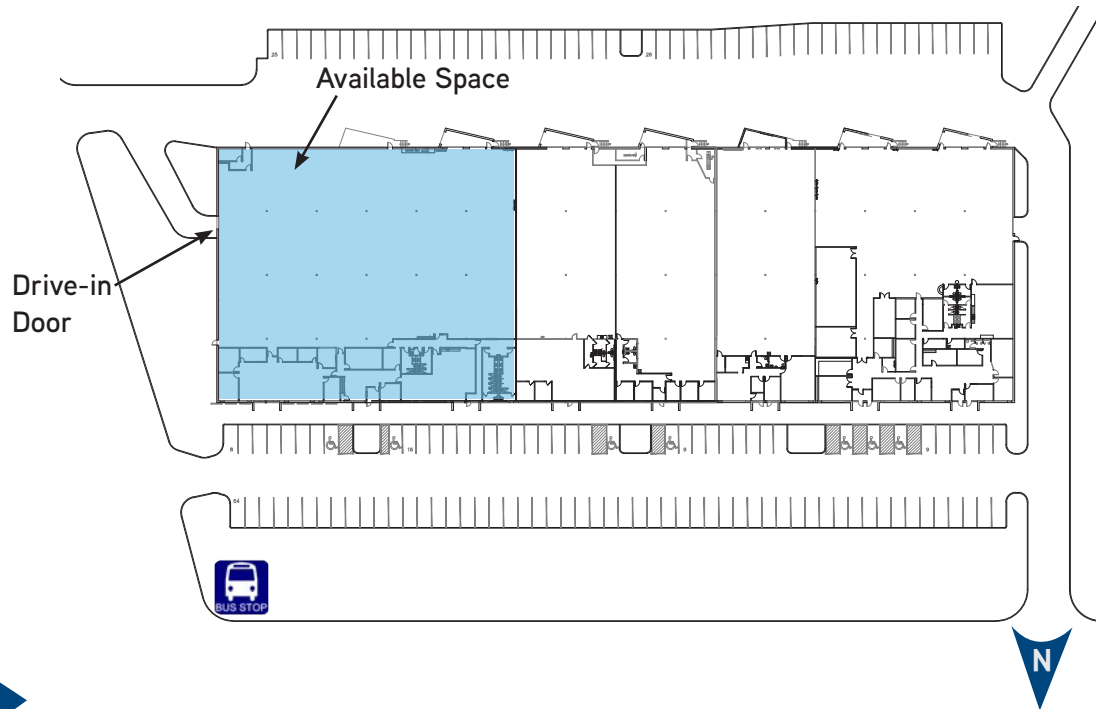

### Highlights

- Easy access to Hwy 169 and MN 101
- 14 minutes to Flying Cloud Airport
- 27 minutes to Minneapolis/St. Paul Int'l Airport
- Close to Valleyfair and Canterbury Park as well as area amenities



## Property Description

Valley Industrial Center III totals 80,000 square feet. This premier site is well-positioned with easy access to Highways 101, 169 and 13, and has a variety of flexible solutions to meet market needs of any industrial use.

## Highlights

- > 19' clear height
- > Dock and drive-in loading
- > Bus stop at property – stop #56277
  - Bus Routes: 499-East | 499-West

## FLOOR PLAN

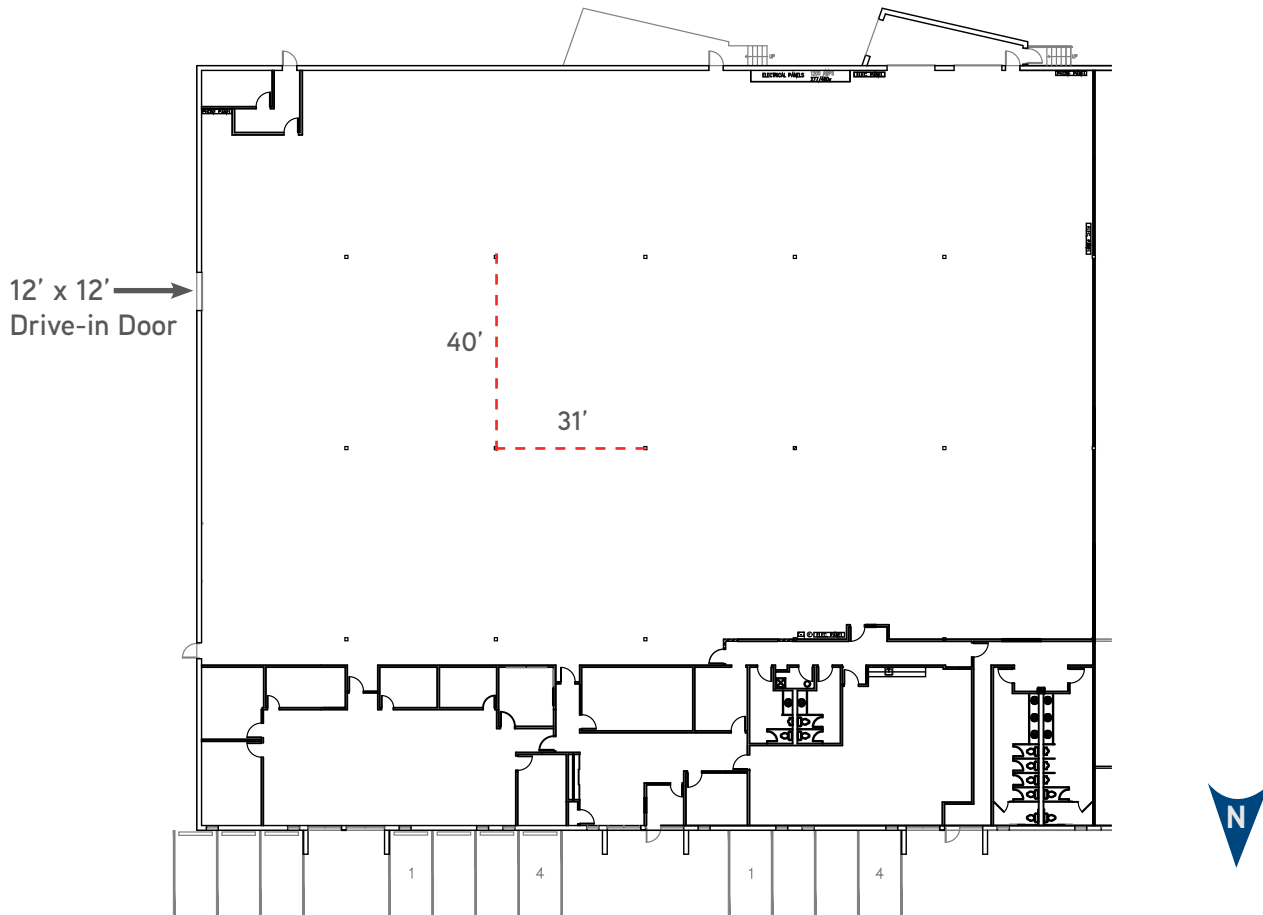

### Building Size

80,000 SF

### Available - Suite 5288

6,833 SF office

23,167 SF warehouse

**30,000 SF Total**

Divisible to 10,000 SF

### Net Rental Rates

\$9.50 psf Office

\$4.50 psf Warehouse

### 2018 Est. CAM & Real Estate

#### Taxes

\$1.30 psf CAM

\$1.89 psf Real Estate Taxes

**\$3.19 psf Total**

### Available Loading

2 dock doors

1 - 12' x 12' drive-in door

### Clear Height

19'

### Year Built

1973

### Dimensions

40' x 31' column spacing

160' bay depth

### Zoning

I2; Heavy Industrial

### Building Parking

149 surface stalls

### Sprinkler

Yes

### Telecommunications Provider

Century Link



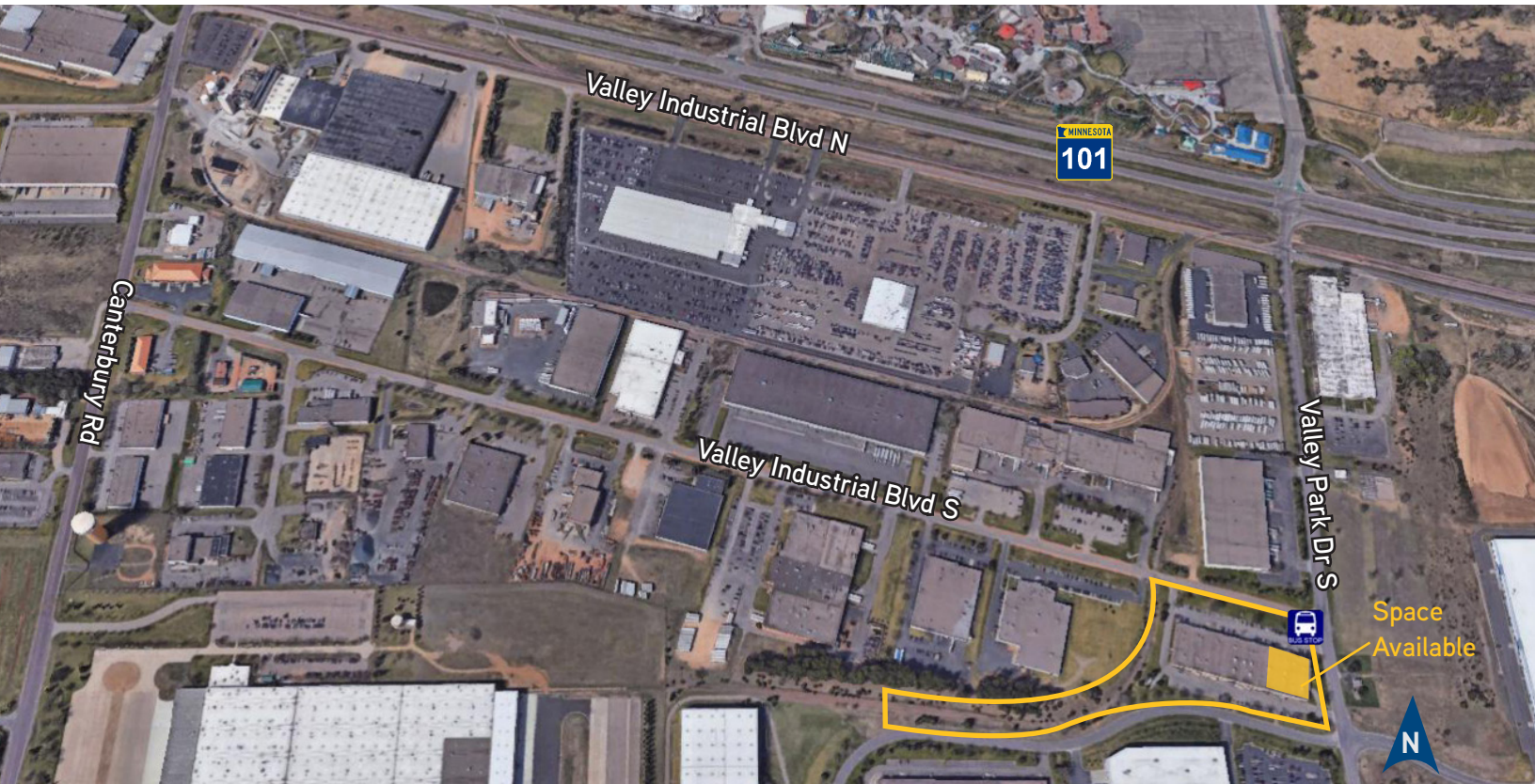

## Contact Us

ERIC ROSSBACH CCIM, SIOR  
952 897 7872  
[eric.rossbach@colliers.com](mailto:eric.rossbach@colliers.com)

SETH ALLAN  
952 374 5827  
[seth.allan@colliers.com](mailto:seth.allan@colliers.com)

