

Ready for  
Occupancy!



**BUILDING 10**  
LEASED

Phase II  
Available for BTS  
Up to 1.3 M SF

**BUILDING 5**  
295,278 SF Available

**BUILDING 4**  
243,778 SF Available

**BUILDING 3**  
LEASED

**BUILDING 1**  
66,719 SF Available

**BUILDING 2**  
92,426 SF Available

[View Video Here](#)

[View Website Here](#)

Five Buildings Totaling 1.3M SF  
66,719 SF – 295,278 SF Available  
Divisible

# The Logistics Campus

## Warehouse/Distribution/Light Manufacturing

Phase I



[Dermody.com](http://Dermody.com)

# Building Specifications

Glenview, Illinois



CHICAGO CBD

25 Miles



O'HARE AIRPORT

11 Miles



CHICAGO EXECUTIVE AIRPORT

2 Miles

2 Miles

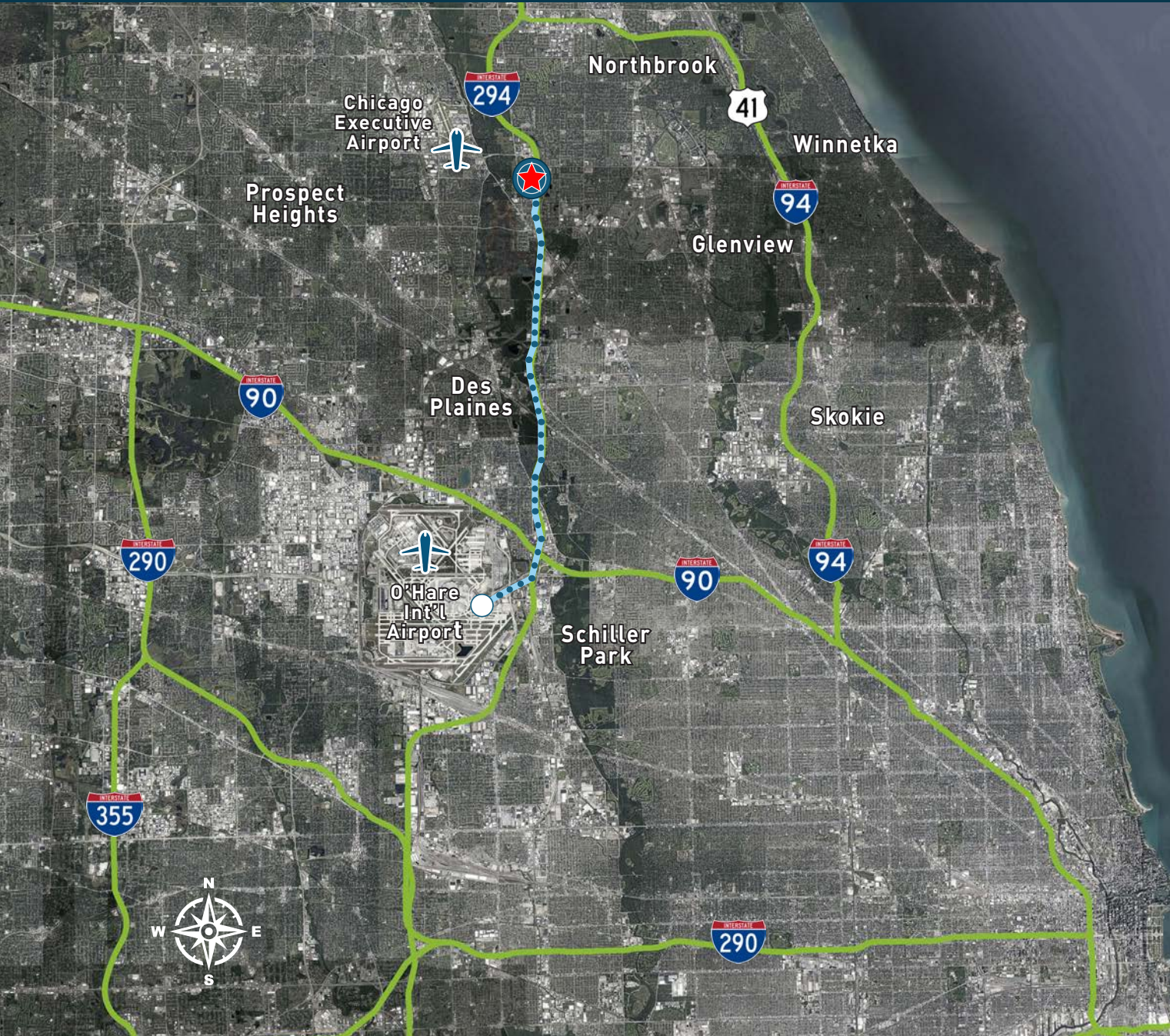

The Logistics Campus is in an unparalleled Chicago location, and features state-of-the-art specifications, a wide array of nearby amenities and immediate access to I-294.

- Planned as 10-building logistics campus totaling 3,238,548 square feet with flexibility to accommodate build-to-suits
- Class-A construction and design
- All five Phase I buildings are LEED Silver Certified
- Flight-to-quality location with proximity to O'Hare
- Immediate access to I-294 at Willow Rd to a four-way interchange
- Four buildings ready for occupancy
- 32'-120' ft clear
- Trailer parking





The Logistics Campus Warehouse/Distribution



Area Amenities

**Holiday Inn EXPRESS**

**J. ALEXANDER'S**  
**HYATT REGENCY**

**EMBASSY SUITES**  
by Hilton

**DUNKIN' DONUTS** **Portillo's** **McALISTER'S**  
**COURTYARD** **THE HOME DEPOT** **JJ**  
Marriott

**Marshalls** **SUBWAY**  
**BED BATH & BEYOND** **Red Roof Inn** **noodles**  
**HOBBY LOBBY** **Chick-fil-est**

**CATERPILLAR**  
**McDonald's** **Residence Inn**

**DICK'S** **rack**  
**TJ-maxx** **TRADER JOE'S**

**Culver's** **bp**

**Mobil**  
**BROWN'S CHICKEN**

**DUNKIN' DONUTS**  
**CHASE**

**ARMANI** **FINISH LINE** **california PIZZA KITCHEN**  
**PF. CHANG'S** **claire's**

**MATTRESS FIRM**  
**PNC**

**Domino's** **Mobil**

**STARBUCKS** **RUTH'S CHRIS STEAK HOUSE** **BANK OF AMERICA**  
**CHASE** **RENAISSANCE HOTELS**

**RAMADA**

**LAIFITNESS** **bp** **STARBUCKS** **MARIANO'S Fresh Market**  
**SUBWAY** **CVS pharmacy**

**ups** **COSTCO WHOLESALE**

**PINSTRIPES** **BEST BUY** **WHOLE FOODS**  
**LOWE'S**

**CROWNE PLAZA** **Hilton**

**Sheraton** **MART**

**JJ** **McDonald's** **CHASE** **Walgreens** **Bank of America** **Jewel**  
**STARBUCKS**

**McALISTER'S** **KOHL'S** **noodles**  
**ALDI** **TARGET** **STARBUCKS** **McDonald's** **bp**  
**SUBWAY** **DUNKIN' DONUTS**

**baskin BR robbins** **COURTYARD** **Marriott** **DUNKIN' DONUTS** **Wendy's**

**Abt** **RENAISSANCE HOTELS**

**Jewel** **USPS** **WILDFIRE**  
STEAKS, CHOPS & SEAFOOD  
Glenview Police & Municipal Center



# Site Plan

[View Additional Site Plan Options Here](#)

- Four Buildings Ready for Occupancy
- Divisible
- LEED Silver Certified
- +/- 3,100 SF spec office in each building



## Phase I

Building	Available SF
Building 1	66,719 SF
Building 2	92,426 SF
Building 3	LEASED
Building 4	243,778 SF
Building 5	295,278 SF



# Property Overview

Four Buildings Ready for Occupancy

66,719 SF – 295,278 SF Available

Divisible



**BUILDING 1**  
66,719 SF Available

**BUILDING 2**  
92,426 SF Available

**BUILDING 3**  
LEASED

**SANDERS RD**

**Phase II**

\* Flexibility to construct  
other layouts up to 1.3 M SF

**BUILDING 5**  
295,278 SF Available

**BUILDING 4**  
243,778 SF Available

**PROTECTION PKWY**

**WILLOW RD**

**INTERSTATE  
294**

# Property Overview

Building 1 - 66,719 SF  
2600 Sanders Road

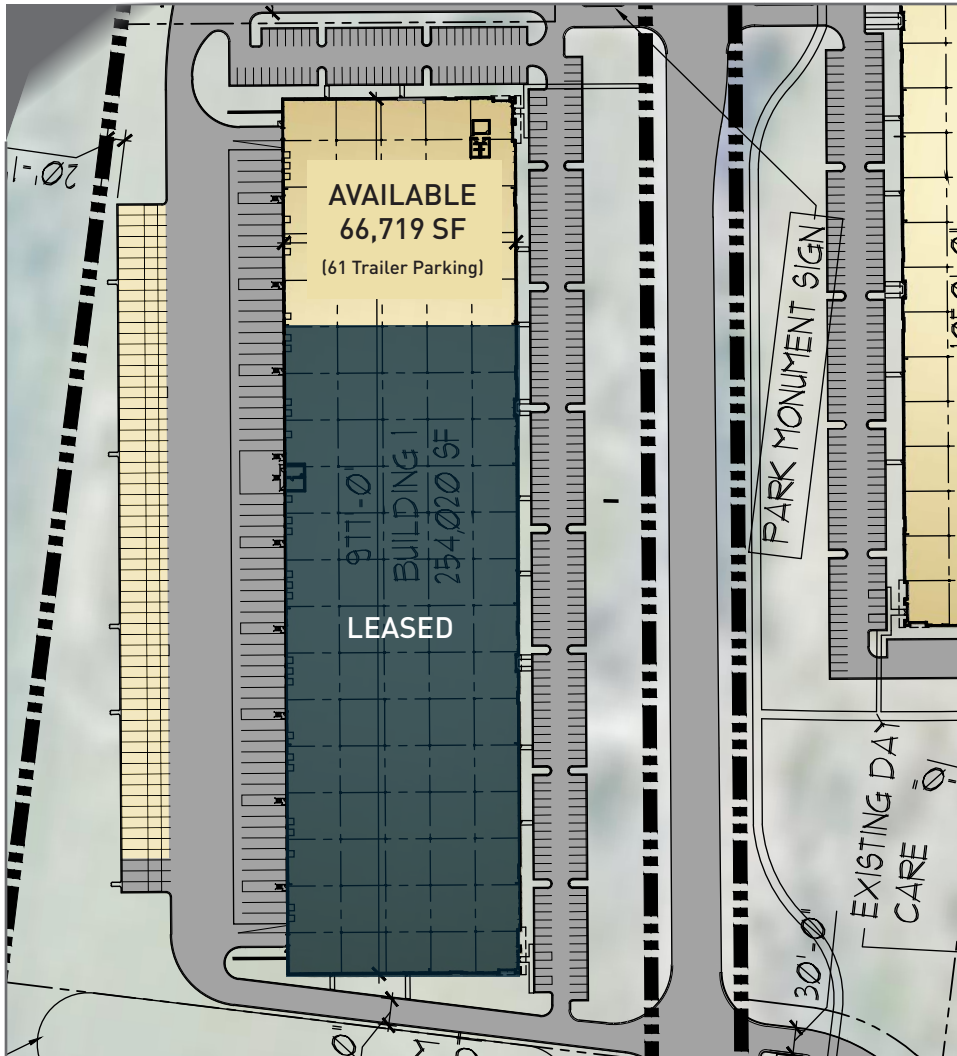

<b>Building Dimensions:</b> 260' x 254' 6"	<b>Clear Height:</b> 36'
<b>Drive-In Doors:</b> 2	<b>Column Spacing:</b> 50' X 52'
<b>Dock Doors:</b> 7 existing (expandable to 14)	<b>Office Area:</b> +/- 3,100 SF
<b>Trailer Parking:</b> 61	<b>Floors:</b> 7" / 4,000 PSI
<b>Car Parking:</b> 87	<b>Lighting:</b> High Bay LED
<b>Zoning:</b> Industrial	<b>HVAC Systems:</b> Rooftop Units
<b>Year Built:</b> 2024	<b>Electric:</b> 2,000 Amps
<b>Structure Exterior:</b> Precast	<b>Roof:</b> 45 mil Mechanically Fastened TPO

# Property Overview

Building 2 - 92,426 SF  
2500 Sanders Road

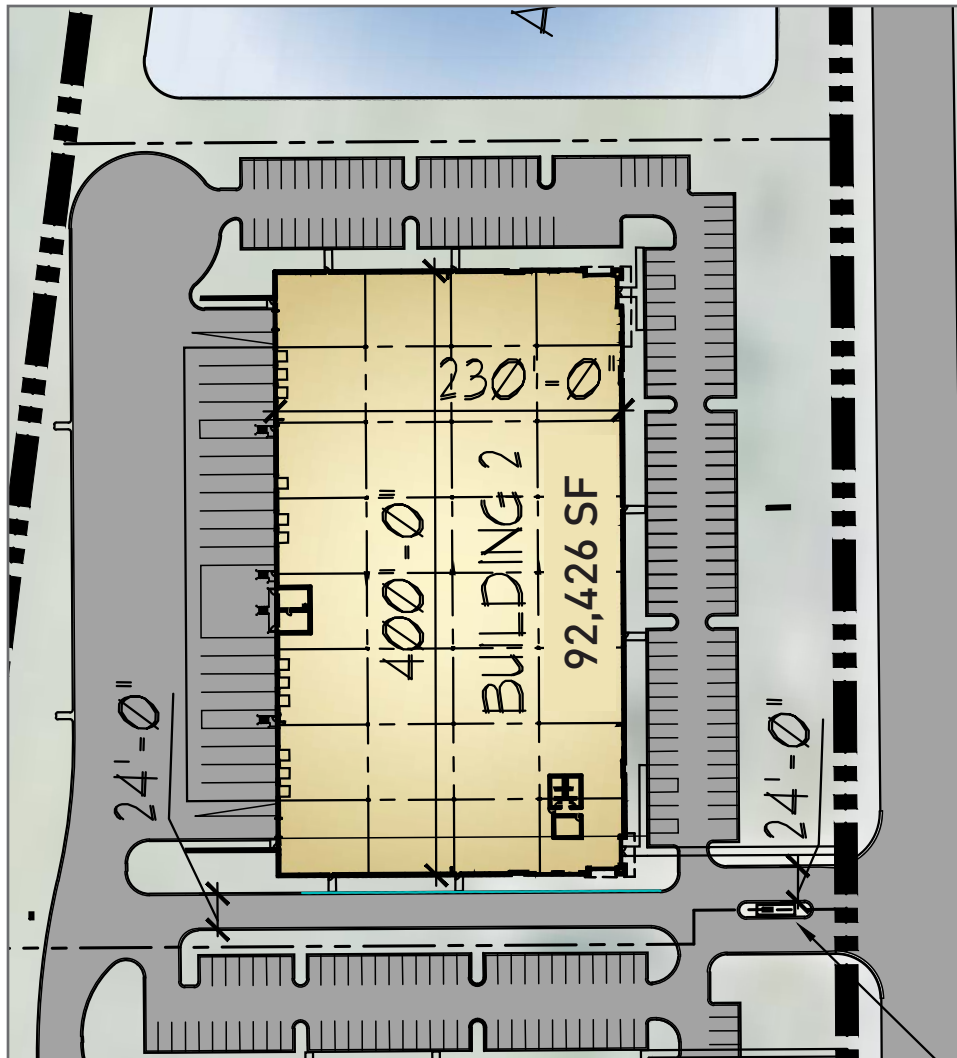

<b>Building Dimensions:</b> 230' x 400'	<b>Clear Height:</b> 32'
<b>Drive-In Doors:</b> 2	<b>Column Spacing:</b> 50' x 56'8"
<b>Dock Doors:</b> 12 existing (expandable to 19)	<b>Office Area:</b> +/- 3,100 SF
<b>Trailer Parking:</b> 0	<b>Floors:</b> 7"/4,000 PSI
<b>Car Parking:</b> 142	<b>Lighting:</b> High Bay LED
<b>Zoning:</b> Industrial	<b>HVAC Systems:</b> Rooftop Units
<b>Year Built:</b> 2024	<b>Electric:</b> 1200 Amps
<b>Structure Exterior:</b> Precast	<b>Roof:</b> 45 mil Mechanically Fastened TPO

# Property Overview

Building 4 - 243,778 SF  
2551 Protection Parkway

Divisible

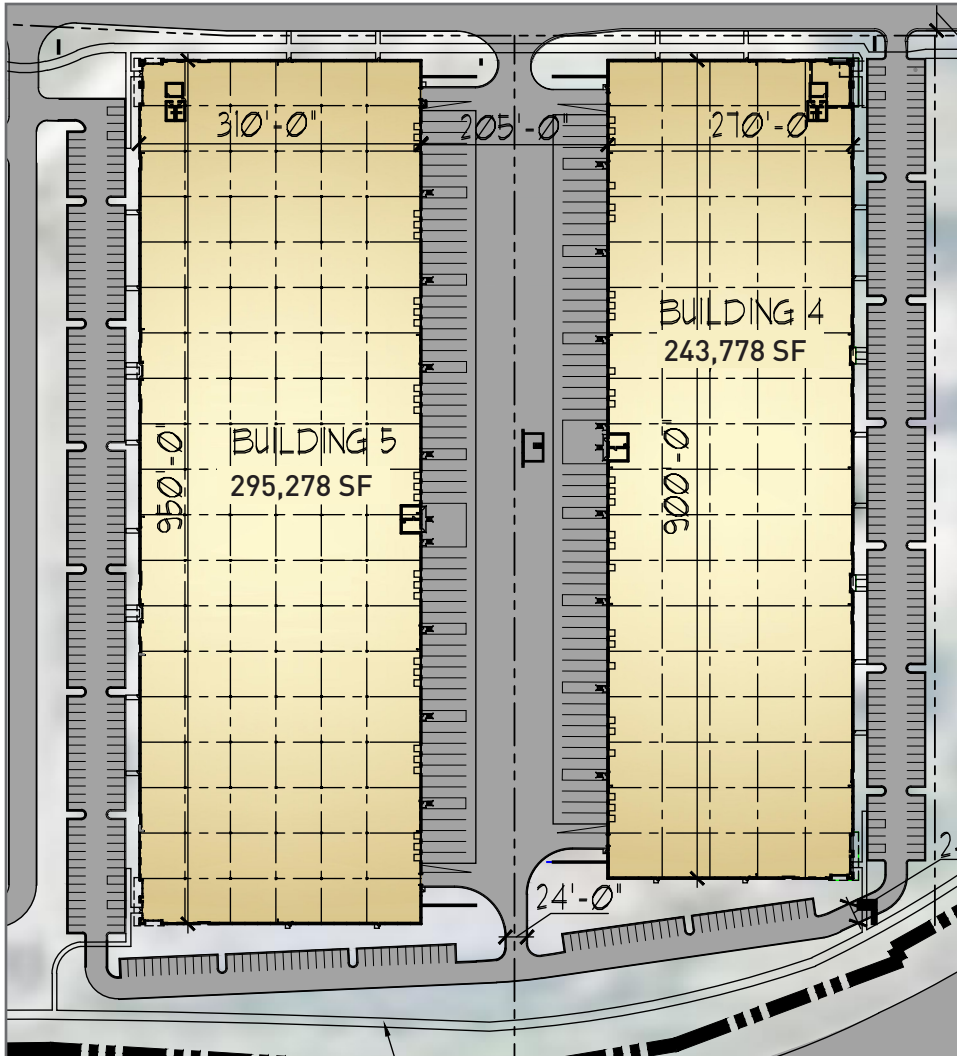

<b>Building Dimensions:</b> 270' x 900'	<b>Clear Height:</b> 36'
<b>Drive-In Doors:</b> 2	<b>Column Spacing:</b> 50' x 52'6"
<b>Dock Doors:</b> 27 existing (expandable to 55)	<b>Office Area:</b> +/- 3,100 SF
<b>Trailer Parking:</b> 0	<b>Floors:</b> 7"/4,000 PSI
<b>Car Parking:</b> 214	<b>Lighting:</b> High Bay LED
<b>Zoning:</b> Industrial	<b>HVAC Systems:</b> Rooftop Units
<b>Year Built:</b> 2024	<b>Electric:</b> 2,500 Amps
<b>Structure Exterior:</b> Precast	<b>Roof:</b> 45 mil Mechanically Fastened TPO

# Property Overview

Building 5 - 295,278 SF  
2601 Protection Parkway

Divisible

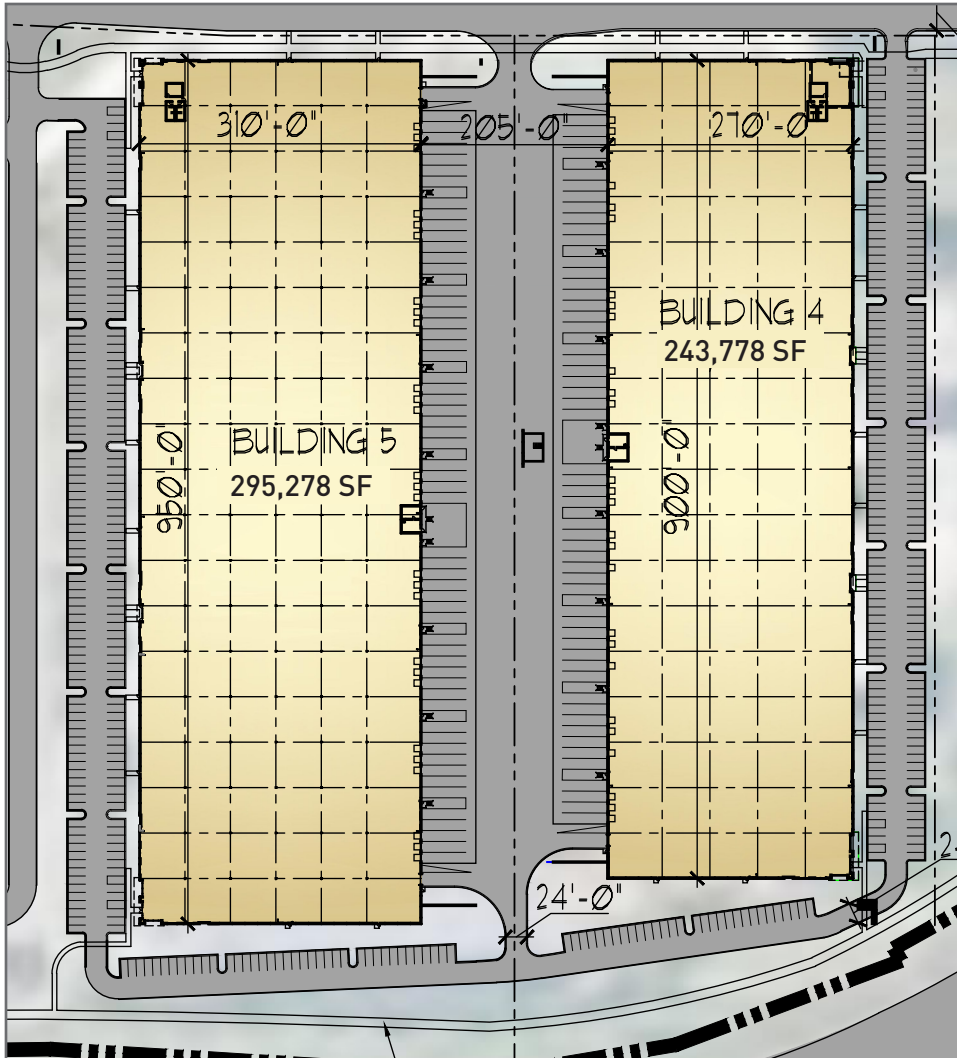

<b>Building Dimensions:</b> 310' x 950'	<b>Clear Height:</b> 36'
<b>Drive-In Doors:</b> 2	<b>Column Spacing:</b> 50'x50'
<b>Dock Doors:</b> 27 existing (expandable to 58)	<b>Office Area:</b> +/- 3,100 SF
<b>Trailer Parking:</b> 0	<b>Floors:</b> 7"/4,000 PSI
<b>Car Parking:</b> 229	<b>Lighting:</b> High Bay LED
<b>Zoning:</b> Industrial	<b>HVAC Systems:</b> Rooftop Units
<b>Year Built:</b> 2024	<b>Electric:</b> 2,000 Amps
<b>Structure Exterior:</b> Precast	<b>Roof:</b> 45 mil Mechanically Fastened TPO

# Demographics

## 10-Mile Statistics

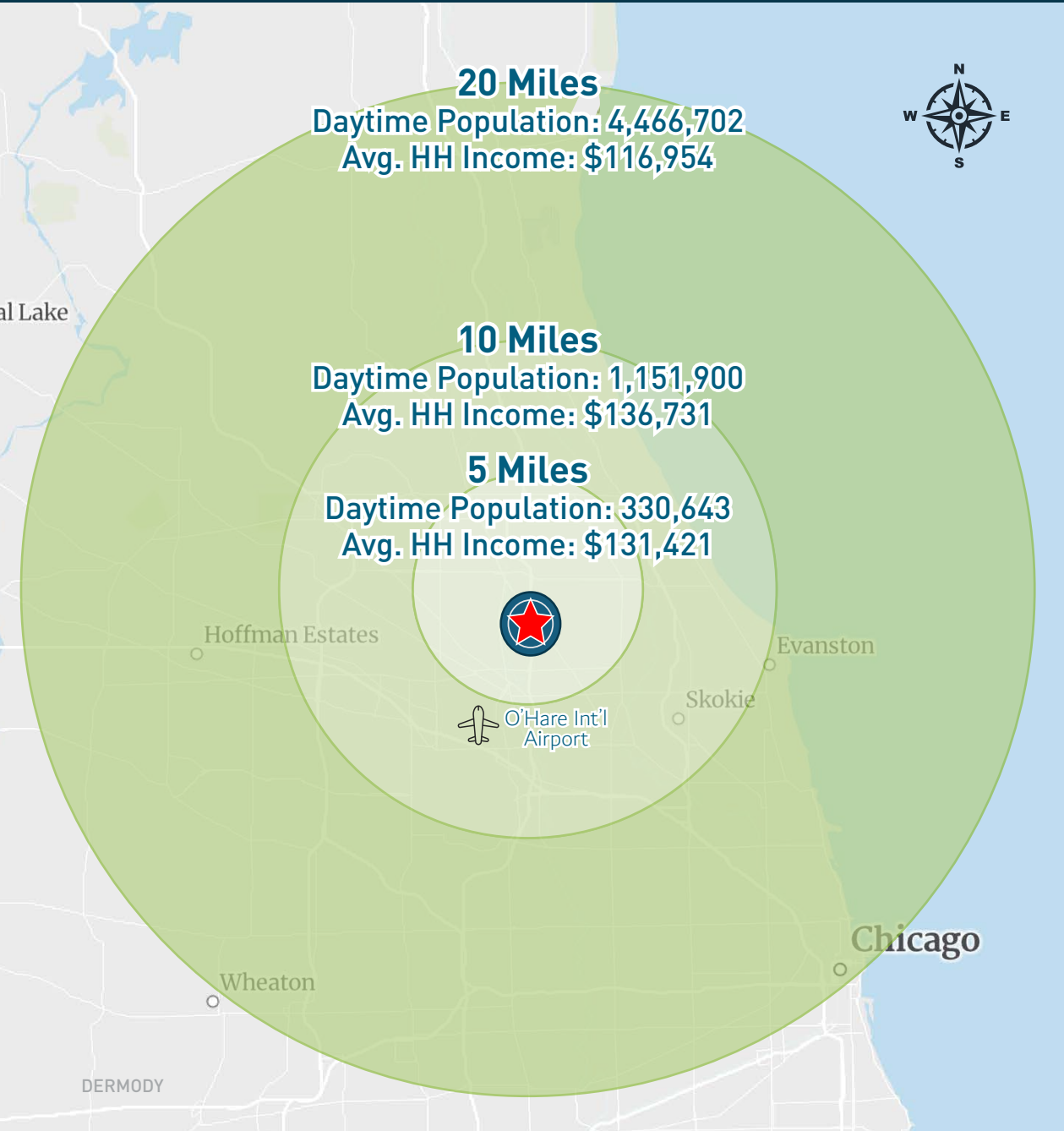

**774,757**  
Employees



**43,963**  
Businesses



**66% of Population**  
Between Ages 15-66

	5 Miles	10 Miles	20 Miles
Total Households	109,238	371,138	1,586,653
Average Household Income	\$131,421	\$136,731	\$116,954
Median Age	44.7	43.8	37.5

# Regional Drive Times



Chicago	0.5
Cincinnati	5.75
Cleveland	7.0
Des Moines	5.5
Detroit	5.5
Indianapolis	4.25
Kansas City	8.5
Louisville	5.75
Memphis	8.5
Milwaukee	0.5
Minneapolis	5.5
Nashville	8.25
Omaha	7.0
Pittsburgh	8.5
St. Louis	5.25



# The Logistics Campus Warehouse/Distribution

Glenview, Illinois

## About Dermody

Dermody is a privately-owned real estate investment, development and management firm that specializes in the acquisition and development of logistics real estate in strategic locations for e-commerce fulfillment centers, third-party logistics and distribution customers. Founded in 1960, Dermody has invested more than \$10 billion of total capital across all platforms nationwide, having acquired and developed approximately 110 million square feet of logistics and industrial facilities. In addition to its corporate office in Reno, Nev., it has regional offices in northern and southern California, Atlanta, Phoenix, Seattle, Chicago, Dallas and New Jersey. For more information, visit [www.Dermody.com](http://www.Dermody.com).

## About Colliers

Colliers (NASDAQ, TSX: CIGI) is a leading diversified professional services and investment management company. With operations in 66 countries, our 19,000 enterprising professionals work collaboratively to provide expert real estate and investment advice to clients. For more than 28 years, our experienced leadership with significant inside ownership has delivered compound annual investment returns of approximately 20% for shareholders. With annual revenues of \$4.3 billion and \$98 billion of assets under management, Colliers maximizes the potential of property and real assets to accelerate the success of our clients, our investors and our people. Learn more at [corporate.colliers.com](http://corporate.colliers.com), Twitter @Colliers or LinkedIn.

This document/email has been prepared by Colliers for advertising and general information only. Colliers makes no guarantees, representations or warranties of any kind, expressed or implied, regarding the information including, but not limited to, warranties of content, accuracy and reliability. Any interested party should undertake their own inquiries as to the accuracy of the information. Colliers excludes unequivocally all inferred or implied terms, conditions and warranties arising out of this document and excludes all liability for loss and damages arising there from. This publication is the copyrighted property of Colliers and /or its licensor[s]. © 2024. All rights reserved. This communication is not intended to cause or induce breach of an existing listing agreement. Colliers International, Inc.

### Neal Driscoll

Dermody  
Partner, Midwest Region  
(224) 567-8503  
[ndriscoll@dermody.com](mailto:ndriscoll@dermody.com)

### Suzanne Serino, SIOR

Colliers  
Vice Chair  
(847) 698-8226  
[suzanne.serino@colliers.com](mailto:suzanne.serino@colliers.com)

### Jonathan Kohn

Colliers  
Principal  
(847) 698-8279  
[jonathan.kohn@colliers.com](mailto:jonathan.kohn@colliers.com)

### Christopher Volkert, SIOR

Colliers  
Principal  
(847) 698-8237  
[chris.volkert@colliers.com](mailto:chris.volkert@colliers.com)

### William Fausone

Colliers  
Senior Advisor  
(847) 698-8202  
[william.fausone@colliers.com](mailto:william.fausone@colliers.com)



[Colliers.com](http://Colliers.com)



[Dermody.com](http://Dermody.com)