

The Logistics Campus

Warehouse/Distribution/Manufacturing
Glenview, IL



Colliers.com



Dermody.com



Building 2 - 92,426 SF

2500 Sanders Road

- Office Area: +/- 3,100 SF (Expandable)
- Clear Height: 32'
- Dock Doors: 12 expandable to 19
- Drive-In Doors: 2
- Column Spacing: 50' X 56'8"
- Floors: 7"/4,000 PSI
- Car Parking: 142
- Lighting: High Bay LED
- Taxes: 6B in place
- Year Built: 2024
- Electric: 1,200 Amps

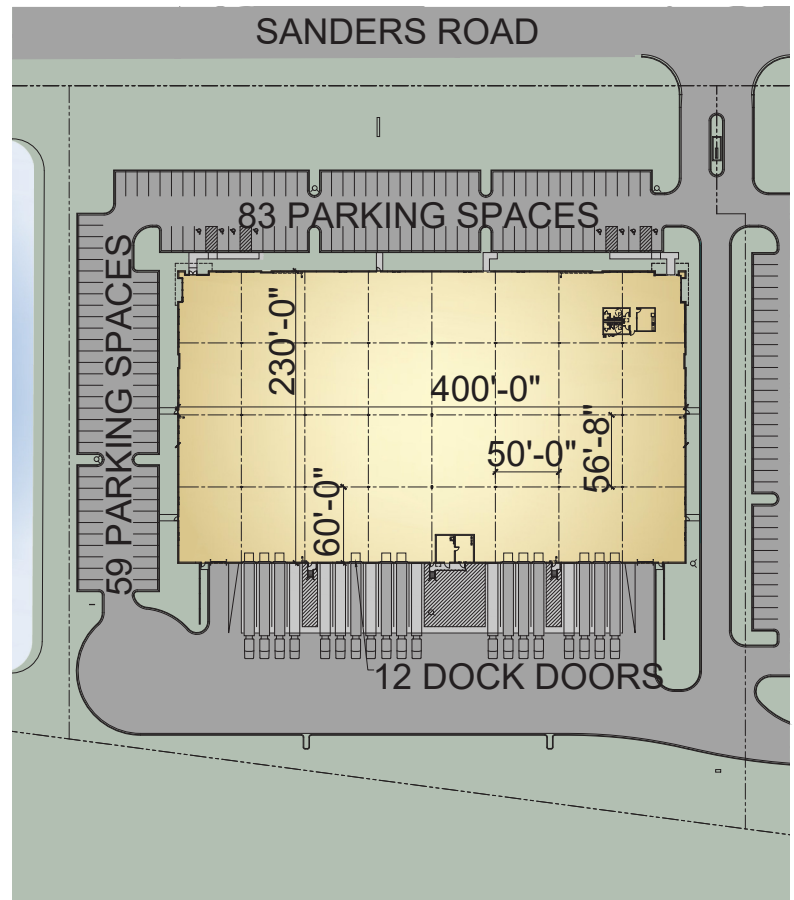

Suzanne Serino, SIOR

Colliers
Vice Chair
(847) 698-8226
suzanne.serino@colliers.com

Jonathan Kohn

Colliers
Principal
(847) 698-8279
jonathan.kohn@colliers.com

Christopher Volkert, SIOR

Colliers
Principal
(847) 698-8237
chris.volkert@colliers.com

Neal Driscoll

Dermody
Partner, Midwest Region
(224) 567-8503
ndriscoll@dermody.com

The Logistics Campus

Warehouse/Distribution/Manufacturing

Glenview, IL



Colliers.com



Dermody.com

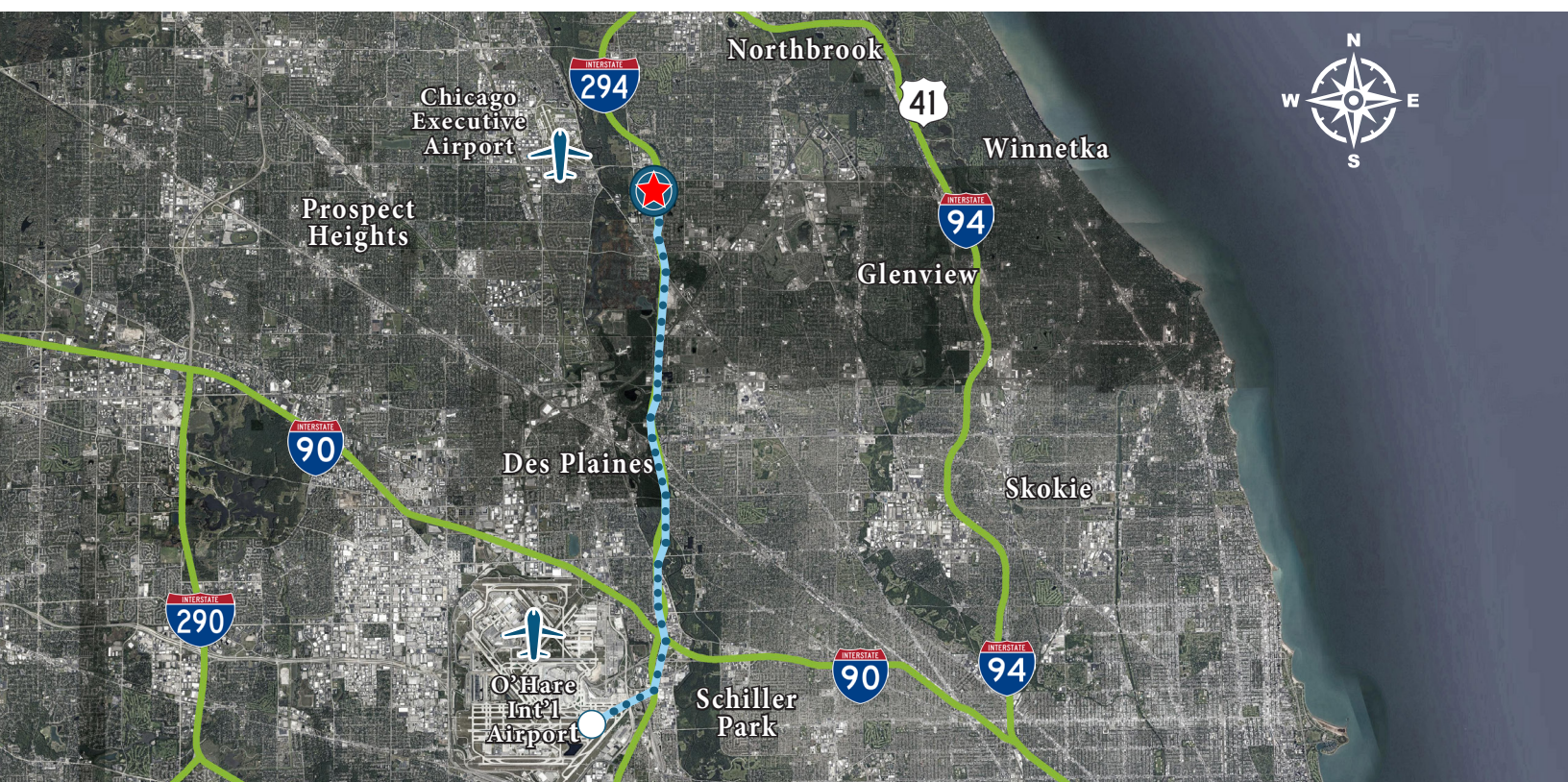

Suzanne Serino, SIOR

Colliers
Vice Chair
(847) 698-8226
suzanne.serino@colliers.com

Jonathan Kohn

Colliers
Principal
(847) 698-8279
jonathan.kohn@colliers.com

Christopher Volkert, SIOR

Colliers
Principal
(847) 698-8237
chris.volkert@colliers.com

Neal Driscoll

Dermody
Partner, Midwest Region
(224) 567-8503
ndriscoll@dermody.com

thelogisticscampusdp.com