

**FOR
LEASE**

IDAHO WATER CENTER

322 E FRONT ST | BOISE, ID



SPACE AVAILABLE

Space	Size	Rate
Floor 2	19,070 RSF	\$22.00 PSF FS
Floor 4	8,708 - 27,678 RSF	\$22.00 PSF FS
Floor 5	5,732 RSF	\$22.00 PSF FS

Spaces can be demised

HIGHLIGHTS

- » Class 'A' office building in the Downtown periphery
- » Showers and lockers available in the building
- » Parking on-site and adjacent to building
- » Ideal for various professional uses
- » Next to Whole Foods, Walgreens, and many restaurants
- » *Available October 1, 2018 - Do Not Disturb Tenants*

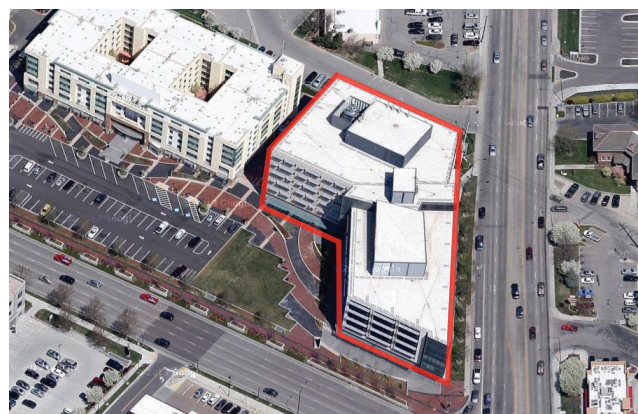
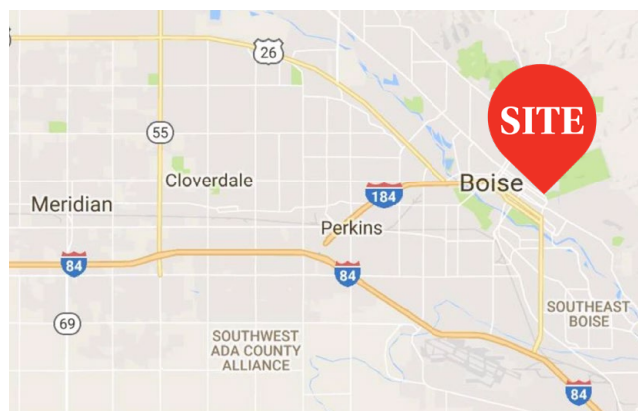

SCOTT FEIGNER
208 493 5107
scott.feighner@colliers.com

**FOR
LEASE**

IDAHO WATER CENTER

322 E FRONT ST | BOISE, ID

Colliers
INTERNATIONAL

Floor 2

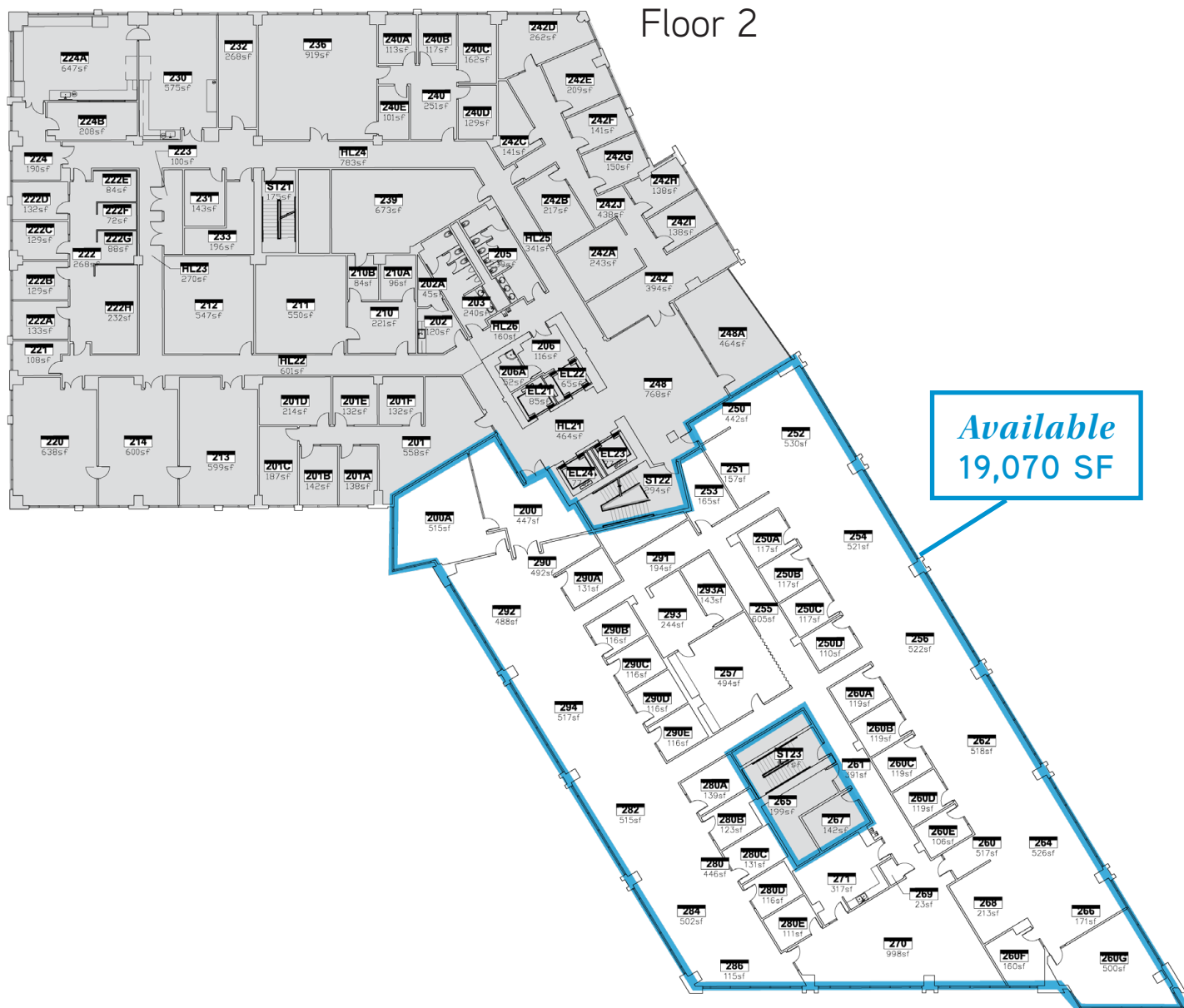

SCOTT FEIGNER
208 493 5107
scott.feigner@colliers.com

**FOR
LEASE**

IDAHO WATER CENTER

322 E FRONT ST | BOISE, ID

Colliers
INTERNATIONAL

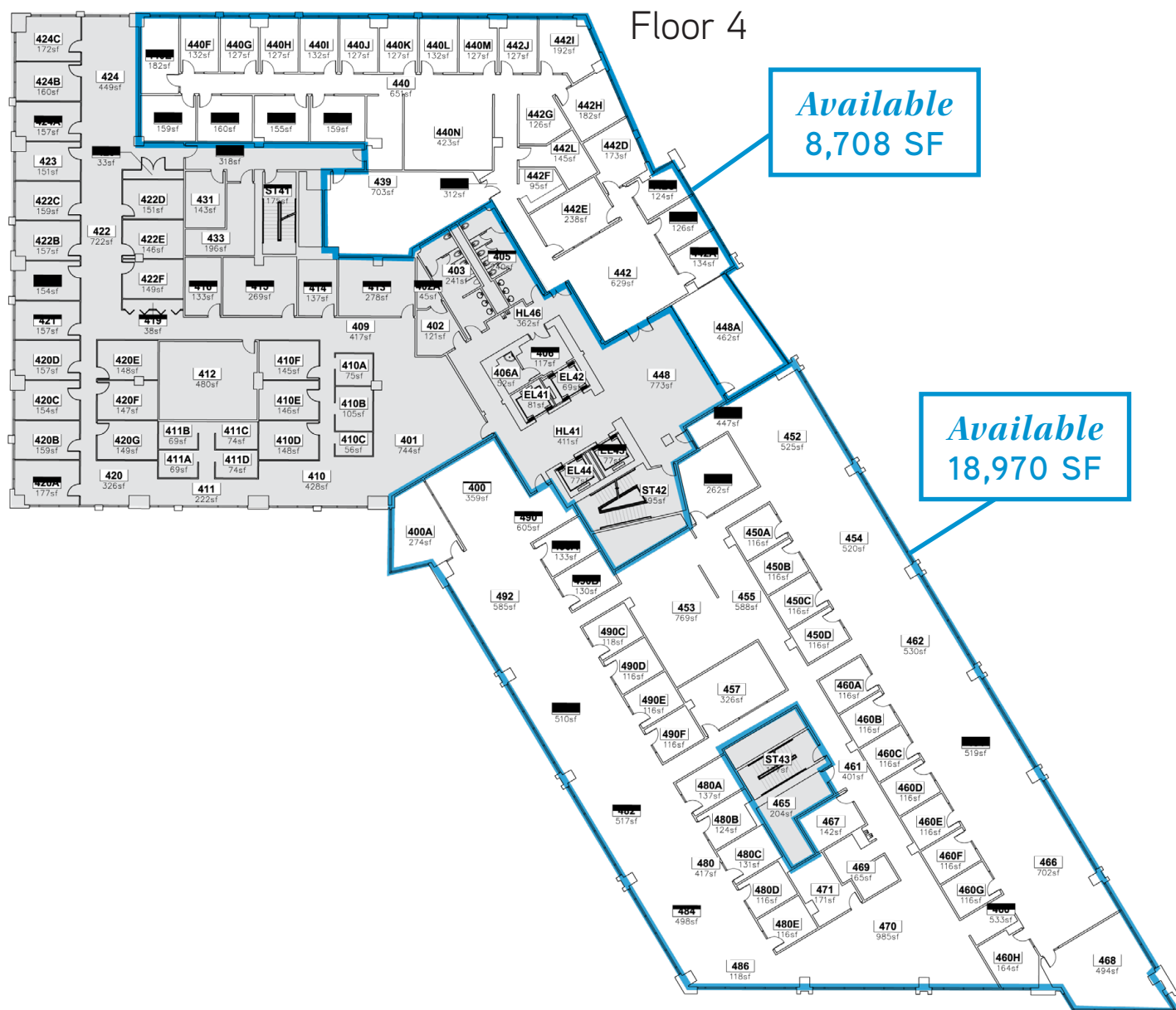

Floor 4 Combined SF = 27,678 SF

SCOTT FEIGNER
208 493 5107
scott.feighner@colliers.com

**FOR
LEASE**

IDAHO WATER CENTER

322 E FRONT ST | BOISE, ID

Colliers
INTERNATIONAL

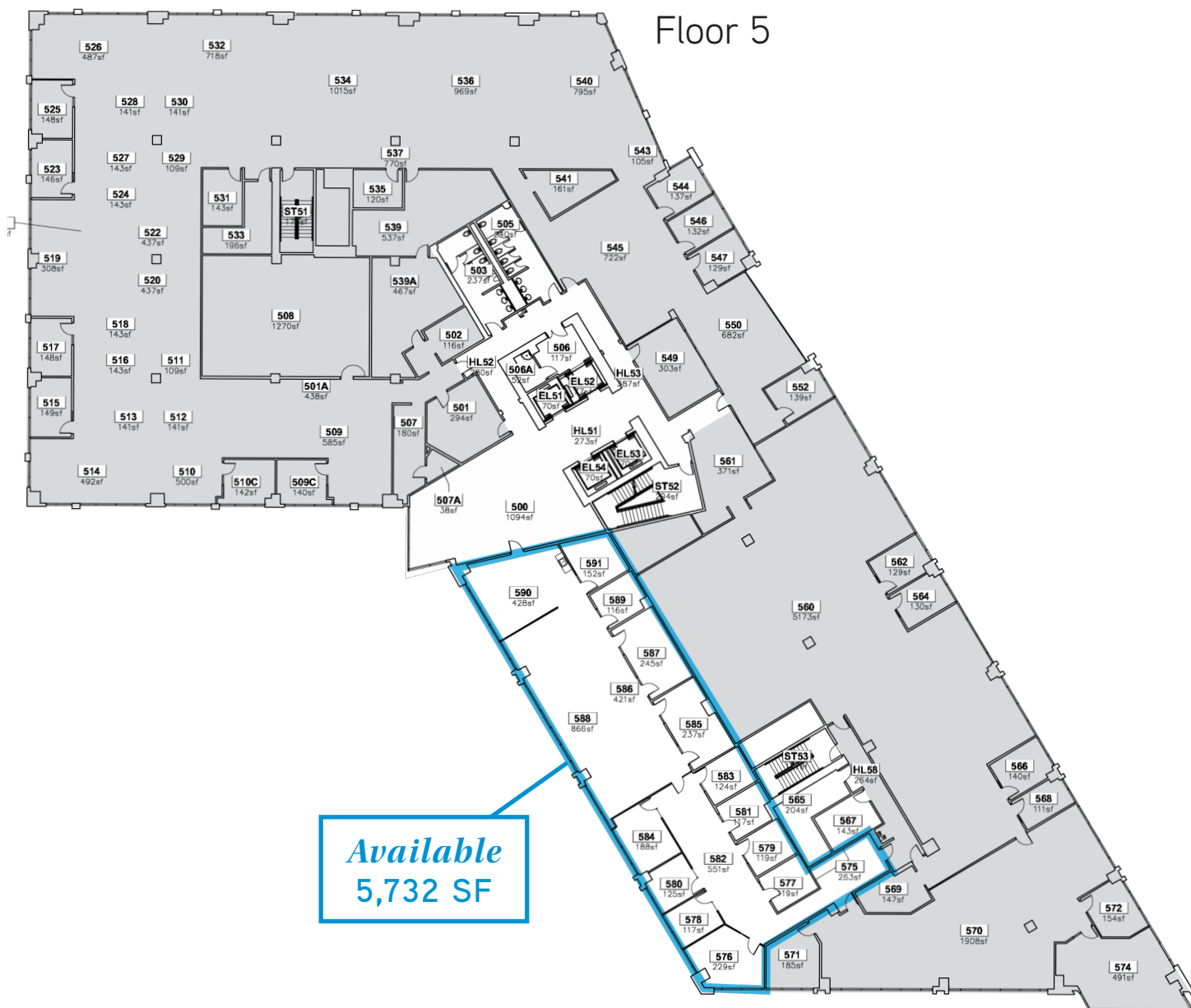

SCOTT FEIGNER

208 493 5107

scott.feigner@colliers.com

**FOR
LEASE**

IDAHO WATER CENTER

322 E FRONT ST | BOISE, ID

Colliers
INTERNATIONAL



SCOTT FEIGNER
208 493 5107
scott.feigner@colliers.com