

FOR LEASE > RETAIL



2,500 SF Campus Retail Space

615 CHERRY ST, TERRE HAUTE, IN



Property Highlights

- > 2,500 SF available for lease
- > Ground floor retail space on the corner of 6th & Cherry St
- > Located in newly renovated The Deming apartment building
- > Building sits across the street from Indiana State University campus
- > Gorgeous high ceilings and windows
- > Basement space could also be available for storage
- > Ideal for a café or convenience market

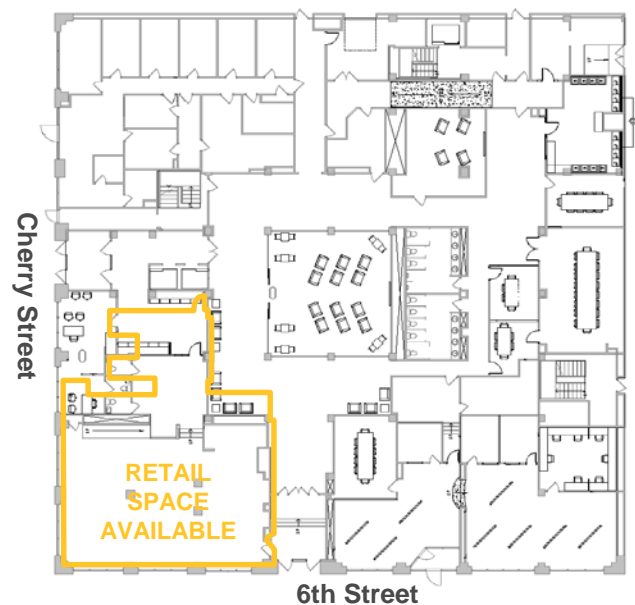

ALISON MELTON
317 713 2156
alison.melton@colliers.com

COLLIERS INTERNATIONAL
241 N Pennsylvania St, Suite 300
Indianapolis, IN 46204
colliers.com

Aerial Map

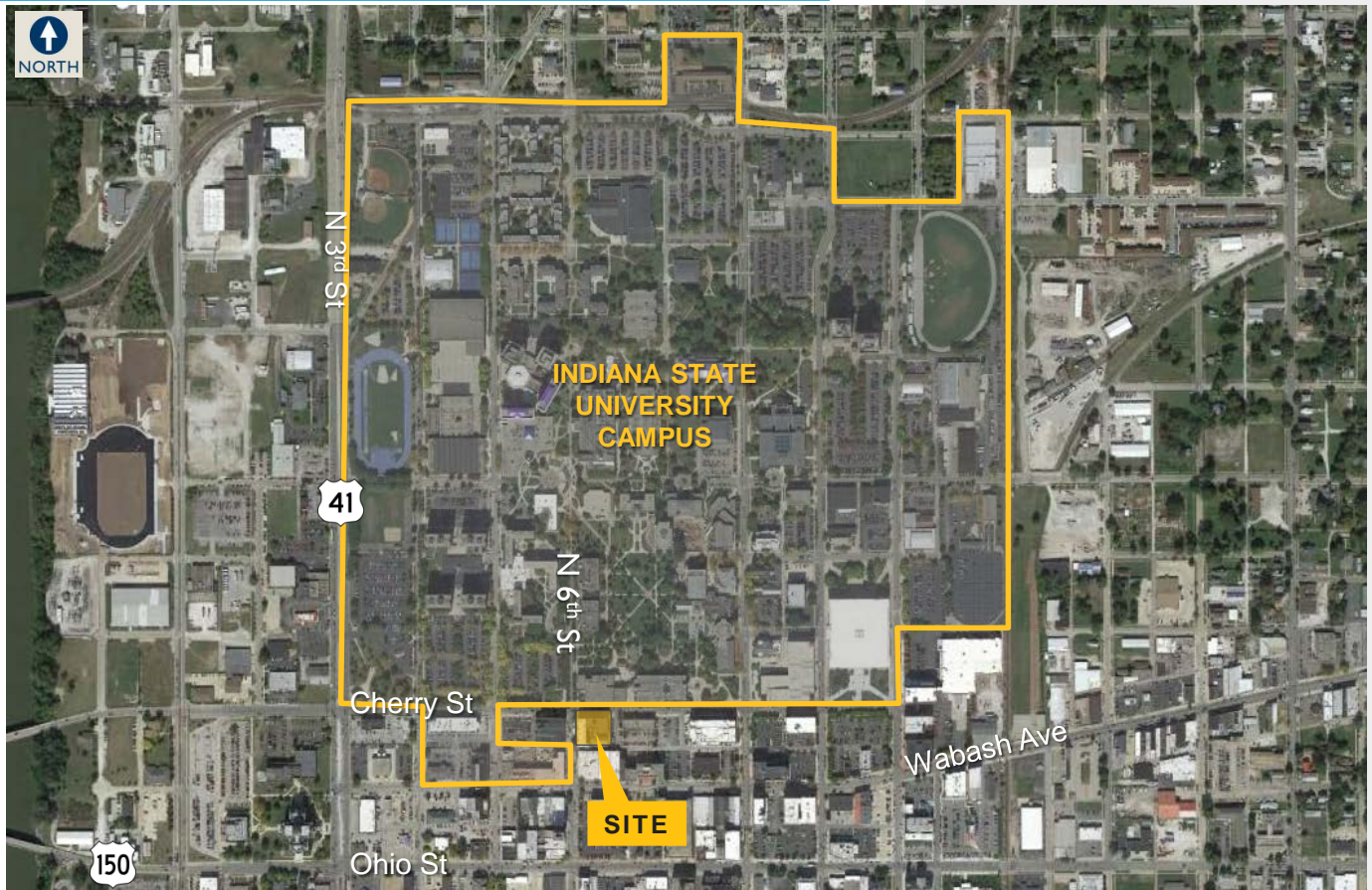

DEMOGRAPHICS

	1 Mile	3 Miles	5 Miles
Total Businesses	920	2,670	3,613
Total Employees	13,002	36,567	52,661
Population 2015	11,299	52,573	75,268
EST. Population 2020	11,405	53,080	76,196
Average Household Income 2015	\$29,449	\$40,219	\$46,089
EST. Average Household Income 2020	\$33,038	\$45,539	\$52,267



Contact

ALISON MELTON

317 713 2156

alison.melton@colliers.com

