

# PADS FOR SALE OR LEASE

## PANAMA LANE RETAIL DEVELOPMENT



SEC PANAMA LANE AND WIBLE ROAD, BAKERSFIELD, CA



JOHN HALE  
SENIOR VICE PRESIDENT | PRINCIPAL  
RETAIL PROPERTIES TEAM  
CENTRAL CALIFORNIA  
DIR 661 631 3815  
LICENSE NUMBER: 00870084  
john.hale@colliers.com

STEPHEN HALE  
ASSOCIATE  
RETAIL PROPERTIES TEAM  
CENTRAL CALIFORNIA  
DIR 661 631 3820  
LICENSE NUMBER: 01997969  
stephen.hale@colliers.com

KEVIN HALE  
ASSOCIATE  
RETAIL PROPERTIES TEAM  
CENTRAL CALIFORNIA  
DIR 661 631 3825  
LICENSE NUMBER: 02044018  
kevin.hale@colliers.com

COLLIERS INTERNATIONAL  
10000 Stockdale Hwy  
Suite 102  
Bakersfield, CA 93311  
661 631 3800  
www.colliers.com/bakersfield

# PADS FOR SALE OR LEASE

## PANAMA LANE RETAIL DEVELOPMENT

### PROPERTY INFORMATION

SEC PANAMA LANE AND WIBLE ROAD, BAKERSFIELD, CA

Located near the southeast corner of Panama Lane and Wible Road in southwest Bakersfield. The subject land is close to Freeway 99, retail and banking and offers a prime location for commercial or hospitality users.

### AVAILABLE

1 to 6 Acre Pads for Sale or Lease  
Call Agents for more details!

### HIGHLIGHTS

- > 12.99 Acres newly rezoned C-2
  - > Fast growing area of southwest Bakersfield
  - > Wide frontage on Panama Lane
  - > Close proximity to Freeway 99
  - > High Traffic Volume Intersection: 29,278 AADT
- 2018 [www.kerncog.com](http://www.kerncog.com)

### DEMOGRAPHICS:

	1 Mile	3 Mile	5 Mile
Population:	18,484	127,303	234,097
Employees:	3,625	26,809	54,554
Housing Units:	5,219	37,950	76,405
Avg HH Income:	\$64,636	\$60,695	\$66,569

2017 ALTERYX, INC.

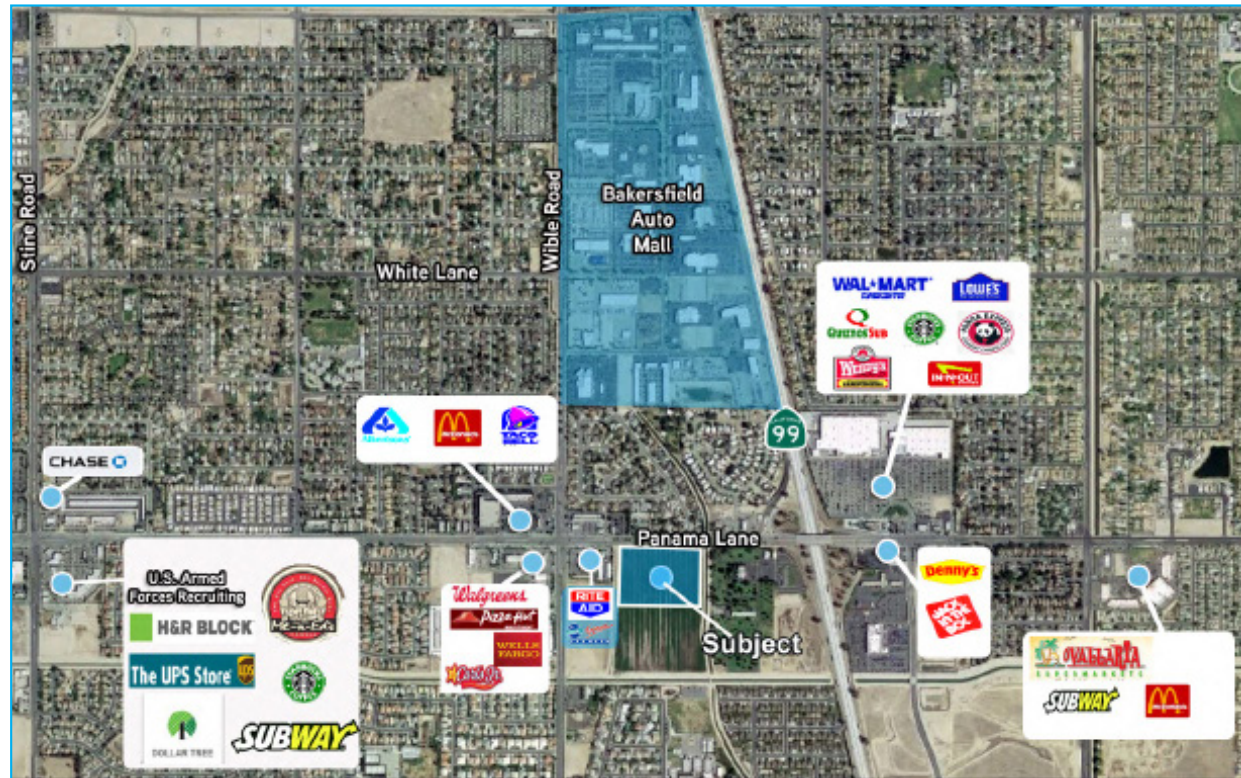

### COMPETITION MAP

# PADS FOR SALE OR LEASE

## PANAMA LANE RETAIL DEVELOPMENT

### CONCEPTUAL SITE PLAN

SEC PANAMA LANE AND WIBLE ROAD, BAKERSFIELD, CA

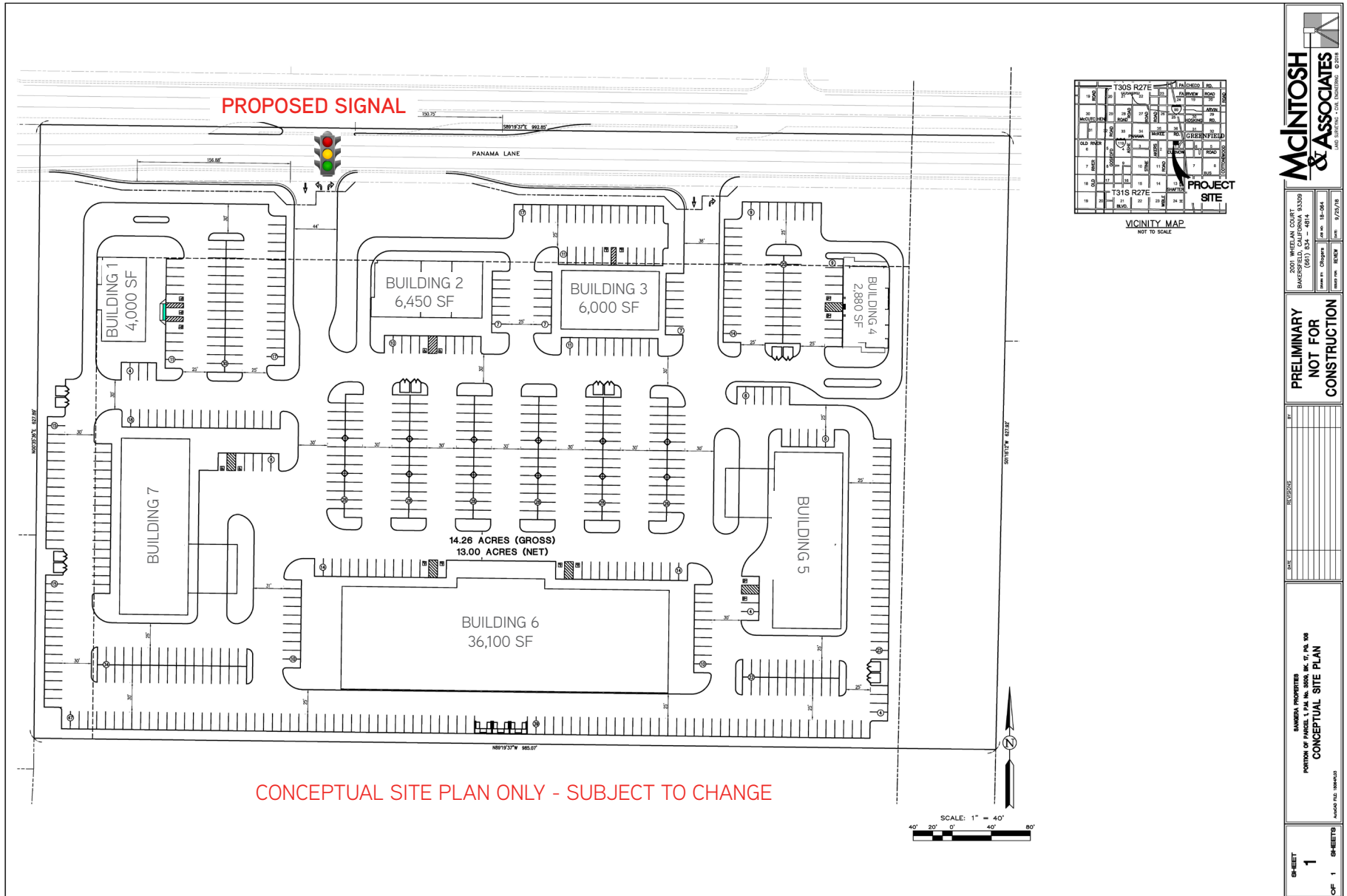

# PADS FOR SALE OR LEASE

## PANAMA LANE RETAIL DEVELOPMENT

### CITY MAP

SEC PANAMA LANE AND WIBLE ROAD, BAKERSFIELD, CA

#### CONTACT US

**JOHN HALE**  
SENIOR VICE PRESIDENT | PRINCIPAL  
RETAIL PROPERTIES TEAM  
CENTRAL CALIFORNIA  
DIR 661 631 3815  
LICENSE NUMBER 0870084  
[john.hale@colliers.com](mailto:john.hale@colliers.com)

**STEPHEN HALE**  
ASSOCIATE  
RETAIL PROPERTIES TEAM  
CENTRAL CALIFORNIA  
DIR 661 631 3820  
LICENSE NUMBER: 01997969  
[stephen.hale@colliers.com](mailto:stephen.hale@colliers.com)

**KEVIN HALE**  
ASSOCIATE  
RETAIL PROPERTIES TEAM  
CENTRAL CALIFORNIA  
DIR 661 631 3825  
LICENSE NUMBER: 02044018  
[kevin.hale@colliers.com](mailto:kevin.hale@colliers.com)

COLLIERS INTERNATIONAL  
10000 STOCKDALE HIGHWAY  
SUITE 102  
BAKERSFIELD, CA 93311  
[www.colliers.com/bakersfield](http://www.colliers.com/bakersfield)

