

FOR LEASE > OFFICE

8501-8639 Mayland Drive

PARHAM PARK | RICHMOND, VIRGINIA 23294



Property Features

- > 4 buildings totaling 50,400 SF
- > Private entrances
- > Ample parking available
- > Signage available on building
- > Well maintained property, owner on-site
- > Zoned O-2 (office)
- > Located on the corner of Mayland Drive and Parham Road, seconds from I-64 (Parham Road East exit)
- > **For Lease: \$16.50/SF, Net Janitorial & Electric**

CURRENT SUITES AVAILABLE

Building A - 8501 Mayland Drive >

Suite 105 ±1,680 SF

Building B - 8527 Mayland Drive > 100% leased

Building C - 8601-8629 Mayland Drive >

Suite 102	±1,120 SF	} Can be combined 2,352 SF
Suite 103	±1,232 SF	
Suite 8609	±640 SF	

Building D - 8639 Mayland Drive > 100% leased

AGENT: MATT HAMILTON
804 591 2431
RICHMOND, VA
matt.hamilton@colliers.com

AGENT: ERIC WILLIFORD
804 591 2473
RICHMOND, VA
eric.williford@colliers.com

COLLIERS INTERNATIONAL
7200 Glen Forest Drive, Suite 200
Richmond, VA 23226
www.colliers.com/richmond

FOR LEASE > OFFICE

8501-8639 Mayland Drive

PARHAM PARK | RICHMOND, VIRGINIA 23294



Building C - 8601-8629 Mayland Drive >

Suite 102 ±1,120 SF } Can be combined
Suite 103 ±1,232 SF } 2,352 SF

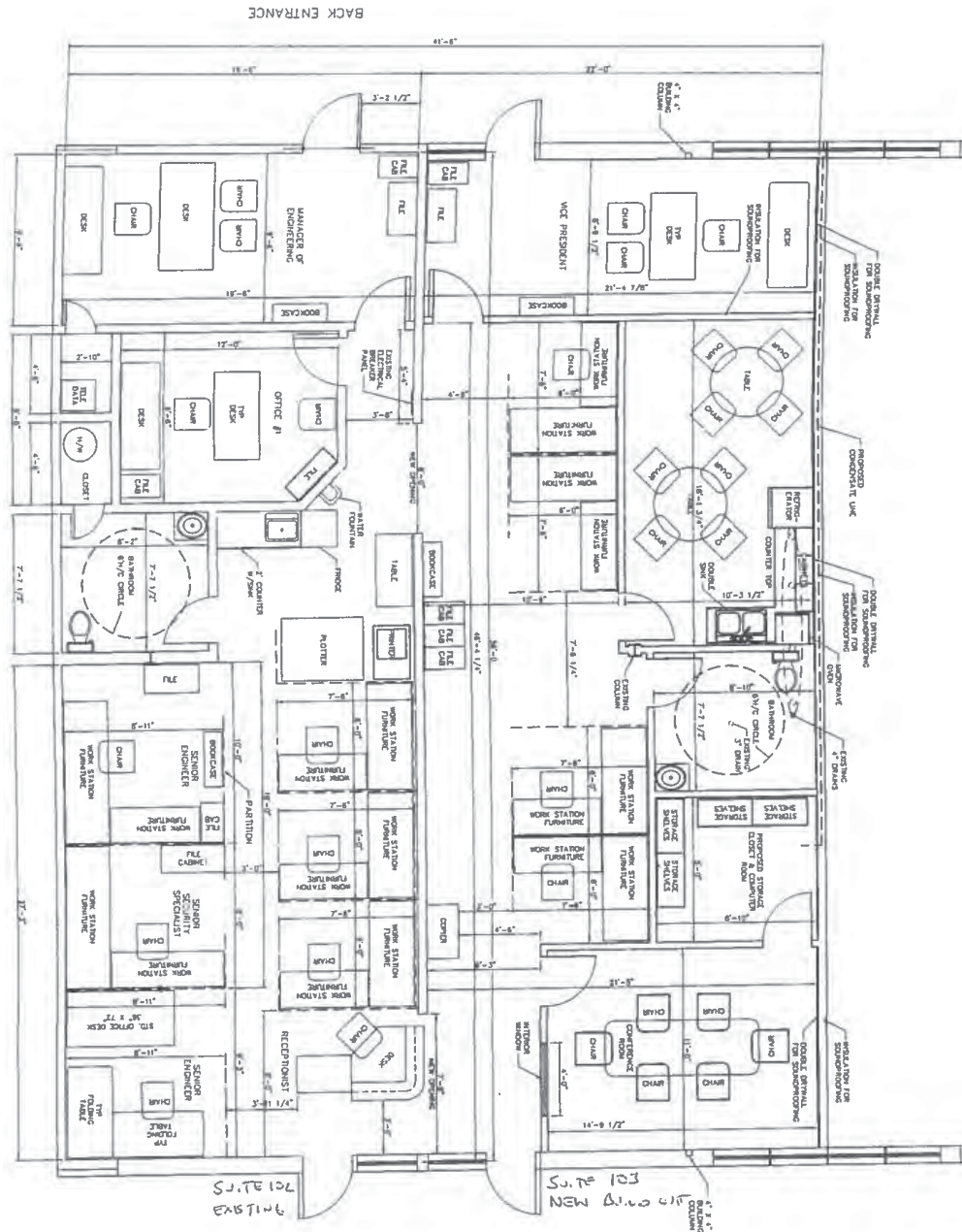

AGENT: MATT HAMILTON
804 591 2431
RICHMOND, VA
matt.hamilton@colliers.com

AGENT: ERIC WILLIFORD
804 591 2473
RICHMOND, VA
eric.williford@colliers.com

COLLIERS INTERNATIONAL
7200 Glen Forest Drive, Suite 200
Richmond, VA 23226
www.colliers.com/richmond

Parham Park > Photos/Map



The information contained herein was obtained from sources, believed reliable, however, Colliers International makes no guarantees, warranties or representations as to the completeness or accuracy thereof. The presentation of this property is submitted subject to errors, omissions, change of price or conditions prior to sale or lease, or withdrawal without notice. File Name: Mayland_8501-8639_ParhamPark_Lease rev 4-24-18

COLLIERS INTERNATIONAL
7200 Glen Forest Drive, Suite 200
Richmond, VA 23226
www.colliers.com/richmond