

FOR LEASE

South San Francisco Distribution Center 1416 San Mateo Avenue, South San Francisco, CA 94080

±15,000 SQUARE FEET AVAILABLE



Building Highlights

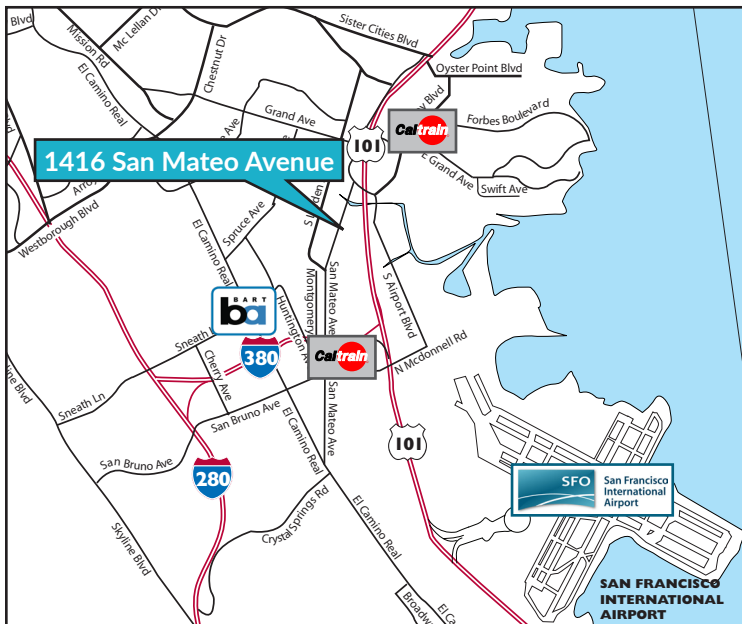

- ±15,000 Square foot space
- ±1,510 Square foot office
- 3 Dock-high door positions
- 20'-22' Feet of clearance (clear span)
- Fully sprinklered
- Zoned MI (Mixed Industrial) for a variety of uses
- Convenient access to US 101, I-280, I-380 and the San Francisco International Airport (SFO)
- Walking distance to the San Bruno BART and Caltrain Stations
- Property recently renovated
- Asking \$1.45 NNN

Owned by



BLACK CREEK GROUP

blackcreekgroup.com

Leased by



Colliers International
203 Redwood Shores Pkwy, Ste 125
Redwood City, CA 94065
colliers.com/sanfranciscopeninsula

Mike Davis, SIOR
Senior Vice President
mike.davis@colliers.com
+1 650 486 2219
CA License No. 01315877

Anthony Tuso
Senior Associate
anthony.tuso@colliers.com
+1 650 486 2288
CA License No. 01916449

South San Francisco Distribution Center 1416 San Mateo Avenue, South San Francisco, CA 94080

±15,000 SQUARE FEET AVAILABLE

Site Plan

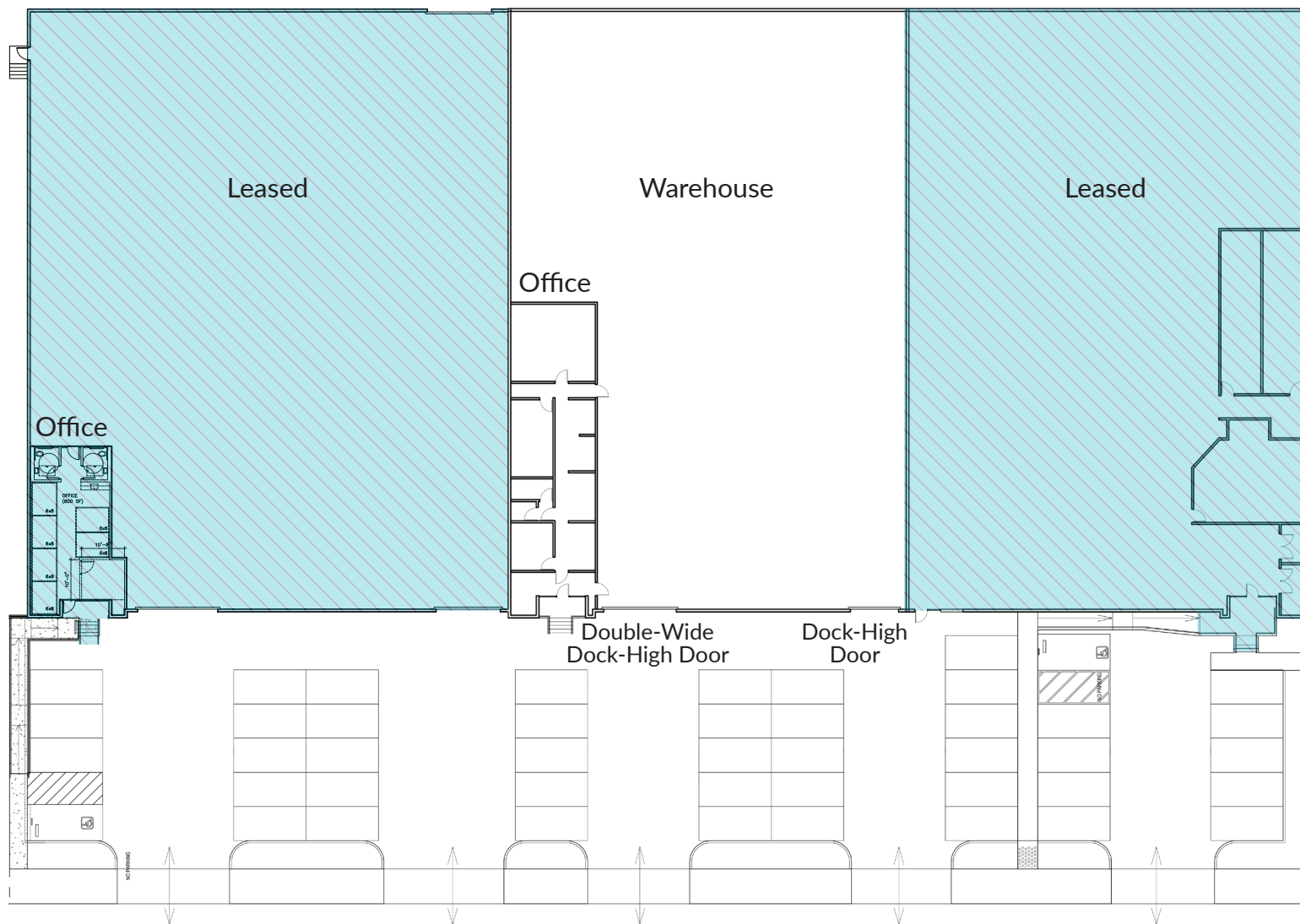

San Mateo Avenue

The information furnished has been obtained from sources we deem reliable and is submitted subject to errors, omissions and changes. Although Colliers International has no reason to doubt its accuracy, we do not guarantee it. All information should be verified by the recipient prior to lease, purchase, exchange, or execution of legal documents. © 2019 Colliers International

Owned by



BLACK CREEK GROUP

blackcreekgroup.com

Leased by



Colliers International
203 Redwood Shores Pkwy, Ste 125
Redwood City, CA 94065
colliers.com/sanfranciscopeninsula

Mike Davis, SIOR

Senior Vice President
mike.davis@colliers.com
+1 650 486 2219
CA License No. 01315877

Anthony Tuso

Senior Associate
anthony.tuso@colliers.com
+1 650 486 2288
CA License No. 01916449