



For Lease

9225 Ward Parkway Kansas City, Missouri

Office suites available on Ward Parkway

Property Features

- 32,250 SF office building
- Spaces available ranging between 1,139-2,710 SF
- Located near Ward Parkway Center which includes numerous shopping and dining options
- Ample surface parking - 116 spaces available
- 7,000 SF heated and secured parking garage with 16 spaces
- New ownership plans to renovate entire building
- Two Generac generators on site
- Easy access to I-435 via State Line Road

This document has been prepared by Colliers for advertising and general information only. Colliers makes no guarantees, representations or warranties of any kind, expressed or implied, regarding the information including, but not limited to, warranties of content, accuracy and reliability. Any interested party should undertake their own inquiries as to the accuracy of the information. Colliers excludes unequivocally all inferred or implied terms, conditions and warranties arising out of this document and excludes all liability for loss and damages arising there from. This publication is the copyrighted property of Colliers and/or its licensor(s). ©2025. All rights reserved. This communication is not intended to cause or induce breach of an existing listing agreement.

Lease Rate:

\$21.50
PSF, Full Service

Contact:

Jeff Winters

Senior Vice President
+1 816 556 1109
jeff.winters@colliers.com

Colliers Kansas City

4900 Main Street, Suite 400
Kansas City, MO 64112
+1 816 531 5303
colliers.com/kansascity

Floor Plan

Can be
combined
for a total of
2,710 SF

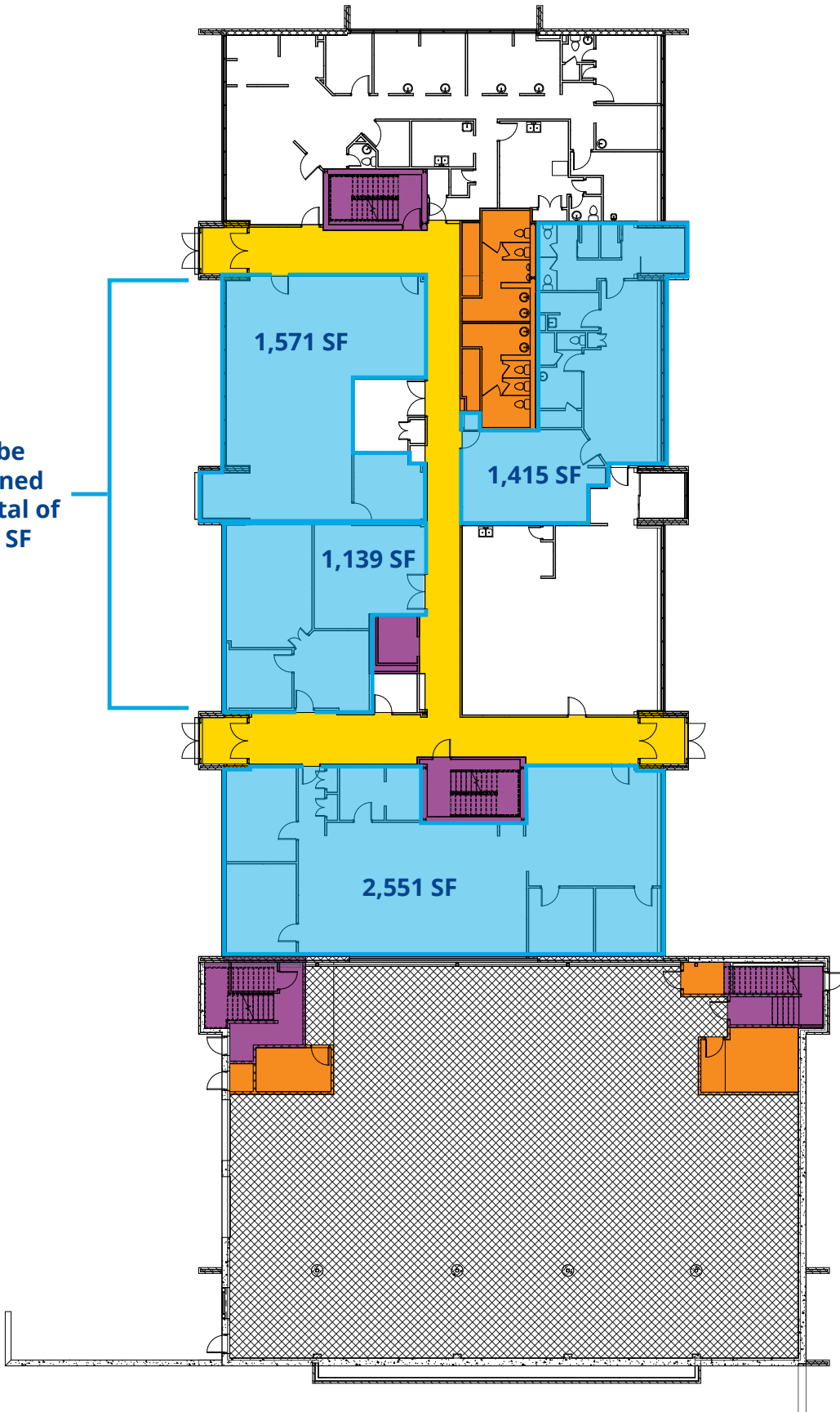

Location Aerial



Newly Renovated Second Floor

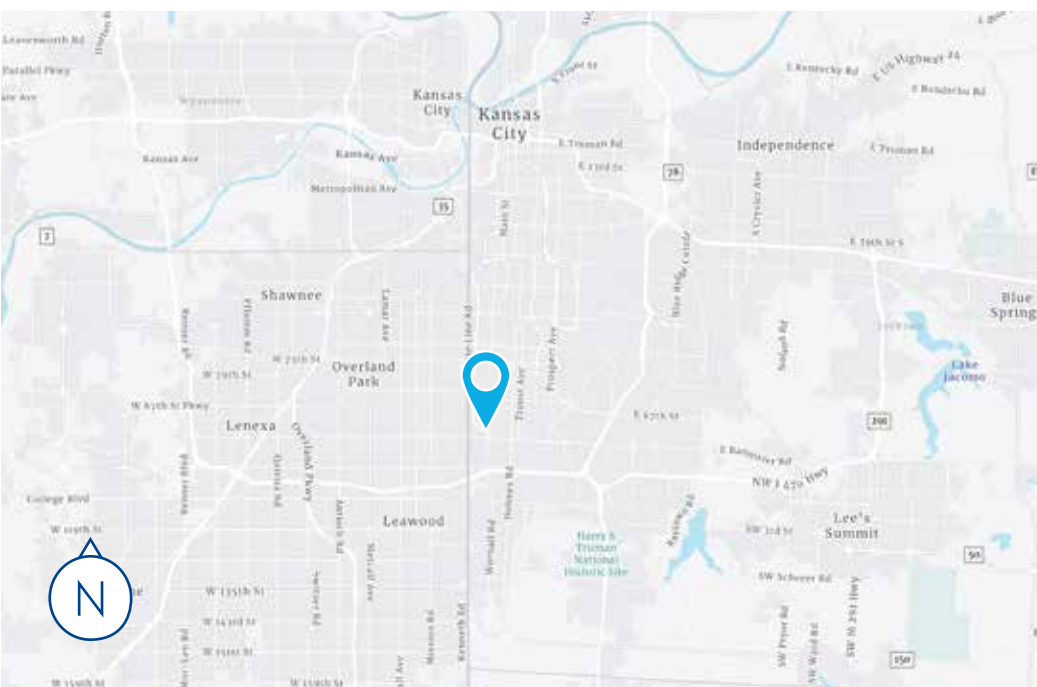

Contact:

Jeff Winters
Senior Vice President
+1 816 556 1109
jeff.winters@colliers.com

Colliers Kansas City
4900 Main Street, Suite 400
Kansas City, MO 64112
+1 816 531 5303
colliers.com/kansascity