

# THE VILLAGE OF CENTENNIAL SPRINGS

7557 NORMAN ROCKWELL LANE, LAS VEGAS, NEVADA, 89143



— NEWEST TENANTS —



NITTAYA'S  
*Little Bangkok*



POP SQUIRES PARK

CONSTRUCTION STARTS Q1 2020  
FOR 143 UNIT MULTIFAMILY DEVELOPMENT

FARM ROAD

TULE SPRINGS ROAD

— NOW OPEN —



EGG WORKS

EGG WORKS

## FOR LEASE

### CHRIS CLIFFORD

+1 702 836 3746  
chris.clifford@colliers.com  
License # NV-S.0067842.PC

### STEVE NEIGER, CCIM

+1 702 592 7187  
steve.neiger@colliers.com  
License # NV-S.0078706.LLC

### BRETT RATHER

+1 702 575 1645  
brett.rather@colliers.com  
License # NV-S.0174245.LLC

### Retail Space

±1,173 – ±2,056 SF  
\$2.25 (NNN \$0.57 PSF)

FOR LEASE

# THE VILLAGE OF CENTENNIAL SPRINGS



7557 NORMAN ROCKWELL LANE, LAS VEGAS, NEVADA, 89143

## PROPERTY HIGHLIGHTS

- Easy Access to the US-95 & I-215 Beltway
- Unique Mixed-use Community featuring Retail, Restaurants, Office, Second Story Condo's, and Pop Square Park
- Future 143-Unit Multifamily Development Planned
- Tenant Improvement Dollars Available
- Competitive Lease Rates for Farm/Durango Corridor
- Building 3, Suite 120 (±1,173 SF) Pet Salon space available February 2020 - Please Do Not Disturb Tenant. Grease Trap Already Installed to Premises

Note: One or more Colliers International agents is an owner/licensee

## DEMOGRAPHICS

	1 MILE	3 MILES	5 MILES
Daytime Population	3,746	15,031	28,563
Population	26,111	96,080	194,527
Households	8,927	33,130	66,600
Average HH Income	\$78,237	\$89,450	\$89,855

### CHRIS CLIFFORD

+1 702 836 3746  
chris.clifford@colliers.com  
License # NV-S.0067842.PC

### STEVE NEIGER, CCIM

+1 702 592 7187  
steve.neiger@colliers.com  
License # NV-S.0078706.LLC

### BRETT RATHER

+1 702 575 1645  
brett.rather@colliers.com  
License # NV-S.0174245.LLC

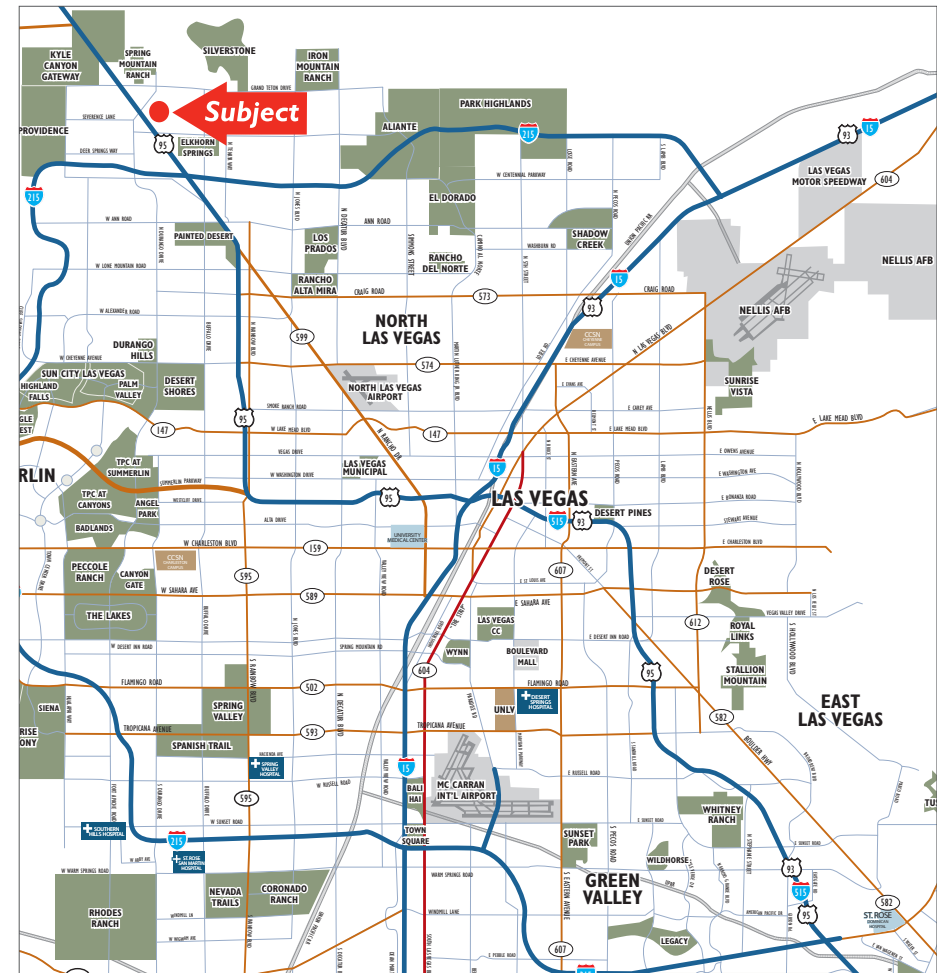

### Retail Space

±1,173 – ±2,056 SF  
\$2.25 (NNN \$0.57 PSF)



FOR LEASE

# THE VILLAGE OF CENTENNIAL SPRINGS



7557 NORMAN ROCKWELL LANE, LAS VEGAS, NEVADA, 89143



**CHRIS CLIFFORD**  
+1 702 836 3746  
chris.clifford@colliers.com  
License # NV-S.0067842.PC

**STEVE NEIGER, CCIM**  
+1 702 592 7187  
steve.neiger@colliers.com  
License # NV-S.0078706.LLC

**BRETT RATHER**  
+1 702 575 1645  
brett.rather@colliers.com  
License # NV-S.0174245.LLC

PROPERTY TYPE	SIZE	CONDITION
<b>BLDG. 2</b>		
Suite 110	-	Nittaya's Little Kitchen
Suite 120	-	Shall We Play A Game
Suite 130	-	The Vault Bike Shop
Suite 140	-	Total Community Management
<b>BLDG. 3</b>		
Suite 120*	Retail - Grease Trap Installed	1,173 SF AVAILABLE FEBRUARY 1, 2020
<b>BLDG. 7</b>		
Suite 110-130	-	Streets of New York
Suite 140	Retail	2,056 SF AVAILABLE
Suite 170	-	Sara's Threading
Suite 210	-	SW Injury Atty
Suite 230	-	SW Injury Atty
Suite 250	-	The Math Corner
Suite 270	-	Lucinda Flint Photography
<b>BLDG. 13</b>		
Suite 110	-	Big Apple Cleaners
Suite 130	Retail/Office	1,652 SF Grey Shell

\*SUITE 120 - Please Do Not Disturb Tenant

**Retail Space**  
**±1,173 – ±2,056 SF**  
**\$2.25 (NNN \$0.57 PSF)**



# THE VILLAGE OF CENTENNIAL SPRINGS



**NOW OPEN**

PTS, Capriotti's, TERRIBLE HERB, GOODYEAR, cricket

**NOW OPEN**

SPROUTS, CVS pharmacy, Fantastic Sams, CHEESEHOUSE, Doty's, CINECITY

**SUBJECT**

**FUTURE COLLEGE OF SOUTHERN NEVADA**

214,000 CPD

25,500 CPD

DURANGO DRIVE

FARM ROAD

TULE SPRINGS ROAD

95

Google

© Copyright 2019 Colliers International

+1 702 836 3746  
chris.clifford@colliers.com  
License # NV-S.0067842.PC

+1 702 592 7187  
steve.neiger@colliers.com  
License # NV-S.0078706.LLC

+1 702 575 1645  
brett.rather@colliers.com  
License # NV-S.0174245.LLC

±1,173 – ±2,056 SF  
\$2.25 (NNN \$0.57 PSF)

The information furnished has been obtained from sources we deem reliable and is submitted subject to errors, omissions and changes. Although Colliers Nevada, LLC has no reason to doubt its accuracy, we do not guarantee it. All information should be verified by the recipient prior to lease, purchase, exchange or execution of legal documents.



FOR LEASE

# THE VILLAGE OF CENTENNIAL SPRINGS



7557 NORMAN ROCKWELL LANE, LAS VEGAS, NEVADA, 89143

