

FOR LEASE

Oakdale Office Park
Oakdale, MN



Address

7541 - 7591 9th Street N
Oakdale, MN

Available Space for Lease

› 7561 9TH ST N (BUILDING D): 1,418 sf

Divisibility

› 1,418 sf

Parking

› Surface parking 6/1,000

Net Rental Rates

› \$10.00 - 12.00 psf

2015 Estimated Real Estate Taxes & Operating Expenses

› \$6.64 psf

Amenities

- › Office park containing six professional buildings
- › Flexible floor plates
- › Easy access to I-94, I-694 and I-494
- › Beautiful wooded setting
- › Immediate proximity to many restaurants and shopping
- › Ample surface parking
- › Storage space available

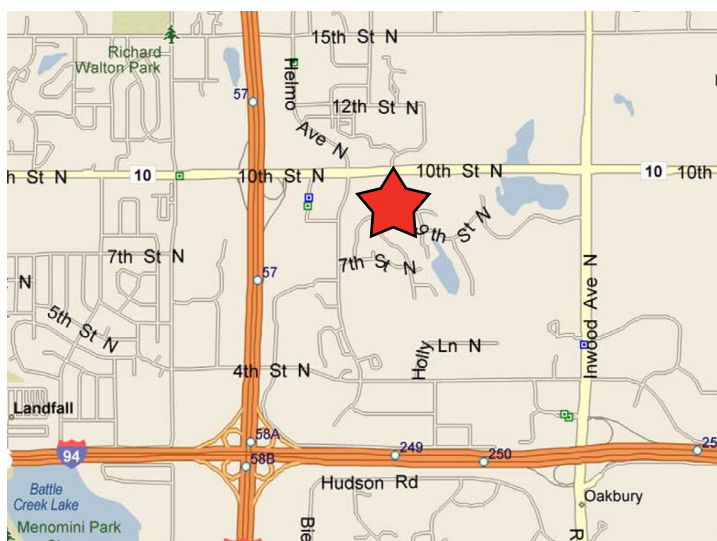

FOR LEASE

Oakdale Office Park
Oakdale, MN



BUILDINGS SF & AVAILABILITY

BLDG	ADDRESS	BLDG TOTAL SF	AVAILABLE SF FOR LEASE
A	7591 9TH ST N	6,000 SF	-
B	7581 9TH ST N	5,500 SF	-
C	7571 9TH ST N	7,000 SF	-
D	7561 9TH ST N	3,750 SF	1,418 SF
E	7541 9TH ST N	5,500 SF	-
F	7551 9TH ST N	7,200 SF	-

Contact Us

ERIC RAPP, SIOR
952 837 3060
eric.rapp@colliers.com

JAY CHMIELESKI
952 897 7801
jay.c@colliers.com

COLLIERS INTERNATIONAL
900 2nd Avenue South, Suite 1575
Minneapolis, MN 55402
952 897 7700
www.colliers.com/msp