



ROYAL WOOD OFFICE PLAZA



230 WEST 200 SOUTH
SALT LAKE CITY UTAH

ROYAL WOOD OFFICE PLAZA



Accelerating success.

230 WEST 200 SOUTH
SALT LAKE CITY UTAH

Brandon Fugal
801.947.8300
brandon.fugal@colliers.com

Josh Smith
801.453.6823
josh.smith@colliers.com

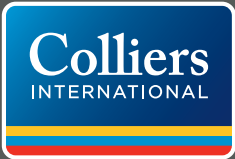

ROYAL WOOD OFFICE PLAZA

230 WEST 200 SOUTH SALT LAKE CITY, UT



- Suites available from 500 SF - 8,239 SF
- Lease rate: \$12.00/SF Full Service
- Flexible short lease terms available
- No load factor - pay on usable square feet
- Individual offices available
- 2/1000 parking included in lease rate
- 1 block to TRAX
- Fiber connectivity
- Armed security
- Close proximity to all downtown amenities including the Salt Palace Convention Center, hotels, restaurants and the Vivint Smart Home Arena

1ST FLOOR

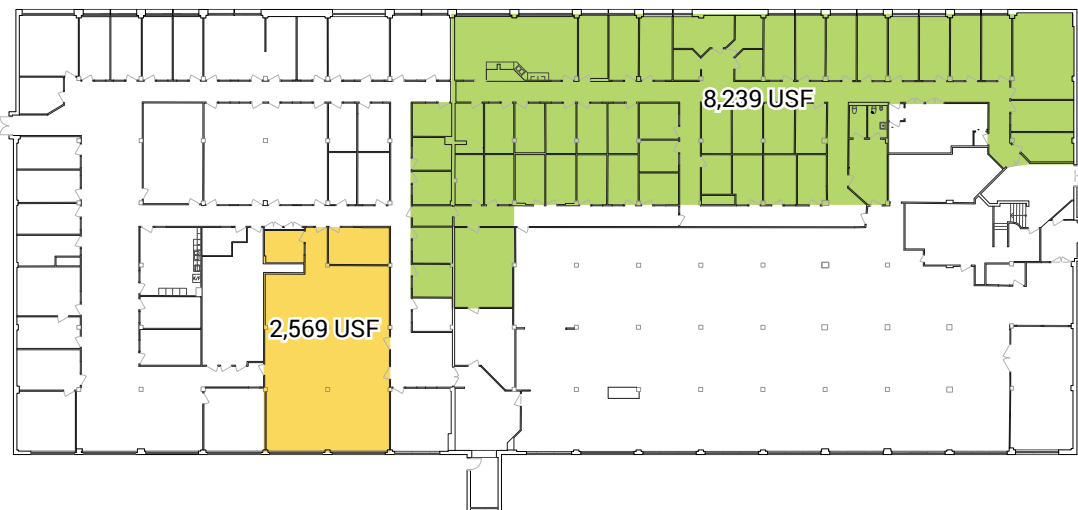

2ND FLOOR

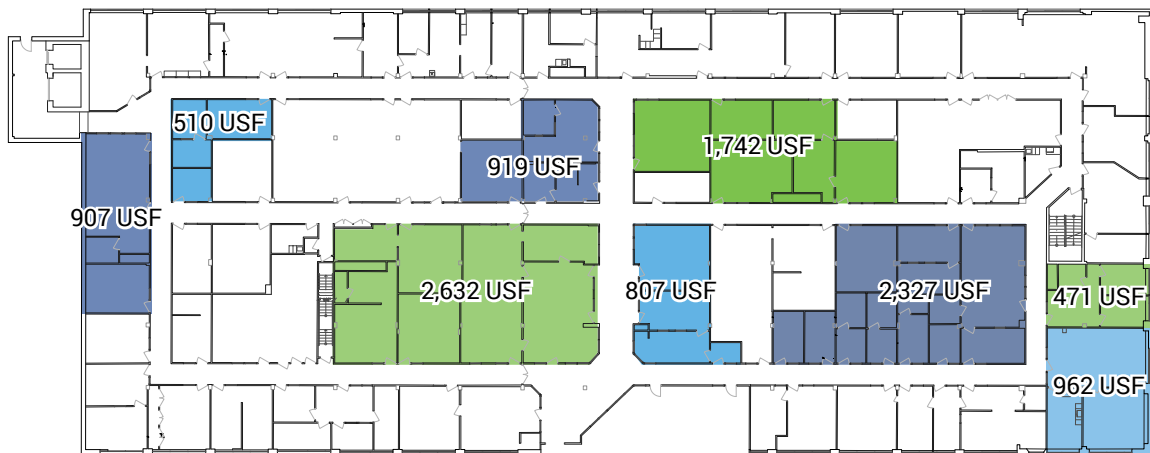

3RD FLOOR

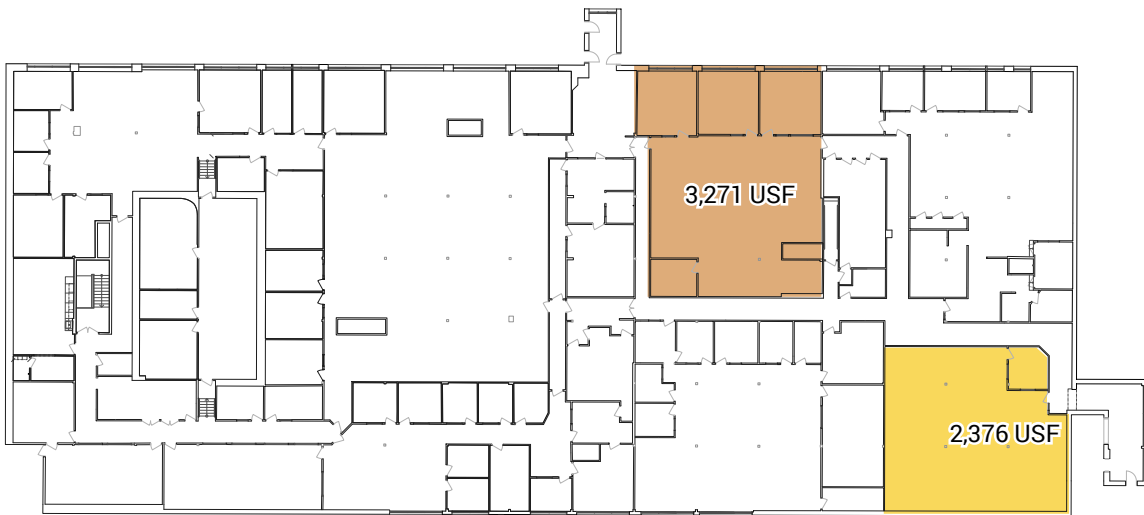

Accelerating success.

Brandon Fugal
801.947.8300
brandon.fugal@colliers.com

Josh Smith
801.453.6823
josh.smith@colliers.com

6550 South Millrock Drive, Suite 200
Salt Lake City, Utah 84121
www.colliers.com

This document has been prepared by Colliers International for advertising and general information only. Colliers International makes no guarantees, representations or warranties of any kind, expressed or implied, regarding the information including, but not limited to, warranties of content, accuracy and reliability. Any interested party should undertake their own inquiries as to the accuracy of the information. Colliers International excludes unequivocally all inferred or implied terms, conditions and warranties arising out of this document and excludes all liability for loss and damages arising there from. This publication is the copyrighted property of Colliers International and/or its licensor(s). ©2017. All rights reserved.