

FOR SALE > KANIS LAND

12807 Kanis Road,
Little Rock, AR 72211

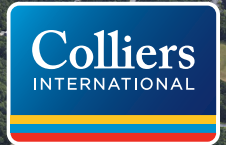

Site Size

- > +/- 2.85 acres
- > Building size: 1,750 SF

Zoning

- > "O-1," Office

Sale Price

- > \$499,000

Site Features

- > Located just west of Bowman and Kanis Roads intersection
- > Traffic count: approx. 14,000 vehicles per day on Kanis Road

Demographics

2017	1 mile	3 mile	5 mile
Population	9,089	53,973	119,008
Total Households	4,239	23,631	51,831
Avg. Household Income	\$77,037	\$83,192	\$88,372

FOR SALE > KANIS LAND

12807 Kanis Road,
Little Rock, AR 72211

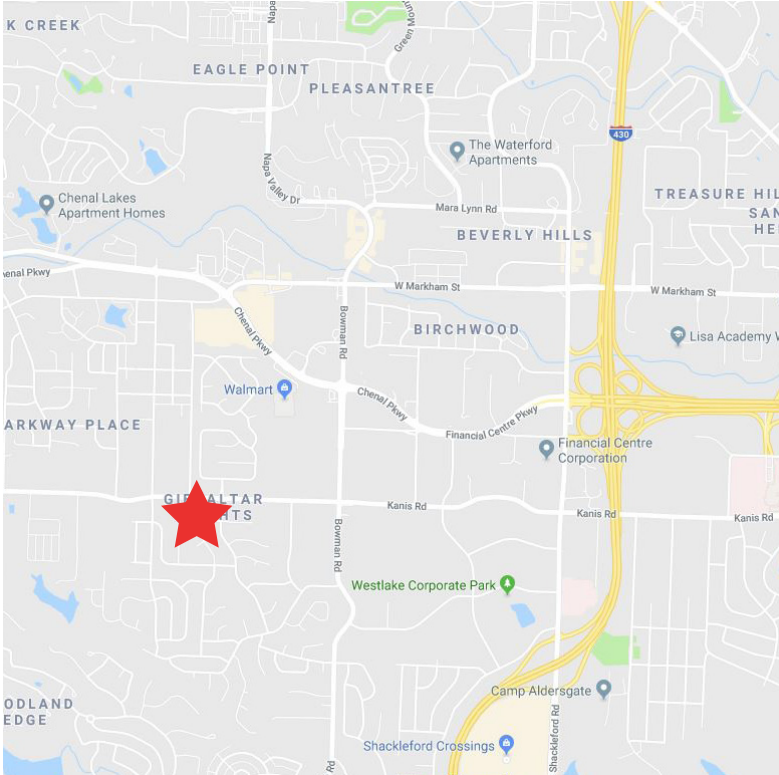

Contact Us

ISAAC SMITH, CCIM, SIOR
501 372 6161 | 736
isaac.smith@colliers.com

MARK BENTLEY, SIOR
501 372 6161 | 734
mark.bentley@colliers.com

JUSTIN BENTLEY
501 372 6161 | 739
justin.bentley@colliers.com

COLLIERS INTERNATIONAL
1 Allied Dr, Suite 1500
Little Rock, AR 72202
+1 501 372 6161
www.colliers.com/arkansas

CORE
VALUES

Client

Firm

Self

Fun

AERIAL



This document has been prepared by Colliers International for advertising and general information only. Colliers International makes no guarantees, representations or warranties of any kind, expressed or implied, regarding the information including, but not limited to, warranties of content, accuracy and reliability. Any interested party should undertake their own inquiries as to the accuracy of the information. Colliers International excludes unequivocally all inferred or implied terms, conditions and warranties arising out of this document and excludes all liability for loss and damages arising there from. This publication is the copyrighted property of Colliers International and/or its licensor(s). ©2016. All rights reserved.