



FOR SUBLEASE

11650 Lakeside Crossing Court
St. Louis, Missouri 63043



CLASS A OFFICE

10,025 SF Available in Central
St. Louis Suburban Location

ANDY PORT, SIOR
(d) +1 314 584 6254
(c) +1 314 973 0454
andy.port@colliers.com

DAN BAMBERGER
(d) +1 314 584 6226
(c) +1 314 435 8549
dan.bamberger@colliers.com

COLLIERS INTERNATIONAL
101 S. Hanley Road, Ste. 1400
St. Louis, MO 63105
+1 314 863 4447
colliers.com/stlouis

CLASS A OFFICE FOR SUBLEASE

11650 Lakeside Crossing Court, St. Louis, MO 63043

Property Highlights

- 10,025 SF office
- Central St. Louis County location
- Sublease until 2030
- Plug-in Play furniture available
- Heavy parking above 6/1,000
- Corporate location
- Internal staircase
- Kitchenette
- Elevator
- Two (2) sets of ADA bathrooms
- 2015 construction
- 9' ft ceilings
- Fiber: ATT & Charter
- Furniture available

Sublease Rate: \$15.95/SF, Full Service (not including janitorial)

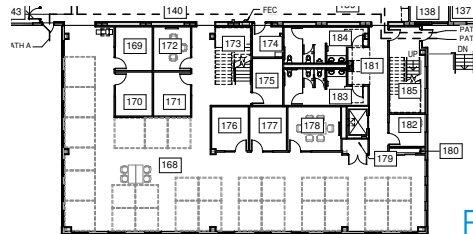

Floor 1

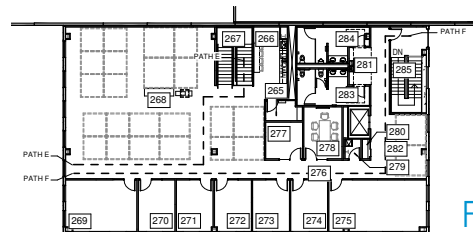

Floor 2

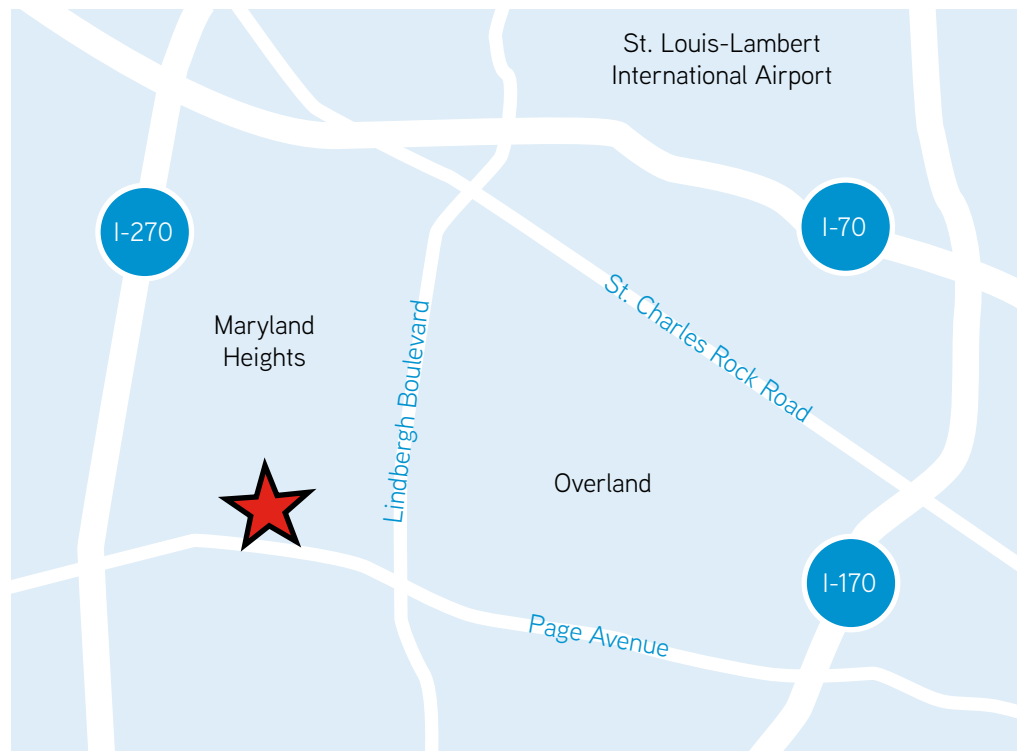

ANDY PORT, SIOR
(d) +1 314 584 6254
(c) +1 314 973 0454
andy.port@colliers.com

DAN BAMBERGER
(d) +1 314 584 6226
(c) +1 314 435 8549
dan.bamberger@colliers.com

This document/email has been prepared by Colliers International for advertising and general information only. Colliers International makes no guarantees, representations or warranties of any kind, expressed or implied, regarding the information including, but not limited to, warranties of content, accuracy and reliability. Any interested party should undertake their own inquiries as to the accuracy of the information. Colliers International excludes unequivocally all inferred or implied terms, conditions and warranties arising out of this document and excludes all liability for loss and damages arising there from. This publication is the copyrighted property of Colliers International and/or its licensor(s). © 2017. All rights reserved. This communication is not intended to cause or induce breach of an existing listing agreement.