



FORGEWORKS BUILDING

5,240 SF

1108 SE 9th Avenue
Portland, OR 97214

Available for lease

Located within the Central
Eastside Creative Overlay which
allows a wide range of uses

Includes small fenced yard

\$1.10
PSF
\$0.18 NNN

Scott MacLean

Senior Vice President

+1 503 542 5891

scott.maclea@colliers.com



5,240 SF - Includes small fenced yard

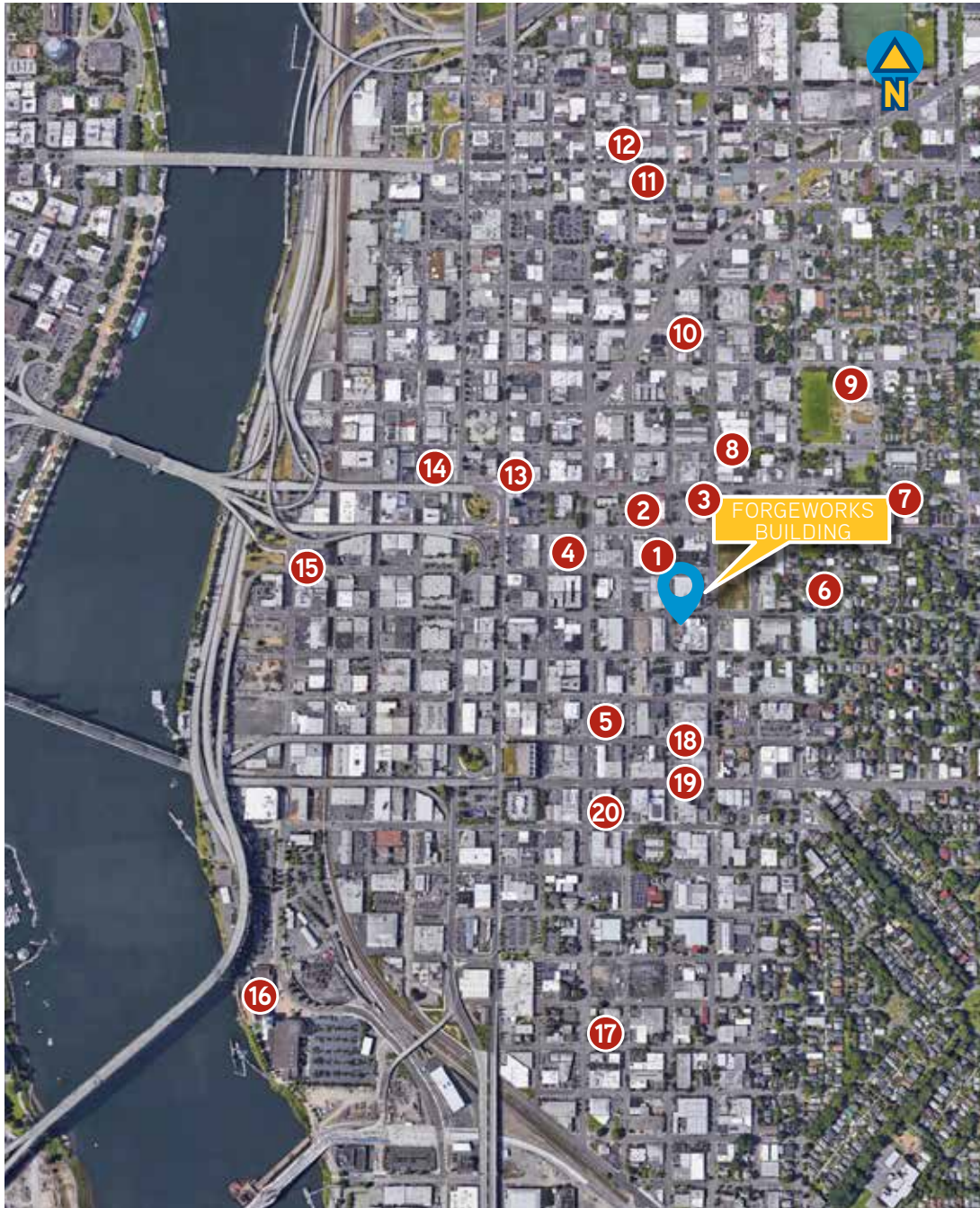

Area Restaurants and Amenities



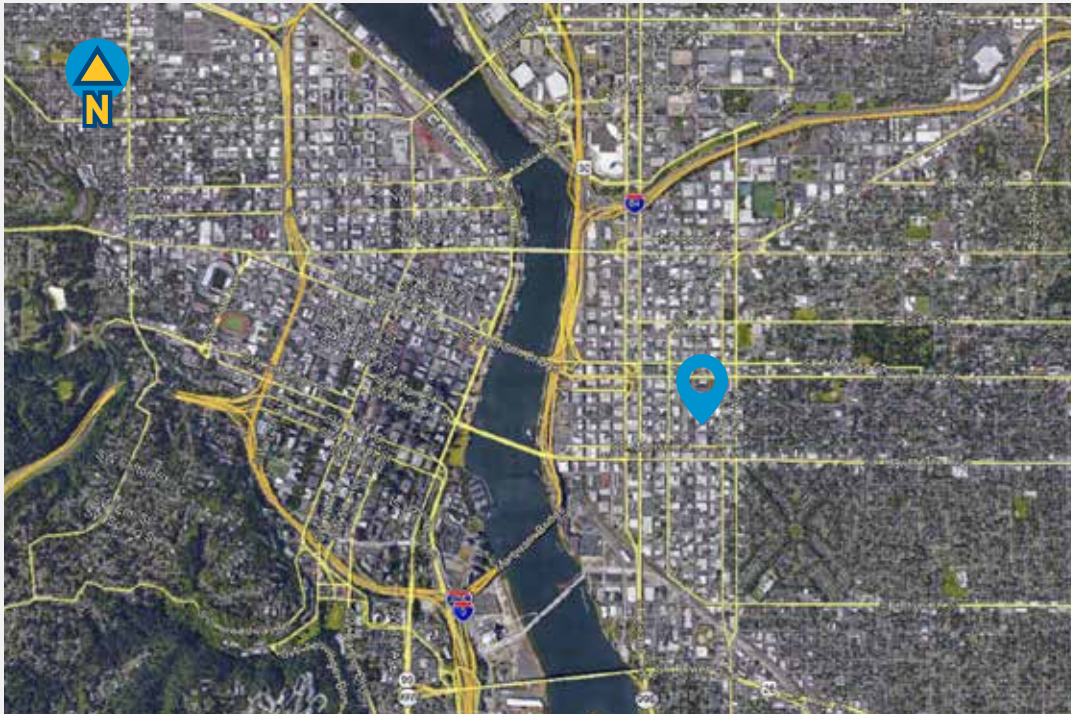
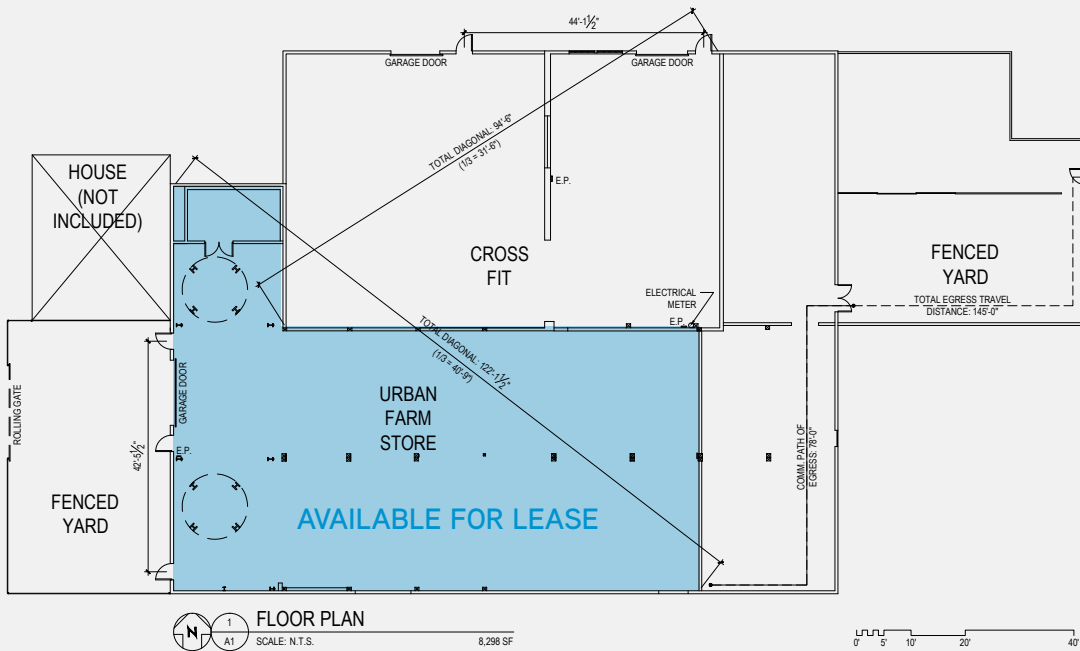

AREA MAP

BUILDING SPECIFICATIONS

- Size: 5,240 SF
- Zoning IG1 (the new overlay will go into effect this Spring)
- Sprinklered
- One grade level door
- Fenced yard



Walk Score 93
Walker's Paradise



Excellent Transit 72

\$1.10
PSF
NNN'S = \$0.18

CONTACT

Scott MacLean
Senior Vice President
+1 503 542 5891
scott.maclea@colliers.com



This document has been prepared by Colliers International for advertising and general information only. Colliers International makes no guarantees, representations or warranties of any kind, expressed or implied, regarding the information including, but not limited to, warranties of content, accuracy and reliability. Any interested party should undertake their own inquiries as to the accuracy of the information. Colliers International excludes unequivocally all inferred or implied terms, conditions and warranties arising out of this document and excludes all liability for loss and damages arising there from. This publication is the copyrighted property of Colliers International and/or its licensor(s). ©2018. All rights reserved.