



4,385 SF
Available

LEASED

LEASED

For Lease

Contact us:

Jimmy Martin, SIOR
Senior Vice President
+1 804 267 7218
jimmy.martin@colliers.com

Landmark Tech Center Richmond, VA 23228

- New construction
- 4,385 SF available in Building I
- 24' clear, ESFR, oversized truck/storage yard
- Staples Mill/Parham Road Intersection
- Offices to suit
- 3.5 miles from I-95, 3 miles from I-64
- Industrial zoning allows for multiple uses

BAKER
PROPERTIES
Owner-Developer

Colliers

Exclusive Agent

2221 Edward Holland Dr
Suite 600 | Richmond, VA
P: +1 804 320 5500
colliers.com/richmond

Landmark Tech Center

Building I Specs

- 4,385 SF Available
- 24' Clear
- 1 dock doors
- 1 12'x16' drive-in door
- 1 dock leveler, 2 edge of dock
- ESFR Sprinkler System
- 50'x40' column spacing
- LED lighting in warehouse
- 6" floor slab
- 400-amp, 208-volt, 3-phase electrical service
- 20 parking spaces with ability to add more in truck court



Building I | Rear View



Landmark Tech Center

Building I | 4,385 SF Available

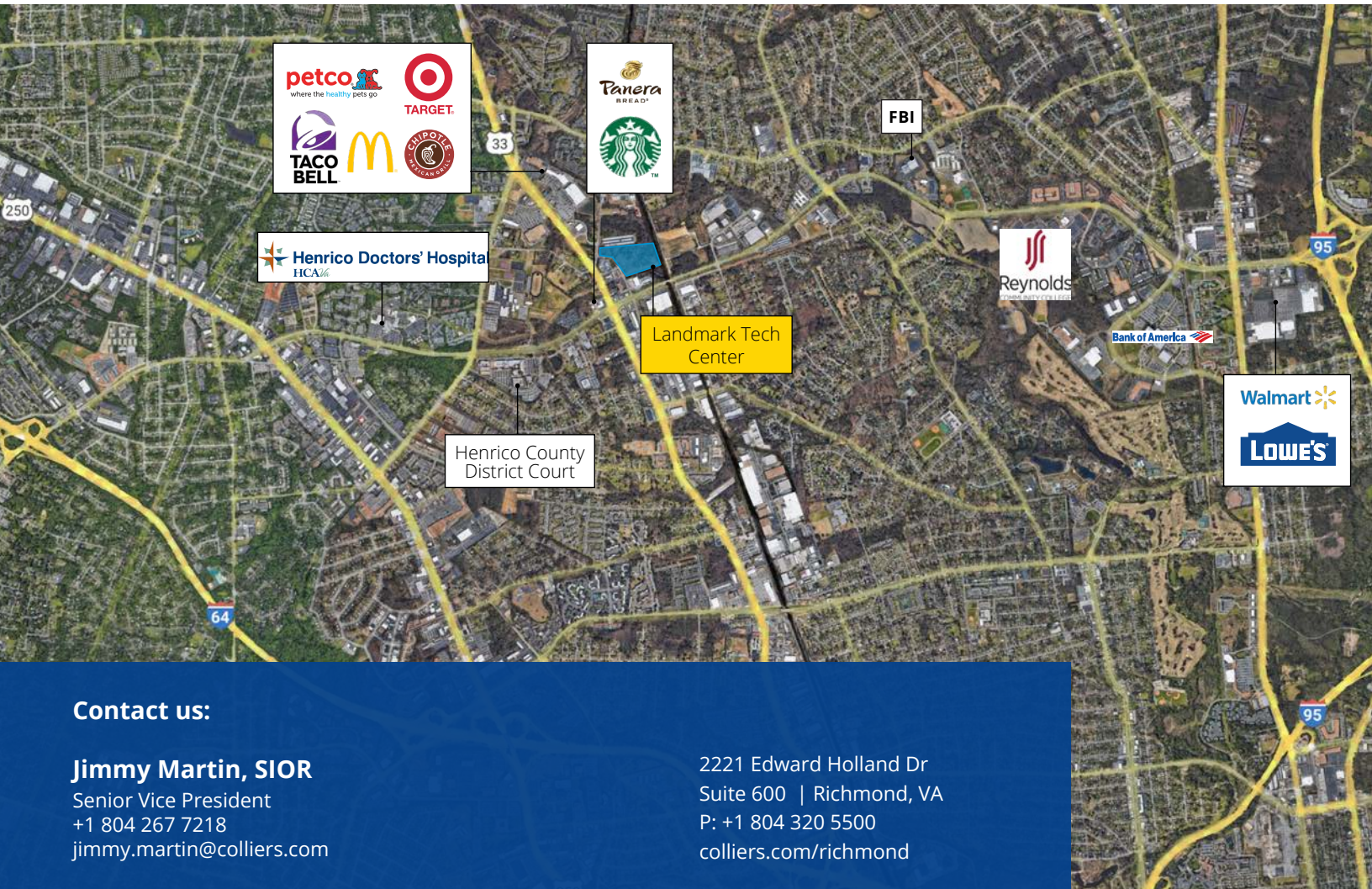
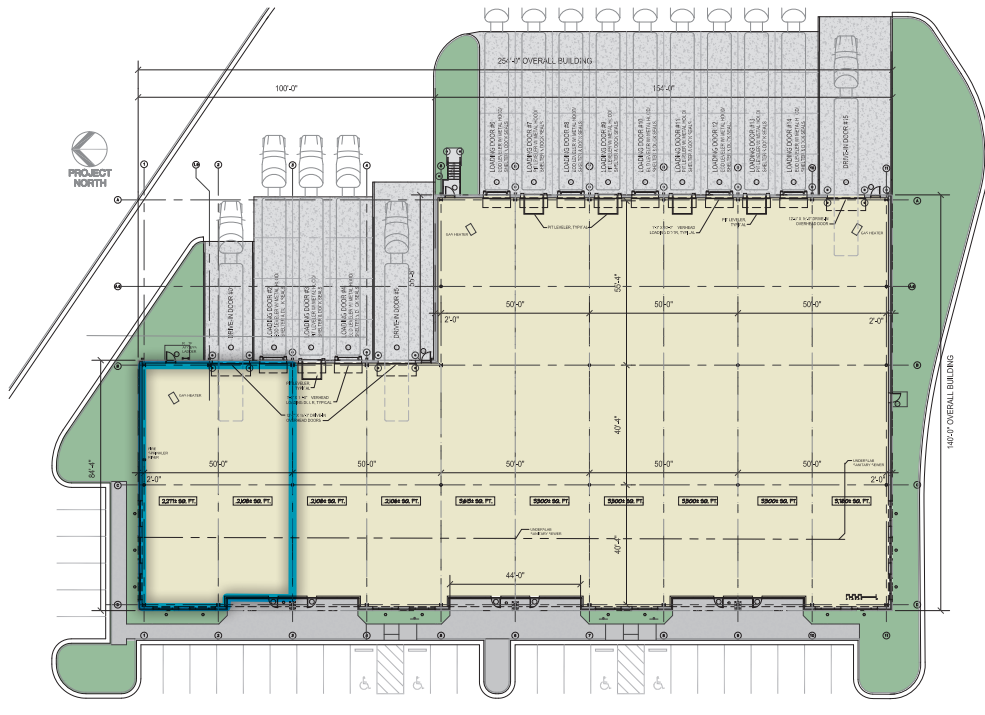

Contact us:

Jimmy Martin, SIOR
Senior Vice President
+1 804 267 7218
jimmy.martin@colliers.com

2221 Edward Holland Dr
Suite 600 | Richmond, VA
P: +1 804 320 5500
colliers.com/richmond