



# For Lease Pavilion Woods

2300 Andover Court,  
Little Rock, AR 72227

DREW HOLBERT, CCIM, SIOR  
501 372 6161 | 756  
drew.holbert@colliers.com

MASON LEWIS, CCIM  
501 372 6161 | 741  
mason.lewis@colliers.com



COLLIERS INTERNATIONAL  
1 Allied Dr, Suite 1500  
Little Rock, AR 72202  
501 372 6161  
[www.colliers.com/arkansas](http://www.colliers.com/arkansas)

## KEY FEATURES/HIGHLIGHTS

- › Space available: 3,000 RSF (Ste. 400)
- › Available January 2019
- › Lease rate: \$18.50/SF, Full Service Gross
- › Lot size: 1.86 AC
- › Zoning: "O-3," General Office District
- › Class "A" office space
- › Stoplight access on Cantrell Rd
- › Abundant parking

# FOR LEASE > Office Building

## FLOOR PLAN

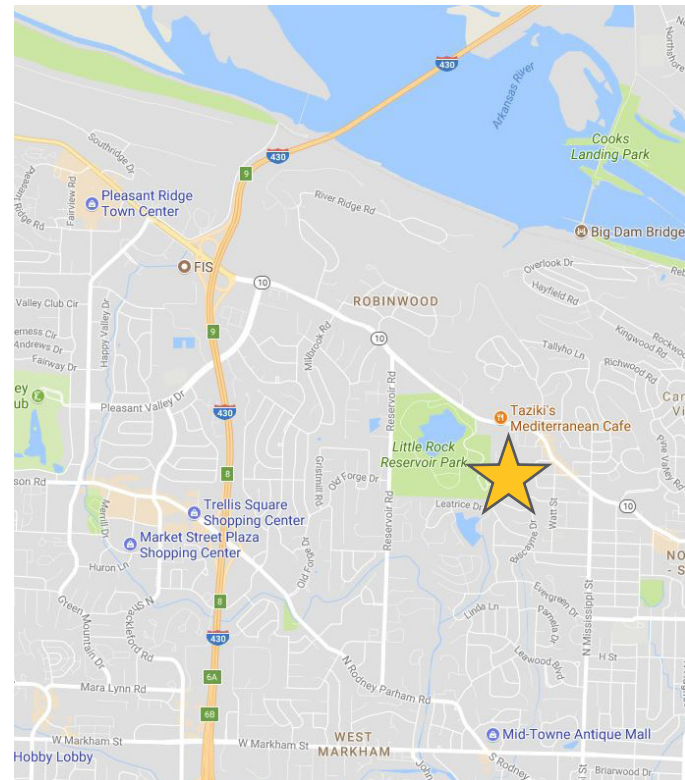
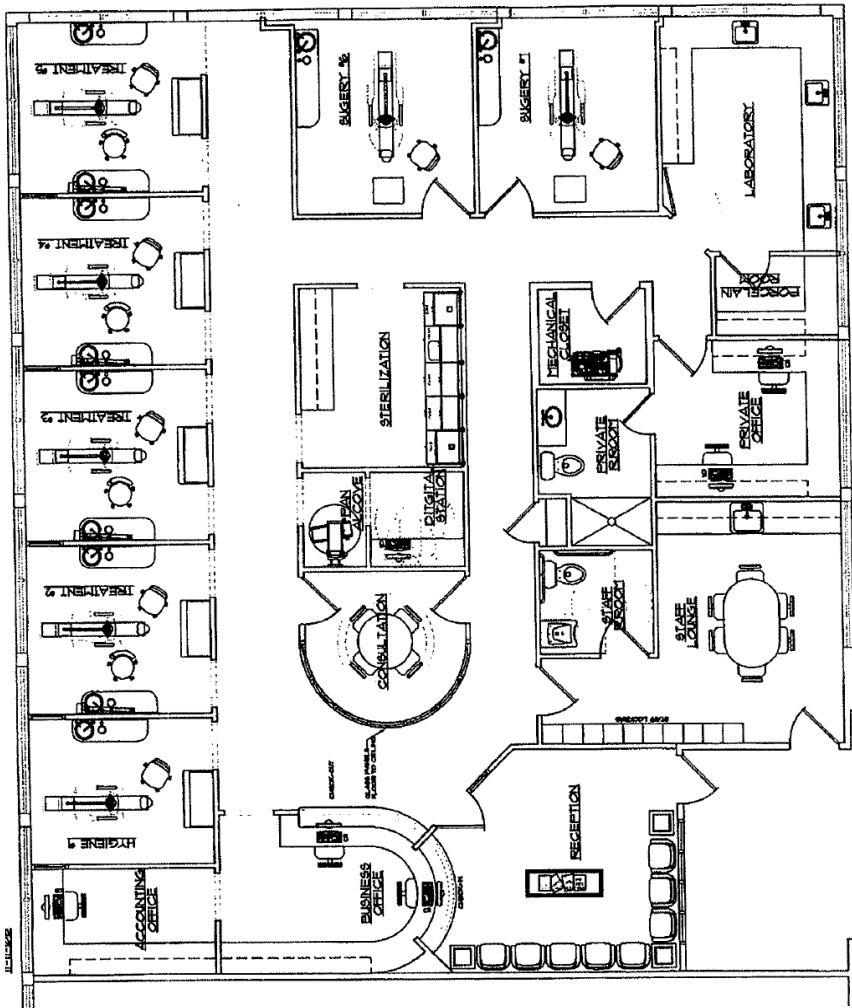

## CONTACT US

DREW HOLBERT, CCIM, SIOR  
501 372 6161 | 756  
[drew.holbert@colliers.com](mailto:drew.holbert@colliers.com)

MASON LEWIS, CCIM  
501 372 6161 | 741  
[mason.lewis@colliers.com](mailto:mason.lewis@colliers.com)



COLLIERS INTERNATIONAL  
1 Allied Dr, Suite 1500  
Little Rock, AR 72202  
+1 501 372 6161  
[www.colliers.com/arkansas](http://www.colliers.com/arkansas)

CORE  
VALUES

Client  
Firm  
Self  
Fun

This document has been prepared by Colliers International for advertising and general information only. Colliers International makes no guarantees, representations or warranties of any kind, expressed or implied, regarding the information including, but not limited to, warranties of content, accuracy and reliability. Any interested party should undertake their own inquiries as to the accuracy of the information. Colliers International excludes unequivocally all inferred or implied terms, conditions and warranties arising out of this document and excludes all liability for loss and damages arising there from. This publication is the copyrighted property of Colliers International and/or its licensor(s). ©2016. All rights reserved.