

# SUNSET CLIFFS PLAZA

## ±2,700 DIVISIBLE SF REMAINING



NEC SUNSET ROAD & HUALAPAI WAY

SUNSET ROAD

### FOR MORE INFORMATION:

**JOSEPH BONIFATTO** *Owner Licensee*  
+1 702 836 3729  
[joe.bonifatto@colliers.com](mailto:joe.bonifatto@colliers.com)

**GABRIEL SKERLICH**  
+1 702 836 3708  
[gabriel.skerlich@colliers.com](mailto:gabriel.skerlich@colliers.com)

3960 Howard Hughes Parkway, Suite 150  
Las Vegas, NV 89169  
T +1 702 735 5700  
[www.colliers.com/lasvegas](http://www.colliers.com/lasvegas)



# SUNSET CLIFFS PLAZA

±2,700 DIVISIBLE SF REMAINING

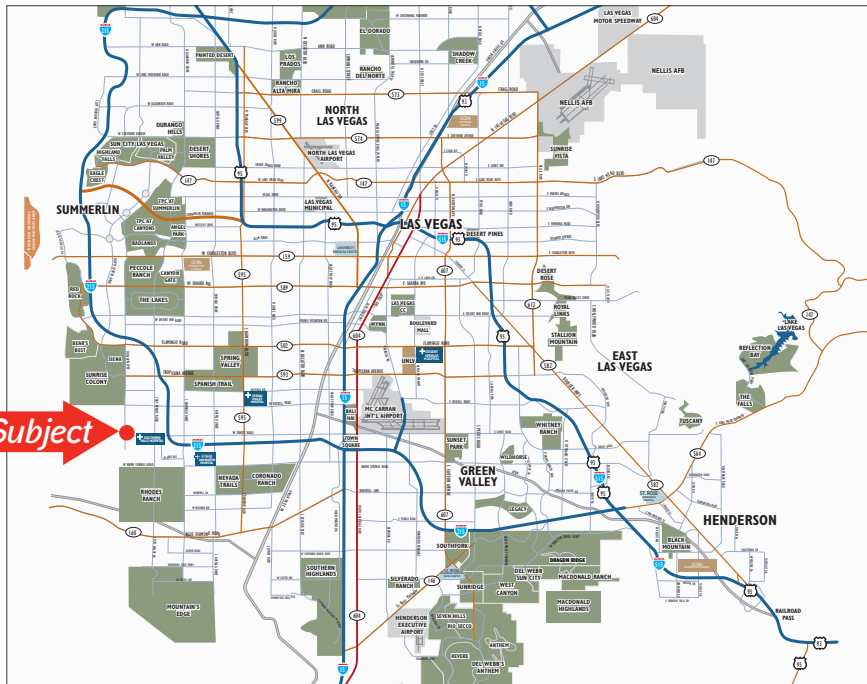

## FOR LEASE

### PROPERTY HIGHLIGHTS

±2,700 DIVISIBLE SF REMAINING

LOCATED IN SUMMERLIN

LEASE RATE STARTING AT \$3.25 PSF/MONTH NNN

#### QUICK FACTS:

- More than 100,000 residents
- More than 200,000 residents projected at completion
- More than 40,000 households in 19 villages
- More than 80,000 households in 31 villages projected at completion
- More than 22,000 employees

#### SUMMERLIN SOUTH NEW DEVELOPMENTS INCLUDE:

- Ikea
- Pardee Homes
- Bishop Gorman High School
- Cal Atlantic Homes
- Pulte Homes
- Woodside Homes
- Toll Brothers Regency



**Summerlin is a vibrant, ever-growing community with endless business opportunities.**

# SUNSET CLIFFS PLAZA

±2,700 DIVISIBLE SF REMAINING

