

RETAIL SPACE FOR LEASE >

South Robert Plaza

2000-2036 S Robert Street | West St. Paul, MN



Accelerating success.

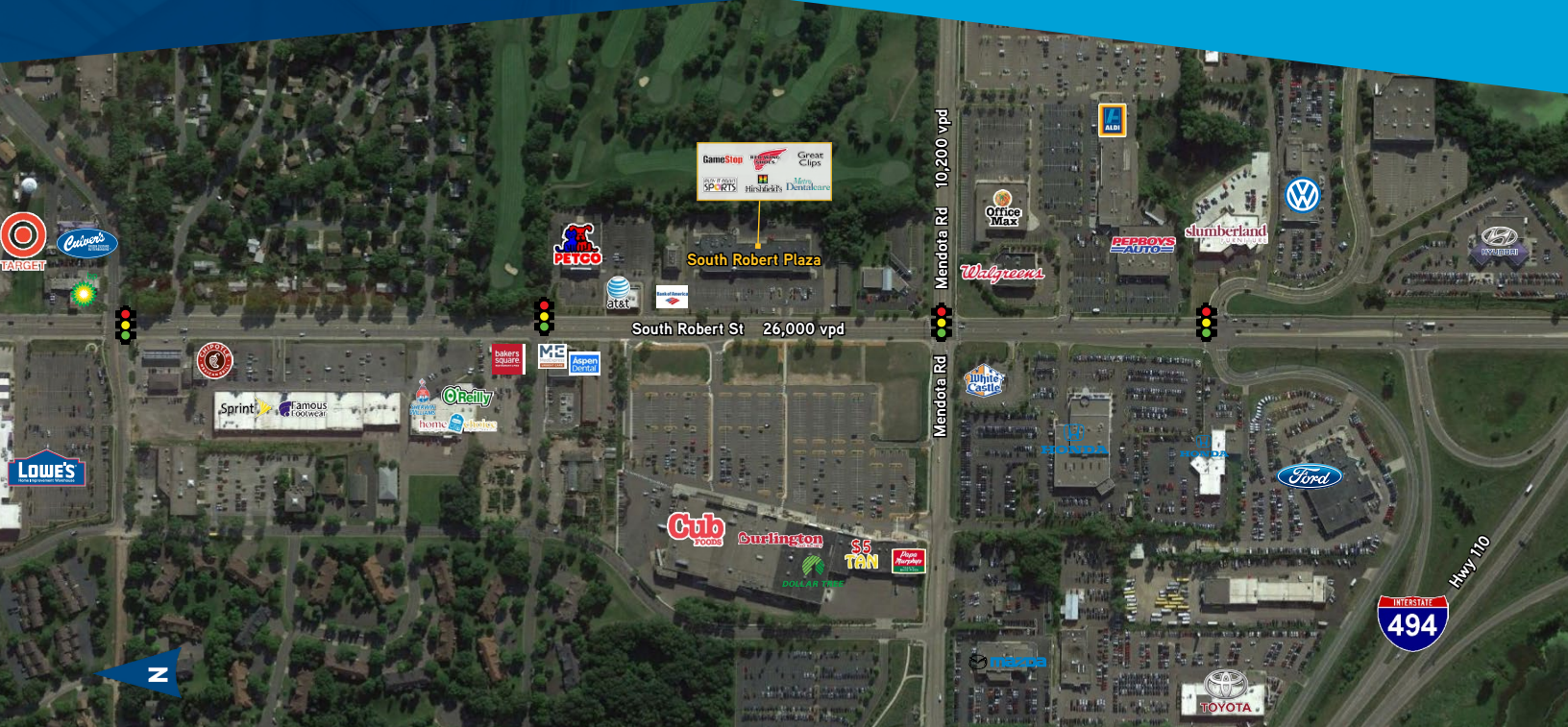

SITE PLAN

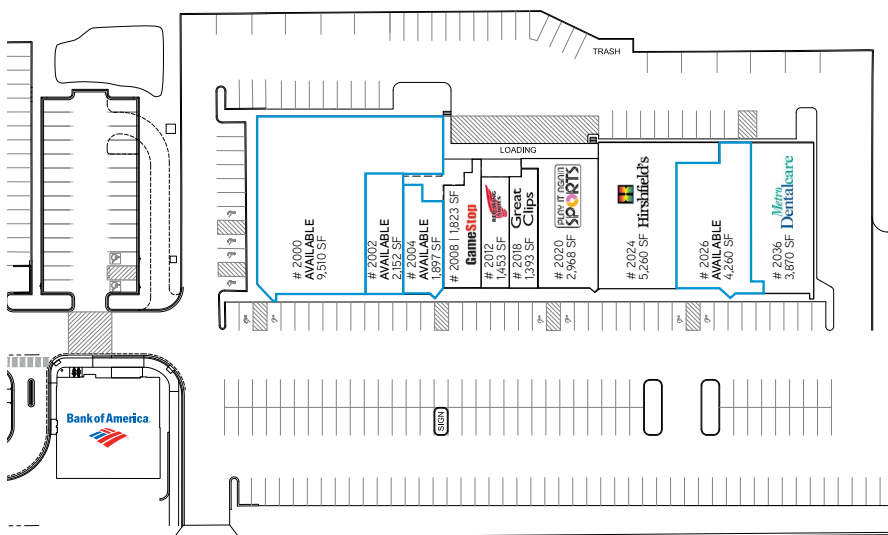

CONTACT US

Kris Schisel
952 897 7715
kris.schisel@colliers.com

RETAIL > FOR LEASE

SITE INFORMATION:

- > Location Just north of I-494 on S Robert St
- > Description Attractive Retail Strip Center
- > Center GLA 34,202 sf
- > Year Built 2007
- > Parking 250 Surface Spaces



AVAILABLE FOR LEASE

- > 1,838 sf - 9,510 sf
- > 13,600 sf of contiguous space - End Cap

2018 EST. CAM & TAX

- > \$3.66 psf CAM
- > \$3.80 psf Taxes
- > \$7.46 psf Total



DEMOGRAPHICS

Radius	1 Mile	3 Mile	5 Mile
Population	7,058	174,773	824,211
Median HH Income	\$45,055	\$51,056	\$52,692
Average HH Income	\$67,204	\$70,605	\$71,058

Source: Costar 2017, Estimates



TRAFFIC COUNTS

- > S Robert Street: 26,000 vpd
- > E Mendota Rd: 10,200 vpd
- > I-494: 106,000 vpd

COMMENTS

South Robert Plaza is located on “the” shopping corridor of West Saint Paul with 26,000 cars traveling per day. This established center sits at the main intersection linking easy travel and access to commuters also coming from surrounding communities like South Saint Paul, Inver Grove Heights, Mendota Heights and Sunfish Lake.



CENTER TENANTS



CONTACT US

Kris Schisel
952 897 7715
kris.schisel@colliers.com

