

VIEW ONLINE 

[colliers.com/greenville](https://colliers.com/greenville)

AVAILABLE

# Join South Ridge Retail

**FOR LEASE | 823 S. Church Street, Greenville | SC**

South Ridge is a prominent mixed-use project conveniently located between the CBD and the Augusta Road residential neighborhoods. The site has great visibility at a high traffic intersection and includes 350 apartments and several retailers such as Toss Pizza Pub, Biscuit Head and Mix Salon Studios. There is currently ±3,213 SF of retail space available for lease with substantial garage and surface parking on-site.

Starting from:

**\$25.00**  
PSF NNN

Lance Byars  
Brokerage Associate  
+1 864 527 5404  
[lance.byars@colliers.com](mailto:lance.byars@colliers.com)

Scott Burgess  
Brokerage Associate  
+1 864 527 5434  
[scott.burgess@colliers.com](mailto:scott.burgess@colliers.com)



Accelerating success.





## Specifications

Availability	3,213 SF
Address	823 S. Church Street
City, State Zip	Greenville, SC 29601
County	Greenville
Tax Map #	0091.02-02-001.00
Price/SF	\$25.00 NNN
Parking:	On-site
Year Built	2015
Retailers	Toss Pizza Pub, Biscuit Head, Mix Salon
Units	350 units on site
Visibility	Strong Visibility at High-traffic Intersection

### TRAFFIC COUNTS (2016):

- > S Church Street: 26,200 VPD
- > University Ridge: 10,400 VPD
- > I-385: 52,500 VPD

### DEMOGRAPHICS (2017):

	1-Mile	3-Miles	5-Miles
POPULATION	8,799	73,379	156,880
HOUSEHOLDS	4,297	30,901	64,708
AVERAGE HH INCOME	\$72,984	\$61,003	\$57,787

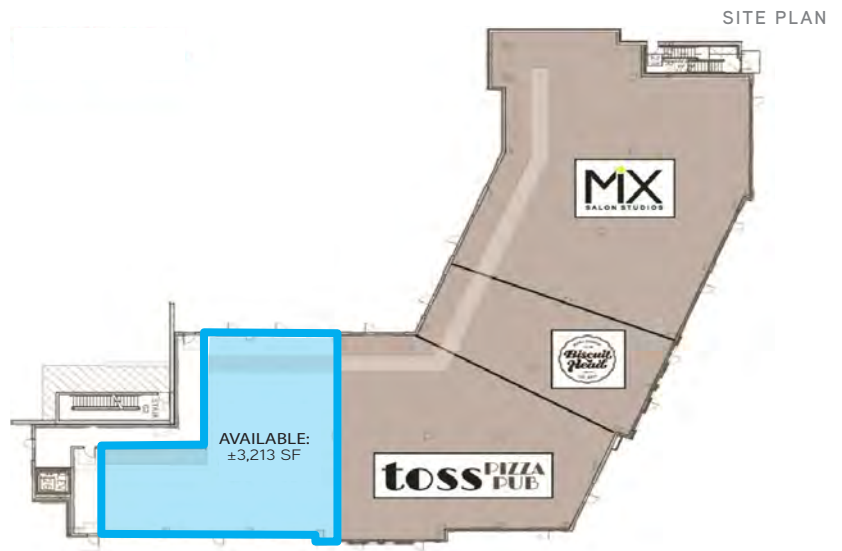

SITE PLAN



AERIAL

Contact us:

**Lance Byars**

Brokerage Associate

+1 864 527 5404

lance.byars@colliers.com

**Scott Burgess**

Brokerage Associate

+1 864 527 5434

scott.burgess@colliers.com



Accelerating success.