



FOR LEASE

Asking Rate:

\$34.00
PSF NNN

Contact us:

Alan W. Cole, CCIM

Principal & Executive VP
+1 479 644 5849
alan.cole@colliers.com

Mason Wood

Brokerage Associate
+1 479 409 0409
mason.wood@colliers.com

4204 S. Pinnacle Hills Parkway
Suite 102
Rogers, AR 72758
P: +1 479 636 9000
F: +1 479 254 3799
colliers.com

College Marketplace

3379 N College Avenue

Fayetteville, Arkansas

Property Features

Suite 5: 2,490 SF

- N College Avenue has a traffic count of 33,000 VPD
- Surrounded by retail, office, residential neighborhoods and new multifamily housing

Last remaining space for lease in popular College Marketplace shopping center in Fayetteville's Business & Shopping District. Anchored by Whole Foods Market and includes several other well-known national retailers; including new CAVA restaurant and IV Nutrition. Traffic light gives direct access into the center with N College Avenue boasting more than 33,000 cars per day.

Copyright © 2021 Colliers International.

Information herein has been obtained from sources deemed reliable, however its accuracy cannot be guaranteed. The user is required to conduct their own due diligence and verification.



Property Highlights

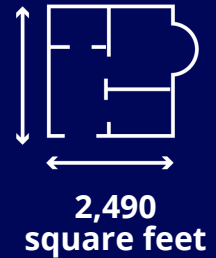

2,490 square feet



Abundant parking on site



Surrounded by retail, restaurants and housing



Located in high-volume shopping center

LOCATION



Demographics

	1 Mile	3 Mile	5 Mile
Population (2024)	6,672	49,367	140,623
Projected Population (2029)	6,965	51,446	147,854
Average HH Income (2024)	\$89,755	\$94,331	\$84,865
Proj. Average HH Income (2029)	\$101,109	\$108,267	\$97,300
Households (2024)	3,381	22,167	55,204



Information herein has been obtained from sources deemed reliable, however its accuracy cannot be guaranteed. The user is required to conduct their own due diligence and verification.

Contact us:

Alan W. Cole, CCIM

Principal & Executive VP
+1 479 644 5849
alan.cole@colliers.com

Mason Wood

Brokerage Associate
+1 479 409 0409
mason.wood@colliers.com



Accelerating success.

4204 S. Pinnacle Hills Parkway
Suite 102
Rogers, AR 72758
P: +1 479 636 9000
F: +1 479 254 3799