



51,023 SF AVAILABLE FOR LEASE

2660 Columbia Street
Torrance, CA 90503

- Central Torrance Location
- Like New Building Exterior and Interior
- \pm 12,079 SF of Corporate Offices
- 75 Car Parking
- High efficiency T-5 Lighting with Motion Sensors
- Professionally Owned & Managed by First Industrial Realty Trust

Highlights

Available Space:	51,023 SF
Building SF:	100,778 SF
Office Space:	12,079 SF
Clear Height:	20'
Dock High:	4
Parking Ratio:	1.5/ 1,000 SF
Power:	1,200 Amps 277-480 Volts

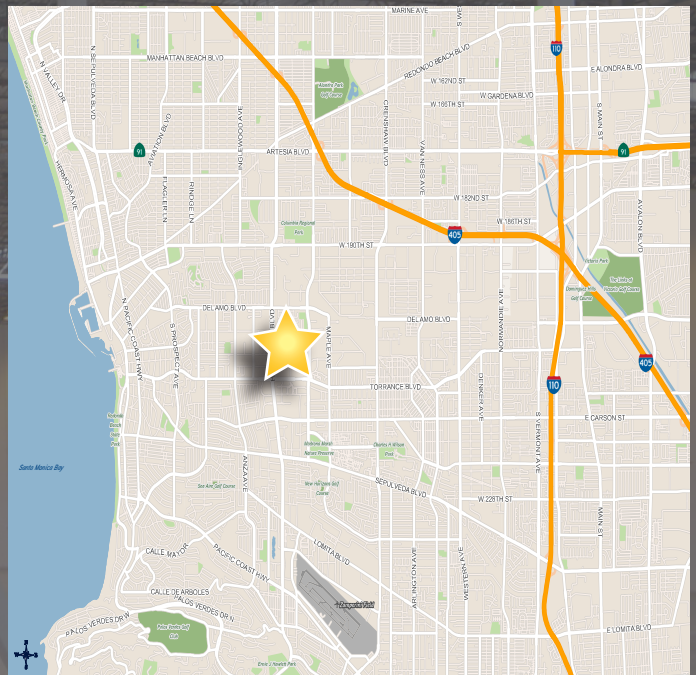

2660 Columbia Street
Torrance, CA 90503

Site Plan

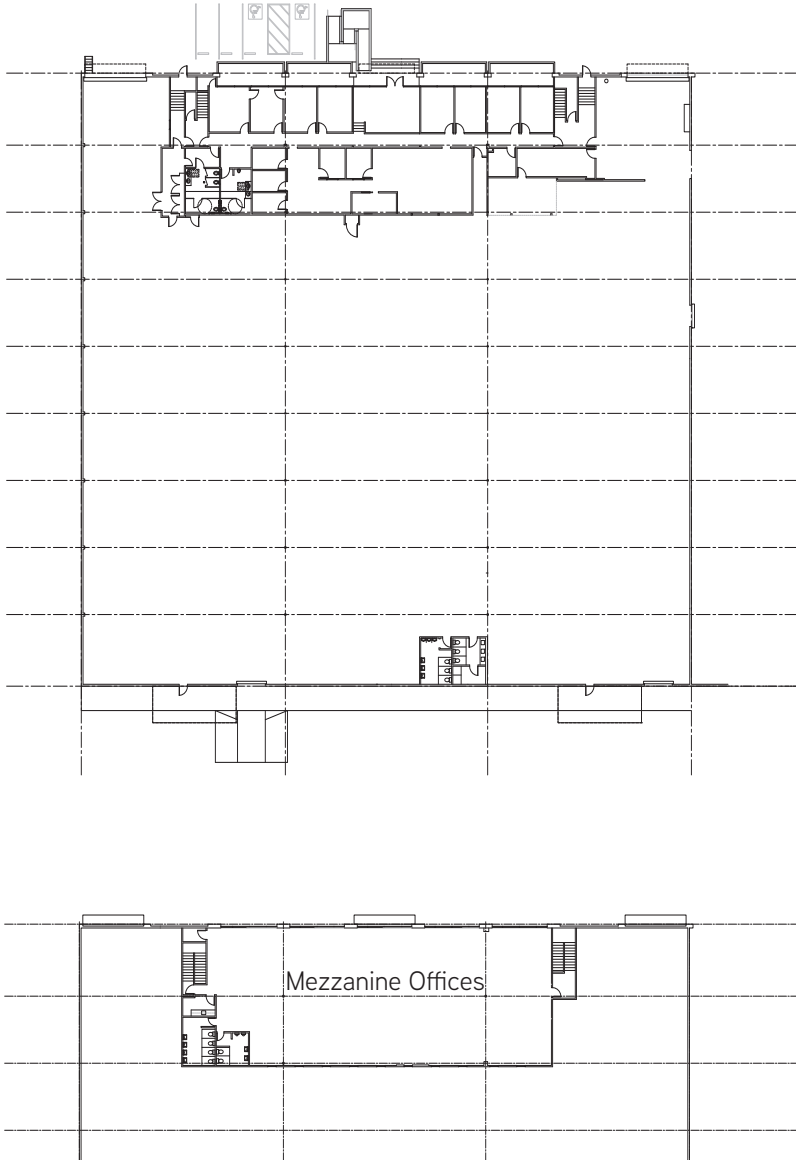

Broker Contact:

JEFF SMART

Executive Vice President

License No. 00918873

+1 310 321 1812

jeffrey.smart@colliers.com

JOSH MAY

Senior Vice President

License No. 01386831

+1 310 321 1808

josh.may@colliers.com

GRACE YI

Senior Associate

License No. 01837630

+1 310 321 1830

grace.yi@colliers.com

2121 Rosecrans Avenue
Suite 3301

El Segundo, CA 90245

www.colliers.com



Owner Contact:

JERRY DEVON

Marketing & Leasing Director

898 N. Sepulveda Blvd. | Suite 750

El Segundo, CA 90245

Direct: +1 (424) 220-9212

jdevon@firstindustrial.com



www.firstindustrial.com

All information furnished regarding the property for sale, rental or financing is obtained from sources deemed reliable. No representation is made to the accuracy thereof and is submitted subject to errors, omissions, change of price rental or other conditions, prior sale, lease, or financing, or withdrawal without notice. First Industrial Realty Trust, Inc. represents the Seller in this transaction and as such owes all duties and obligations