

FOR LEASE > RETAIL

2157 Bluestone Drive

ST. CHARLES, MO 63303



Property Features

- > 1,500 SF retail space available
- > Highway 94 visibility and access
- > Signalized intersection at Highway 94 and Portwest Drive
- > Excellent demographics and traffic counts
- > **LEASE RATE:** \$16.00/SF, Modified Gross

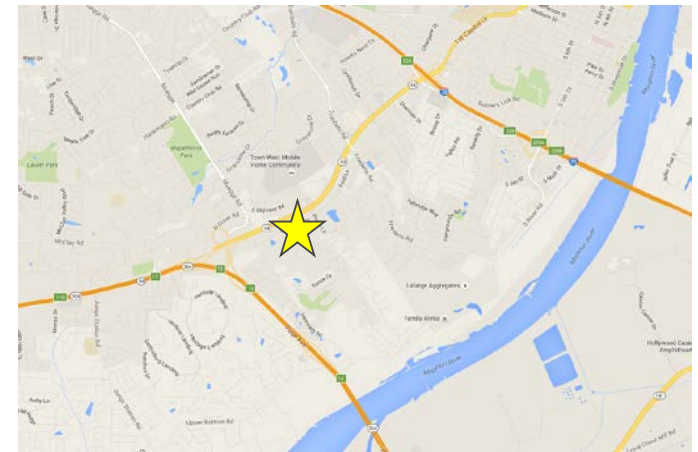

Contact Us

CHAD J. BURKEMPER
DIR +1 314 584 6279
MOB +1 636 579 9020
chad.burkemper@colliers.com

COLLIERS | ST. LOUIS
101 South Hanley Road, Suite 1400
St. Louis, MO 63105
www.colliers.com

Although all information furnished regarding property for sale, rental or financing is from sources deemed reliable, such information has not been verified, and no express representation is made nor is any to be implied as to the accuracy thereof, and it is submitted subject to errors, omissions, change of price, rental or other conditions, prior sale, lease or financing, or withdrawal without notice.

FOR LEASE > RETAIL

2157 Bluestone Drive

ST. CHARLES, MO 63303



Demographics

	1 MILE	3 MILE	5 MILE
Population	9,437	79,797	159,752
Avg HH Income	\$80,255	\$76,427	\$78,838
Median Age	41.0	37.3	38.9
Businesses	585	2,541	5,896
Employees	4,623	25,224	82,769

Area Amenities Include:

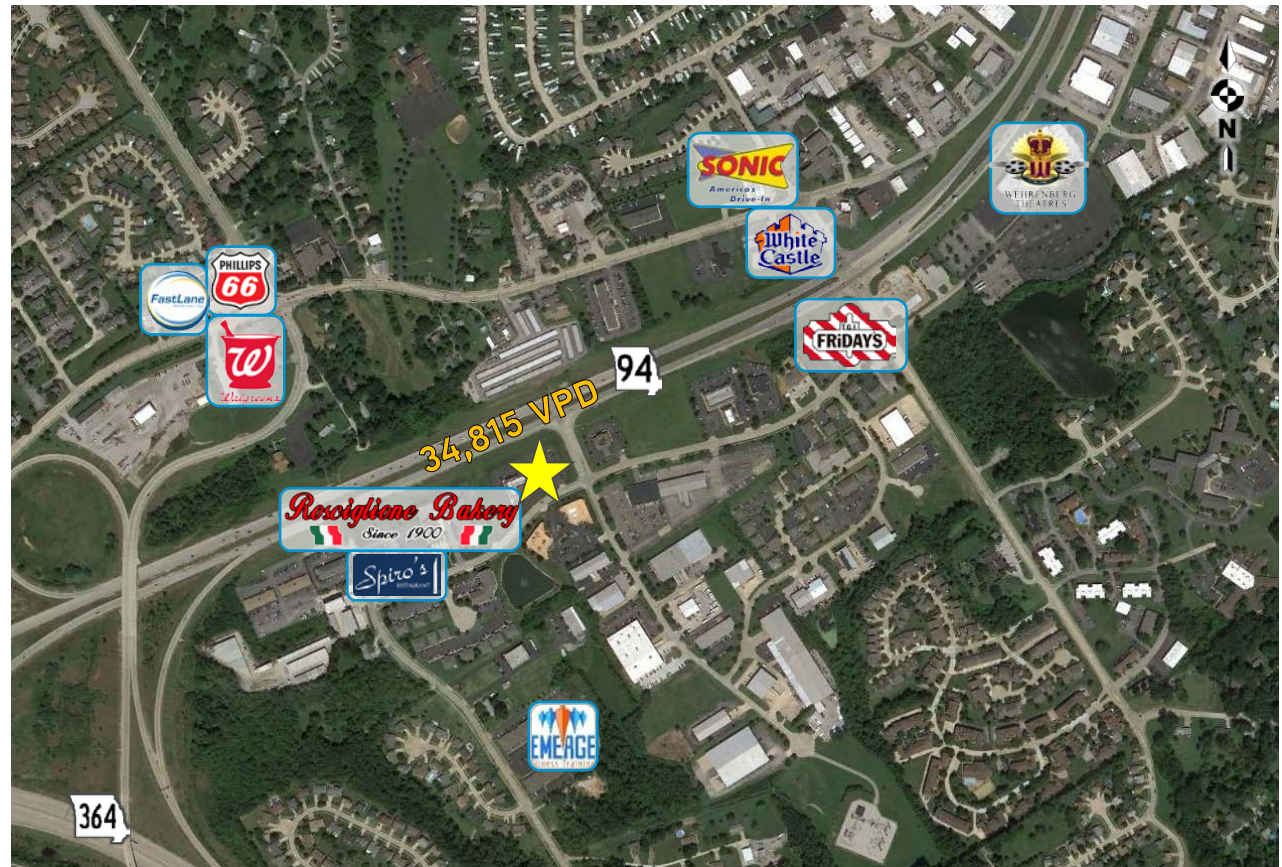

Contact Us

CHAD J. BURKEMPER
DIR +1 314 584 6279
MOB +1 636 579 9020
chad.burkemper@colliers.com

COLLIERS | ST. LOUIS
101 South Hanley Road, Suite 1400
St. Louis, MO 63105
www.colliers.com

Although all information furnished regarding property for sale, rental or financing is from sources deemed reliable, such information has not been verified, and no express representation is made nor is any to be implied as to the accuracy thereof, and it is submitted subject to errors, omissions, change of price, rental or other conditions, prior sale, lease or financing, or withdrawal without notice.