

FOR LEASE > RETAIL AVAILABILITY

FIVE & DIME BUILDING

3700 THIRD STREET | DETROIT, MICHIGAN



COMPLETE REDEVELOPMENT OF BUILDING WITH 2 NEW FLOORS

> PROPERTY HIGHLIGHTS

- 1,488 to 3,134 SF Spaces Available
- Immediate Area Includes: Wayne State University and Many Residential Buildings / Homes
- Walking Distance to M1/QLine Stop at MLK Jr. Boulevard & Woodward Avenue

> DEMOGRAPHICS

	1 MILE	3 MILE	5 MILE
POPULATION	18,318	98,436	271,528
AVG. INCOME	\$34,738	\$37,444	\$35,904
HOUSEHOLDS	9,676	46,279	110,439

COLLIERS INTERNATIONAL

2 Corporate Drive | Suite 300
Southfield, Michigan 48076

For More Information Call:

BENJI ROSENZWEIG

PHONE 248 540 1000 EXT 1866
EMAIL ben.rosenzweig@colliers.com



BEN HUBERT

PHONE 248 540 1000 EXT 1864
EMAIL ben.hubert@colliers.com



colliers.com/detroit



FOR LEASE > RETAIL AVAILABILITY

FIVE & DIME BUILDING

3700 THIRD STREET | DETROIT, MICHIGAN



> PROPERTY PHOTOS

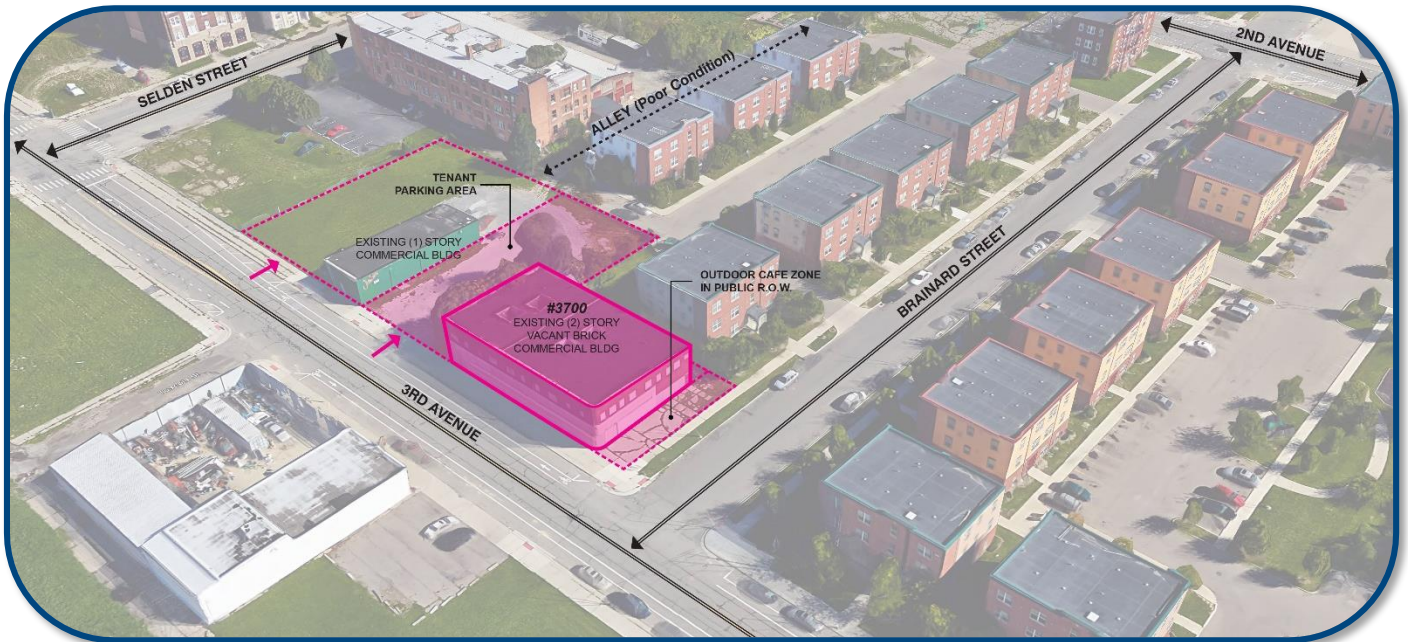

BENJI ROSENZWEIG

PHONE 248 540 1000 EXT 1866

EMAIL ben.rosenzweig@colliers.com



BEN HUBERT

PHONE 248 540 1000 EXT 1864

EMAIL ben.hubert@colliers.com

FOR LEASE > RETAIL AVAILABILITY

FIVE & DIME BUILDING

3700 THIRD STREET | DETROIT, MICHIGAN



> SITE PLAN

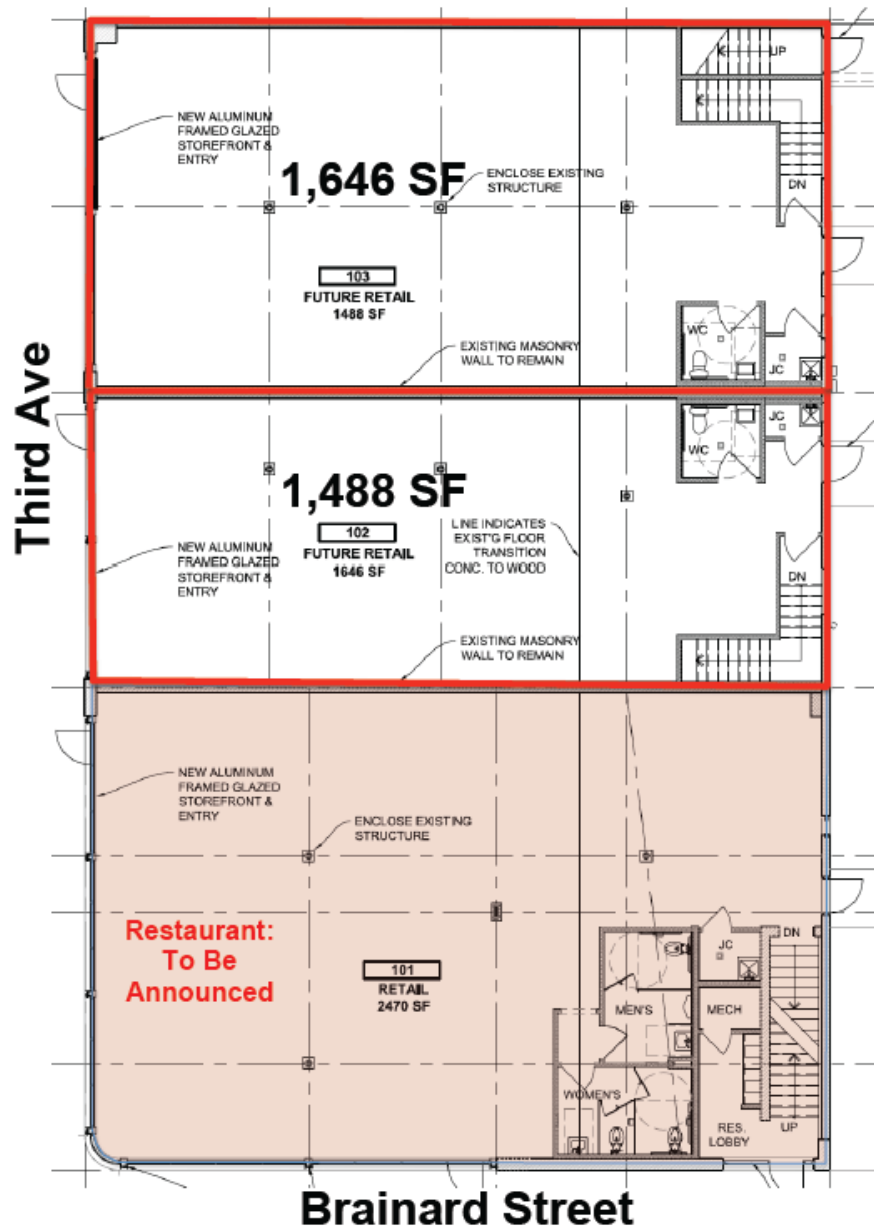

BENJI ROSENZWEIG

PHONE 248 540 1000 EXT 1866

EMAIL ben.rosenzweig@colliers.com



BEN HUBERT

PHONE 248 540 1000 EXT 1864

EMAIL ben.hubert@colliers.com

FOR LEASE > RETAIL AVAILABILITY

FIVE & DIME BUILDING

3700 THIRD STREET | DETROIT, MICHIGAN



> PROPERTY LOCATION

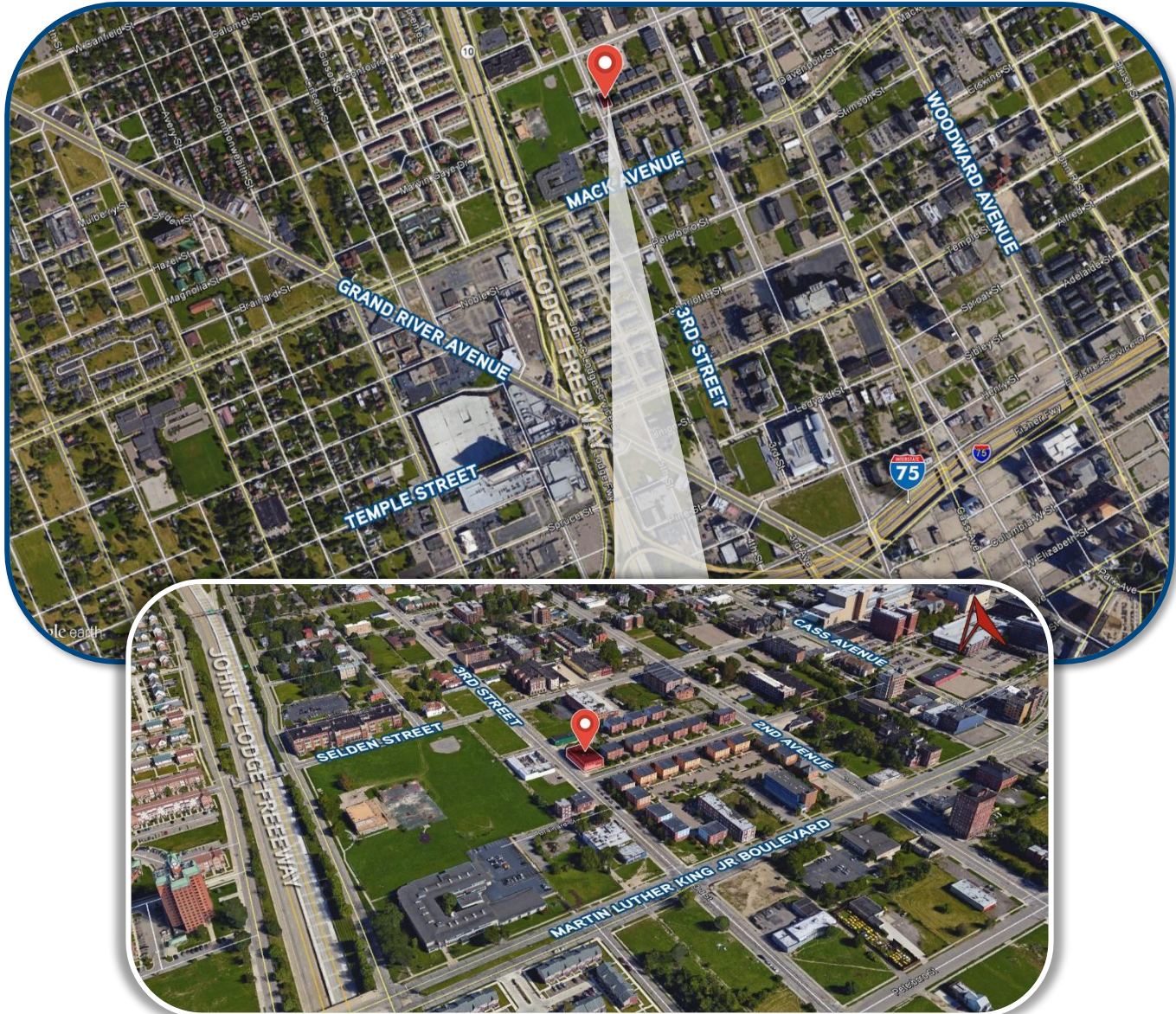

BENJI ROSENZWEIG

PHONE 248 540 1000 EXT 1866

EMAIL ben.rosenzweig@colliers.com



BEN HUBERT

PHONE 248 540 1000 EXT 1864

EMAIL ben.hubert@colliers.com

SUMMARY PROFILE

2000-2010 Census, 2016 Estimates with 2021 Projections

Calculated using Weighted Block Centroid from Block Groups



Lat/Lon: 42.3458/-83.0657

RS1

3700 3rd Ave

Detroit, MI 48201

1 mi radius

3 mi radius

5 mi radius

POPULATION	2016 Estimated Population	18,318	98,436	271,528
	2021 Projected Population	18,104	100,611	282,174
	2010 Census Population	17,941	99,773	281,358
	2000 Census Population	19,691	129,545	368,793
	Projected Annual Growth 2016 to 2021	-0.2%	0.4%	0.8%
	Historical Annual Growth 2000 to 2016	-0.4%	-1.5%	-1.6%
	2016 Median Age	36	37.1	35.4
HOUSEHOLDS	2016 Estimated Households	9,676	46,279	110,439
	2021 Projected Households	9,809	48,492	118,077
	2010 Census Households	8,975	44,858	109,550
	2000 Census Households	9,443	52,163	136,376
	Projected Annual Growth 2016 to 2021	0.3%	1.0%	1.4%
	Historical Annual Growth 2000 to 2016	0.2%	-0.7%	-1.2%
RACE AND ETHNICITY	2016 Estimated White	27.8%	22.1%	26.3%
	2016 Estimated Black or African American	61.3%	66.6%	58.8%
	2016 Estimated Asian or Pacific Islander	6.0%	2.2%	4.5%
	2016 Estimated American Indian or Native Alaskan	0.6%	0.5%	0.5%
	2016 Estimated Other Races	4.3%	8.6%	9.9%
	2016 Estimated Hispanic	3.3%	12.3%	14.6%
INCOME	2016 Estimated Average Household Income	\$34,738	\$37,444	\$35,904
	2016 Estimated Median Household Income	\$23,571	\$26,538	\$26,918
	2016 Estimated Per Capita Income	\$19,630	\$18,178	\$14,956
EDUCATION (AGE 25+)	2016 Estimated Elementary (Grade Level 0 to 8)	3.9%	6.9%	10.0%
	2016 Estimated Some High School (Grade Level 9 to 11)	14.1%	15.1%	17.1%
	2016 Estimated High School Graduate	25.7%	28.8%	30.9%
	2016 Estimated Some College	21.7%	22.9%	21.6%
	2016 Estimated Associates Degree Only	6.6%	6.4%	5.9%
	2016 Estimated Bachelors Degree Only	13.2%	9.8%	7.8%
	2016 Estimated Graduate Degree	14.8%	10.2%	6.6%
BUSINESS	2016 Estimated Total Businesses	2,292	8,832	13,112
	2016 Estimated Total Employees	50,124	175,347	224,624
	2016 Estimated Employee Population per Business	21.9	19.9	17.1
	2016 Estimated Residential Population per Business	8.0	11.1	20.7

This report was produced using data from private and government sources deemed to be reliable. The information herein is provided without representation or warranty.