

FOR LEASE > RETAIL SPACE

343 Sansome Street

FINANCIAL DISTRICT | SAN FRANCISCO

Colliers
INTERNATIONAL



ANNE MARIE CECCONI
LIC 01871852
415 288 7831
ann.cecconi@colliers.com

ALI MCEVOY
LIC 01930635
415 288 7853
ali.mcevoy@colliers.com

COLLIERS INTERNATIONAL
50 California Street Suite 1900
San Francisco, CA 94111
www.colliers.com

FOR LEASE > RETAIL SPACE

343 Sansome Street

FINANCIAL DISTRICT | SAN FRANCISCO, CA

Central Location

343 Sansome Street sits between California and Sacramento Streets, steps from San Francisco's iconic Transamerica building and is highly visible to the thousands of commuters traveling via MUNI and Golden Gate Transit on a daily basis.

The surrounding office buildings supply a daily captive audience of consumers while neighboring restaurants, including Wayfare Tavern, Wexlers, Bistro Burger, Mixt Greens, Perbacco, Barbacco, Pabu and The Ramen Bar, among others, draw discerning diners and an active lunch crowd.

The retail at 343 Sansome Street offers access to a daytime population of over 186,000 affluent professionals within a half-mile radius and a ground-floor retail identity in a Class-A building. Ideal tenants include business service providers and suppliers, fitness concepts, retailers and showrooms, among others.

LOCATION HIGHLIGHTS

- > Daily population of over 314,239 in a one mile radius
- > Highly visible and accessible to public transportation
- > Centrally located amongst restaurants, fitness operators and Fortune 500 offices
- > LEED Platinum certified building
- > Award-winning public rooftop garden with Bay views and WIFI



Building Amenity: Public Rooftop Garden



Business Services & Supplies



One block from Embarcadero Center - View of Ferry Building

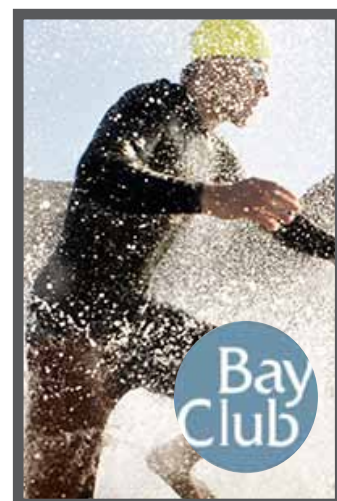

Fitness Concepts cater to Captive Professional Audience



SURROUNDING RESTAURANTS

- | | | | | |
|--------------------|------------------|----------------------|----------------|---------------------------------------|
| > Taverna Aventine | > Palio D'Asti | > Pabu/The Ramen Bar | > Slanted Door | > Crystal Jade COMING SOON |
| > Chirascuro | > Wexler's | > Michael Minna | > Coqueta | > Sens |
| > Bocadillos | > Wayfare Tavern | > Perbaco | > R&G Lounge | > Tosca |
| > Bask | > Kokari | > Barbaco | > One Market | > China Live/Eight Tables COMING SOON |
| > Bix | > Georges | > Tadich Grill | > Boulevard | > Boulette's Larder & Bouli Bar |



FOR LEASE > RETAIL SPACE

343 Sansome Street

FINANCIAL DISTRICT | SAN FRANCISCO, CA

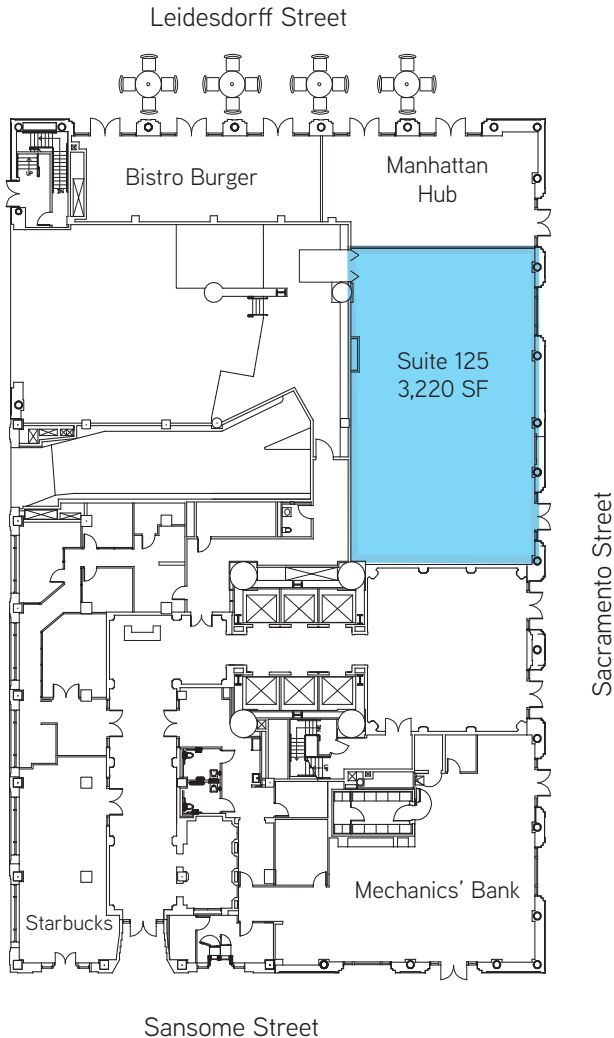

SUITE 125:

- > +/-3,220 SF
- > 67 Feet of frontage
- > High Ceilings
- > Open floor plan
- > Loading ramp
- > Perfect for fitness, retail, showroom or business services use



 CLARION PARTNERS

Contact:

ANNE MARIE CECCONI

DRE # 01871852

415 288 7831

annemarie.cecconi@colliers.com

ALI MCEVOY

DRE # 01930635

415 288 7853

ali.mcevoy@colliers.com

COLLIERS INTERNATIONAL
50 California Street Suite 1900
San Francisco, CA 94111

www.colliers.com

This marketing piece has been prepared by Colliers International for general information only. Information contained herein has been obtained from sources deemed reliable and no representation is made as to the accuracy thereof. Colliers International does not guarantee, warrant or represent that the information contained in this document is correct. Any interested party should undertake their own inquiries as to the accuracy of the information. Colliers International excludes unequivocally all inferred or implied terms, conditions and warranties arising out of this document and excludes all liability for loss and damages arising there from.

