

1,189 RSF Sublease Available



FOR SUBLEASE

Atlanta Financial Center
East Tower
3343 Peachtree Rd
Suite 730
Atlanta, GA 30326

DANY KOE

404 892 7248
dany.koe@colliers.com

Colliers
INTERNATIONAL

Lease Features

- › 1,189 RSF available for sublease
- › \$29.00/RSF Full Service
- › Term through December 31, 2018
- › Move-in ready within 30 days
- › Three private offices and conference room
- › Recently renovated with above building standard finishes

Building Features

- › Located in the heart of Buckhead on Peachtree Road in close proximity to MARTA and walkable amenities
- › Parking ratio 3.00/1,000 SF
- › Energy Star labeled building
- › City Club of Buckhead Dining & Conference Center, Athletic Club & Spa
- › Full service café, Highland Bakery and coffee shop
- › Auto salon, dry cleaner, hair salon, newsstand, florist
- › SunTrust branch bank and ATM

FOR SUBLEASE > 3343 Peachtree Road > Interior Photos



FOR SUBLEASE > 3343 Peachtree Road

Suite 730
1,189 RSF

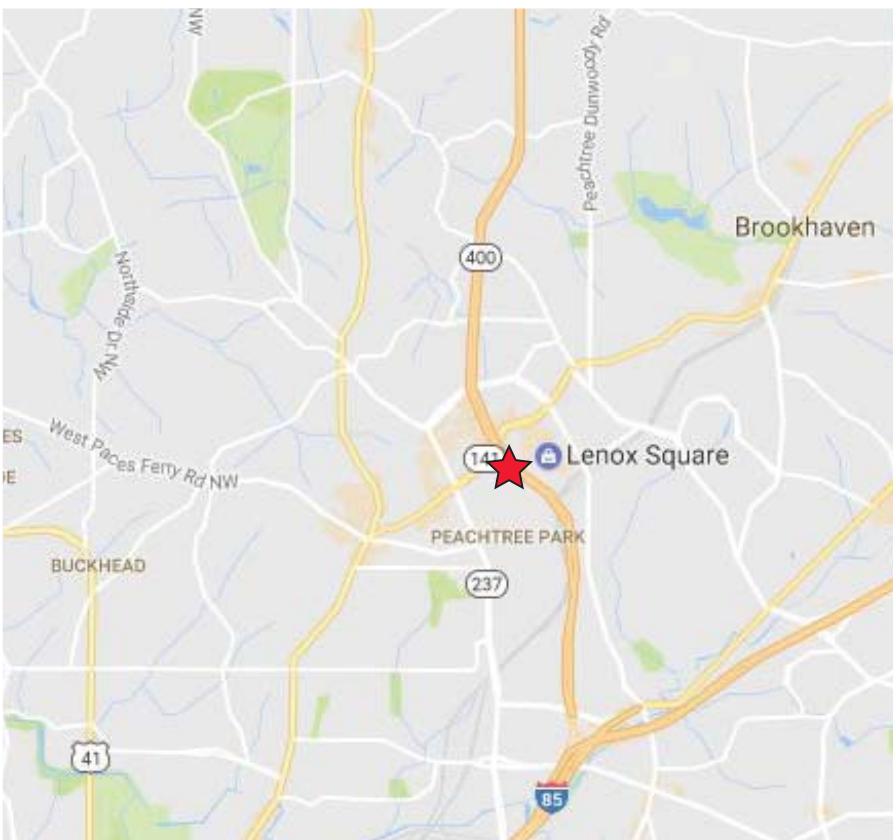
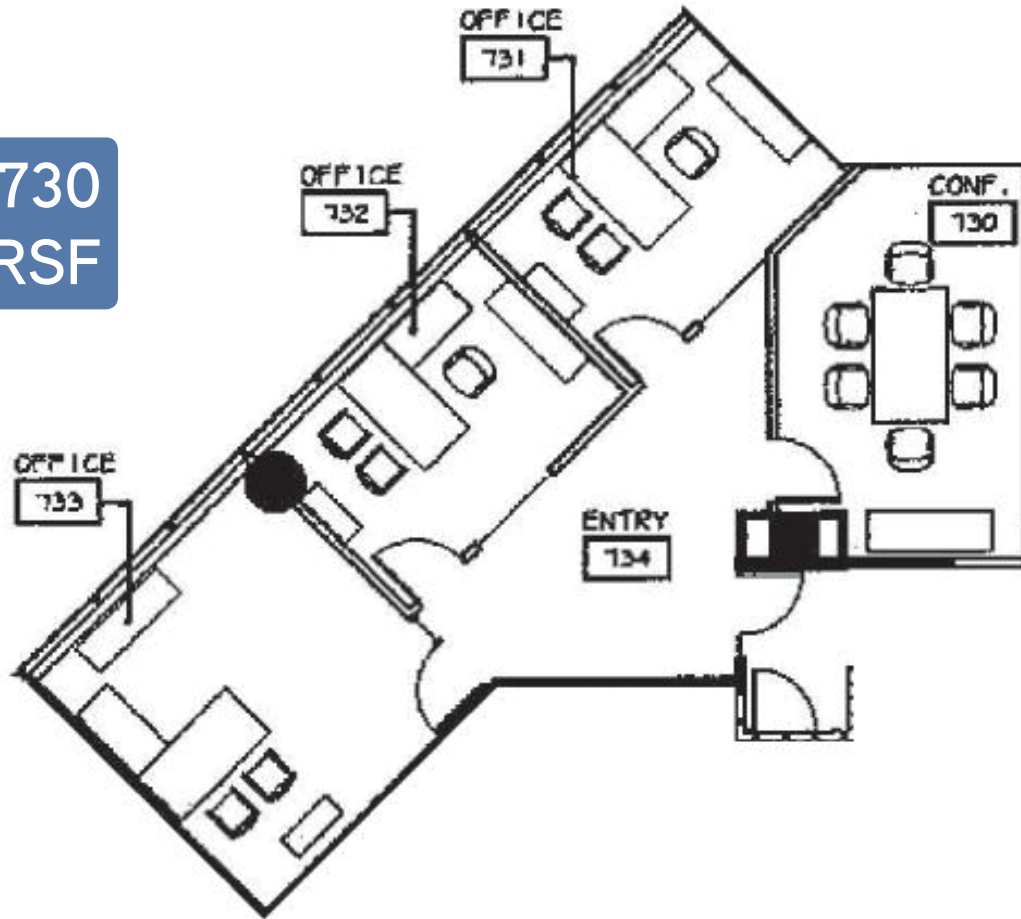

Contact Us

DANY KOE
404 892 7248
dany.koe@colliers.com

This document/email has been prepared by Colliers International for advertising and general information only. Colliers International makes no guarantees, representations or warranties of any kind, expressed or implied, regarding the information including, but not limited to, warranties of content, accuracy and reliability. Any interested party should undertake their own inquiries as to the accuracy of the information. Colliers International excludes unequivocally all inferred or implied terms, conditions and warranties arising out of this document and excludes all liability for loss and damages arising there from. This publication is the copyrighted property of Colliers International and /or its licensor(s). © 2016. All rights reserved. This communication is not intended to cause or induce breach of an existing listing agreement.



COLLIERS INTERNATIONAL
1230 Peachtree Street NE Suite 800
Atlanta, GA 30309-3574
+1 404 888 9000
www.colliers.com