

FOR SALE > INDUSTRIAL BUILDING

1707 East 123rd Terrace

OLATHE, KANSAS



BUILDING FEATURES

- > **TOTAL BUILDING AREA:** 9,750± SF
 - > **OFFICE:** 4,875± SF
- > **LAND AREA:** 1.08 acres
- > **OUTDOOR STORAGE:** Currently 3,000 SF fenced lot (expandable)
- > **YEAR BUILT:** 1988
- > **CONSTRUCTION TYPE:** pre-engineered metal; steel frame
- > **LOADING:** 1 dock-high; 2 drive-ins
- > **CLEAR HEIGHT:** 15' - 17'
- > **ELECTRICAL SERVICE:** 300a/240v/3 phase
- > **SPRINKLER SYSTEM:** none
- > **PARKING:** 30 spaces
- > **ZONING:** M-2
- > **SALE PRICE:** \$925,000
- > **TAXES:** \$18,417
- > **AVAILABILITY:** October 2018 as current owner is building a new facility

JOHN STAFFORD sior
+1 816 556 1184
KANSAS CITY, MO
john.stafford@colliers.com

COLLIERS INTERNATIONAL
4520 Main Street, Suite 1000
Kansas City, MO 64111
www.colliers.com

1700 EAST 123RD STREET



LOADING



ENTRY

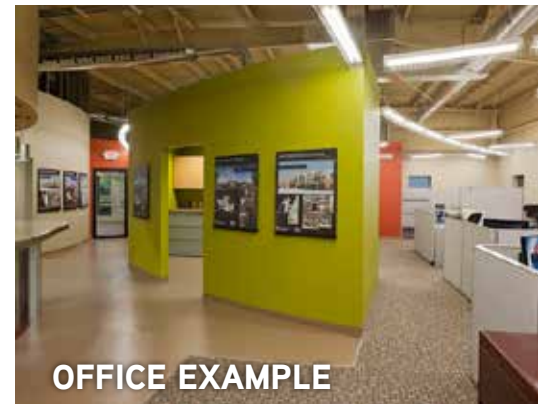

OFFICE EXAMPLE



CONFERENCE ROOM



BREAK ROOM



WAREHOUSE

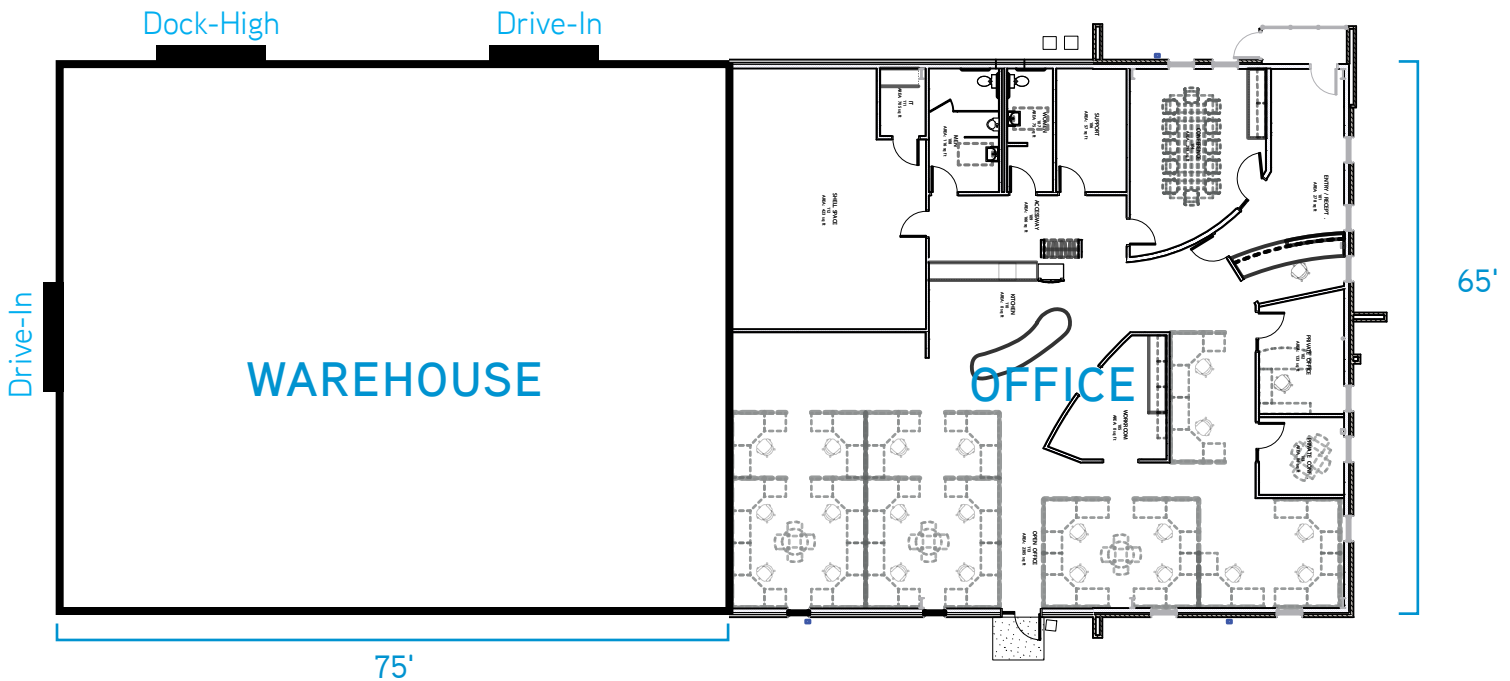

This document has been prepared by Colliers International for advertising and general information only. Colliers International makes no guarantees, representations or warranties of any kind, expressed or implied, regarding the information including, but not limited to, warranties of content, accuracy and reliability. Any interested party should undertake their own inquiries as to the accuracy of the information. Colliers International excludes unequivocally all inferred or implied terms, conditions and warranties arising out of this document and excludes all liability for loss and damages arising there from. This publication is the copyrighted property of Colliers International and/or its licensor(s). ©2017. All rights reserved.



1707 EAST 123RD TERRACE > AERIALS

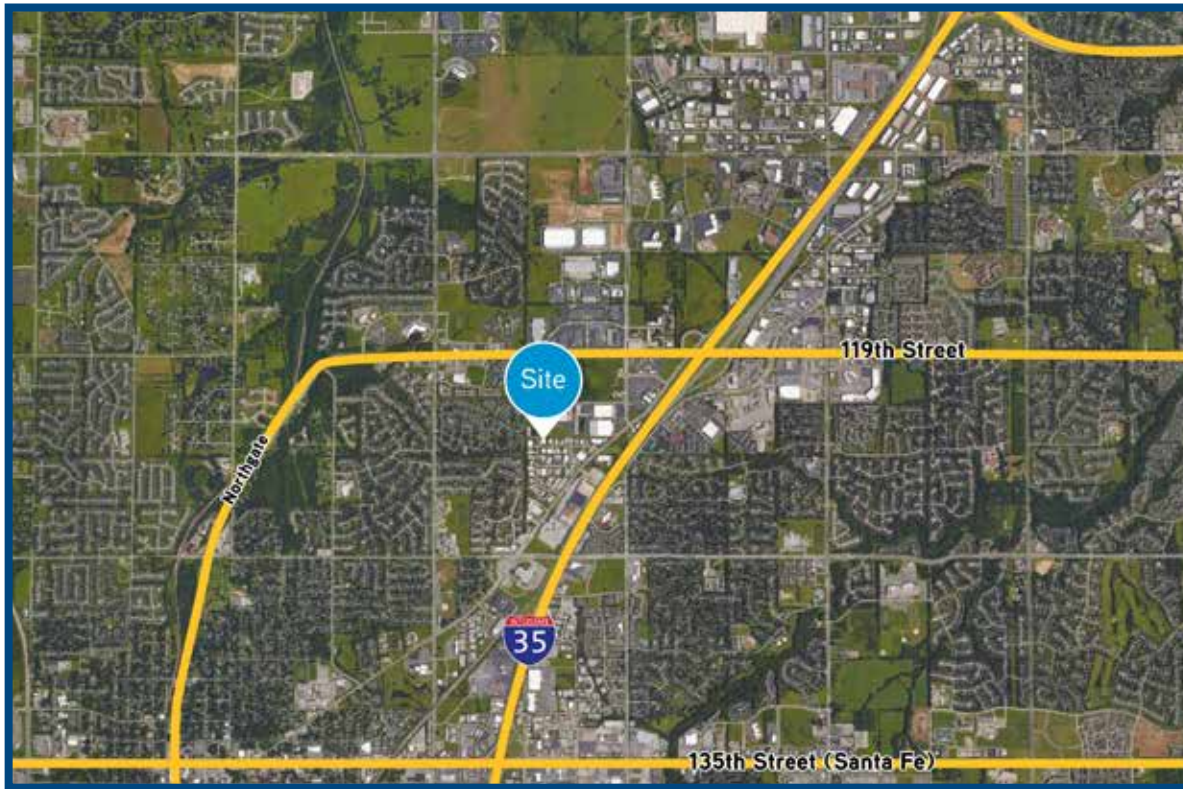

JOHN STAFFORD Sior, CCIM
+1 816 556 1184
KANSAS CITY, MO
john.stafford@colliers.com

COLLIERS INTERNATIONAL
4520 Main Street, Suite 1000
Kansas City, MO 64111
www.colliers.com

