

FOR LEASE > OFFICE SPACE



1600 Baltimore Avenue

KANSAS CITY, MO



Property Features

- > Approximately 3,903 RSF available on 1st floor
- > \$16.00 PSF, full-service lease rate
- > Tenant improvement allowance available
- > Located in the Freighthouse District
- > Renovated building
- > Within walking distance to the Sprint Center Arena
- > Great views of the Power & Light District
- > Private entry
- > Next to the Kauffman Center for the Performing Arts & the new Courtyard by Marriott

EVAN WARWICK
+1 816 556 1137
KANSAS CITY, MO
evan.warwick@colliers.com

COLLIERS INTERNATIONAL
4520 Main Street, Suite 1000
Kansas City, MO 64111
www.colliers.com

1600 Baltimore Avenue > First Floor Plan

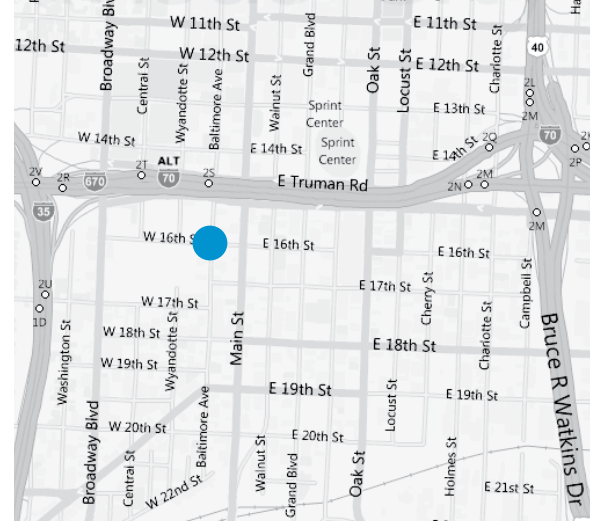
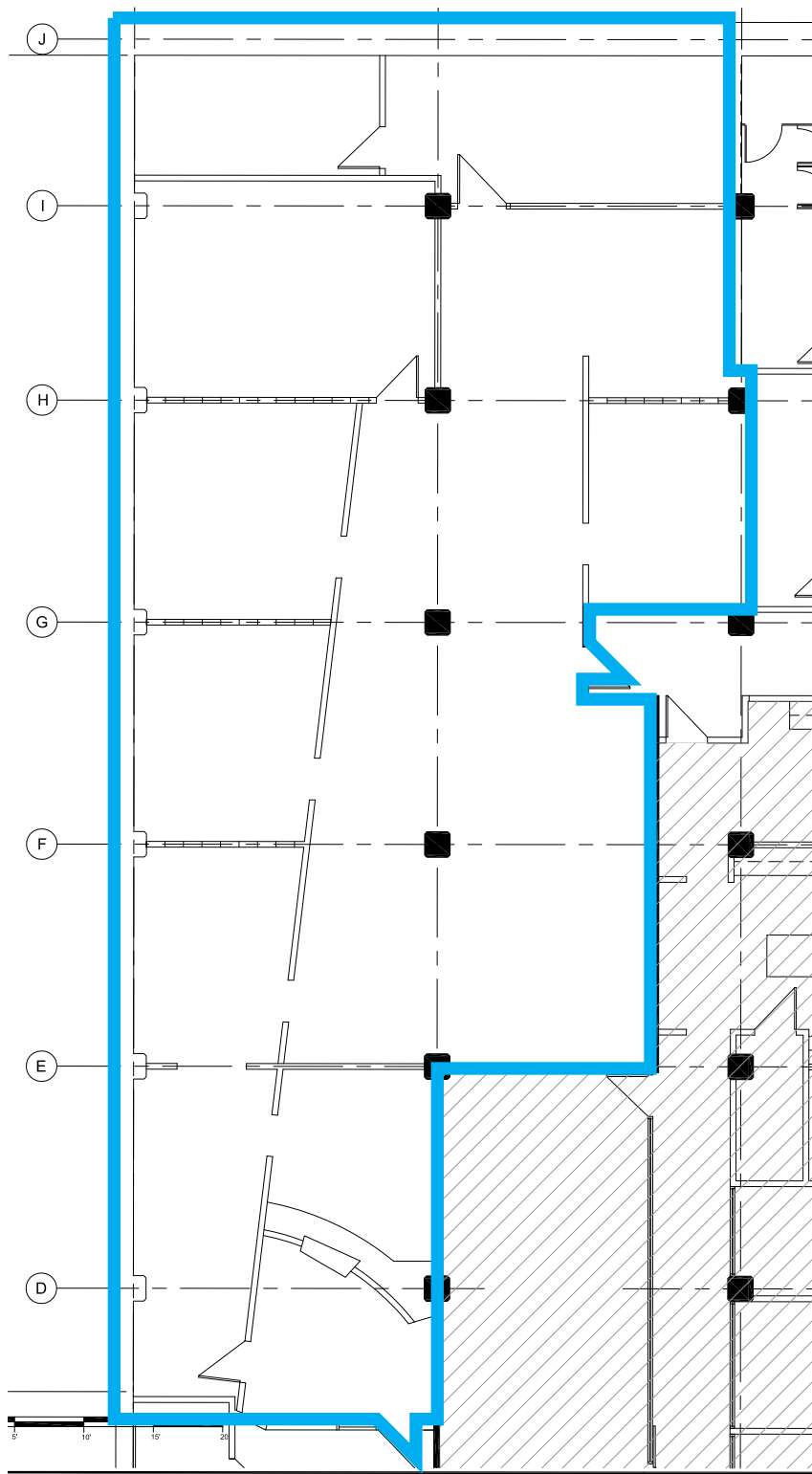

EVAN WARWICK
+1 816 556 1137
KANSAS CITY, MO
evan.warwick@colliers.com

COLLIERS INTERNATIONAL
4520 Main Street, Suite 1000
Kansas City, MO 64111
www.colliers.com