



Retail at **ENCORE COMMONS**



FOR MORE
INFORMATION

MELODY HOLLEY
DIRECT +1 404 574 1005
melody.holley@colliers.com



North Point **TRADE AREA**



ENCORE COMMONS

- Prime retail location in North Fulton County's major retail node; immediately adjacent to North Point Mall
- Part of Encore Commons, which is a 542K SF Class A office park and 17M SF of additional corporate office space within minutes of the center, plus 161,000+ daytime employees within a 5-mile radius
- Superior location offering convenient access to two exits of GA 400
- Surrounded by a dense population of 80,000+ with an average household income of \$103,000+ within a 3-mile radius

T R A F F I C C O U N T S



20,300 VPD

on Haynes Bridge Road at
North Point Parkway



21,200 VPD

on Mansell Road at North
Point Parkway



13,200 VPD

on Georgia State Route
400 at Haynes Bridge Road

D E M O G R A P H I C S (2 0 1 7)

	1-Mile	3-Mile	5-Mile
Total Population	2,465	80,699	199,644
Total Households	1,332	31,076	77,584
Average HH Income	\$82,400	\$106,732	\$126,826
# of Employees	12,153	97,624	154,006
# of Businesses	664	6,099	12,087

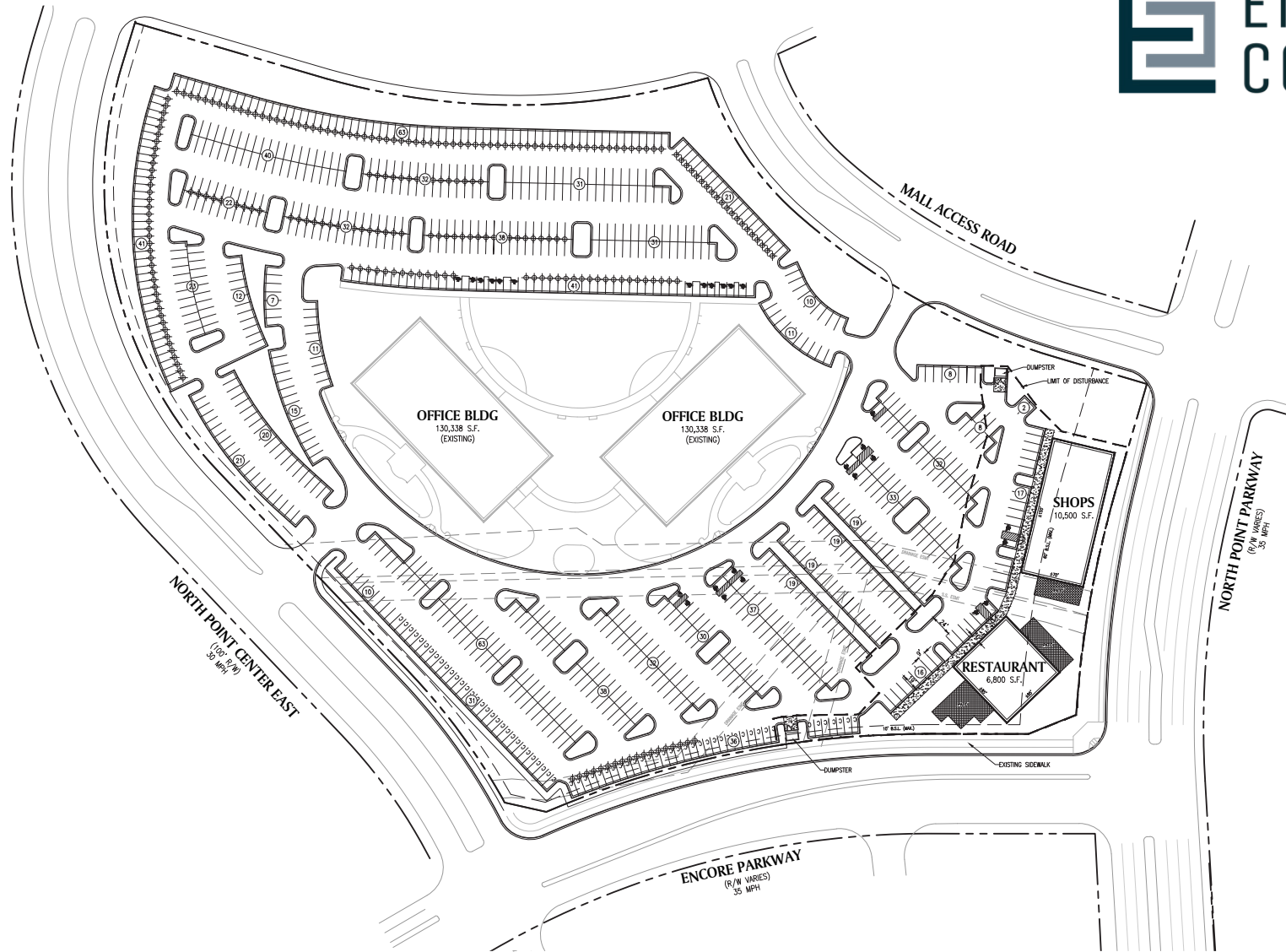

**CONTACT
YOUR BROKER**

MELODY HOLLEY
DIRECT +1 404 574 1005
melody.holley@colliers.com

This document has been prepared by Colliers International for advertising and general information only. Colliers International makes no guarantees, representations or warranties of any kind, expressed or implied, regarding the information including, but not limited to, warranties of content, accuracy and reliability. Any interested party should undertake their own inquiries as to the accuracy of the information. Colliers International excludes unequivocally all inferred or implied terms, conditions and warranties arising out of this document and excludes all liability for loss and damages arising therefrom. This publication is the copyrighted property of Colliers International and/or its licensor(s). ©2017. All rights reserved.