

FOR SALE > OFFICE / SHOWROOM / WAREHOUSE

514 E. LERDO HIGHWAY, SHAFTER, CA 93263



WESLEY MCDONALD
LICENSE NUMBER 01511739
661 631 3828
wesley.mcdonald@colliers.com

STEPHEN J. HAUPT, SIOR
LICENSE NUMBER 00838505
661 631 3812
stephen.haupt@colliers.com

COLLIERS INTERNATIONAL
10000 Stockdale Highway, Suite 103
Bakersfield, CA 93311
661 631 3800
www.colliers.com/bakersfield



OFFICE / SHOWROOM / WAREHOUSE PROPERTY INFORMATION

514 E. LERDO HIGHWAY, SHAFTER, CA 93263

The subject property is located at 514 E. Lerdo Highway, Shafter, on the northeastern corner of Mannel Avenue and E. Lerdo Highway.

AVAILABLE

Three (3) Industrial Buildings totaling 10,048 s.f.....**\$625,000.00**

DESCRIPTION

- › Three (3) Buildings
- › Total Building Size: 10,048 s.f.
- › Office Size: 1,240 s.f.
- › Showroom 3,072 s.f.
- › Warehouse Size: 5,736 s.f.
- › Canopy: 2,104 s.f.
- › Doors:
 - Two (2) 8' x 7'
 - One (1) 5' x 8'
 - One (1) 8' x 9'
 - One (1) 10' x 10'
 - One (1) 13' x 7'
- › Clear Height: 10' - 12'
- › Lot size: 1 acre
- › General Commercial (GC), City of Shafter
- › Water: City of Shafter
- › Sewer: North of the River Sanitation
- › Gas: Pacific Gas & Electric Co
- › Electric: Pacific Gas & Electric Co.



WESLEY MCDONALD
LICENSE NUMBER 01511739
661 631 3828
wesley.mcdonald@colliers.com

STEPHEN J. HAUPT, SIOR
LICENSE NUMBER 00838505
661 631 3812
stephen.haupt@colliers.com

COLLIERS INTERNATIONAL
10000 Stockdale Highway, Suite 102
Bakersfield, CA 93311
www.colliers.com/bakersfield



OFFICE / SHOWROOM / WAREHOUSE SITE PLAN

514 E. LERDO HIGHWAY, SHAFTER, CA 93263

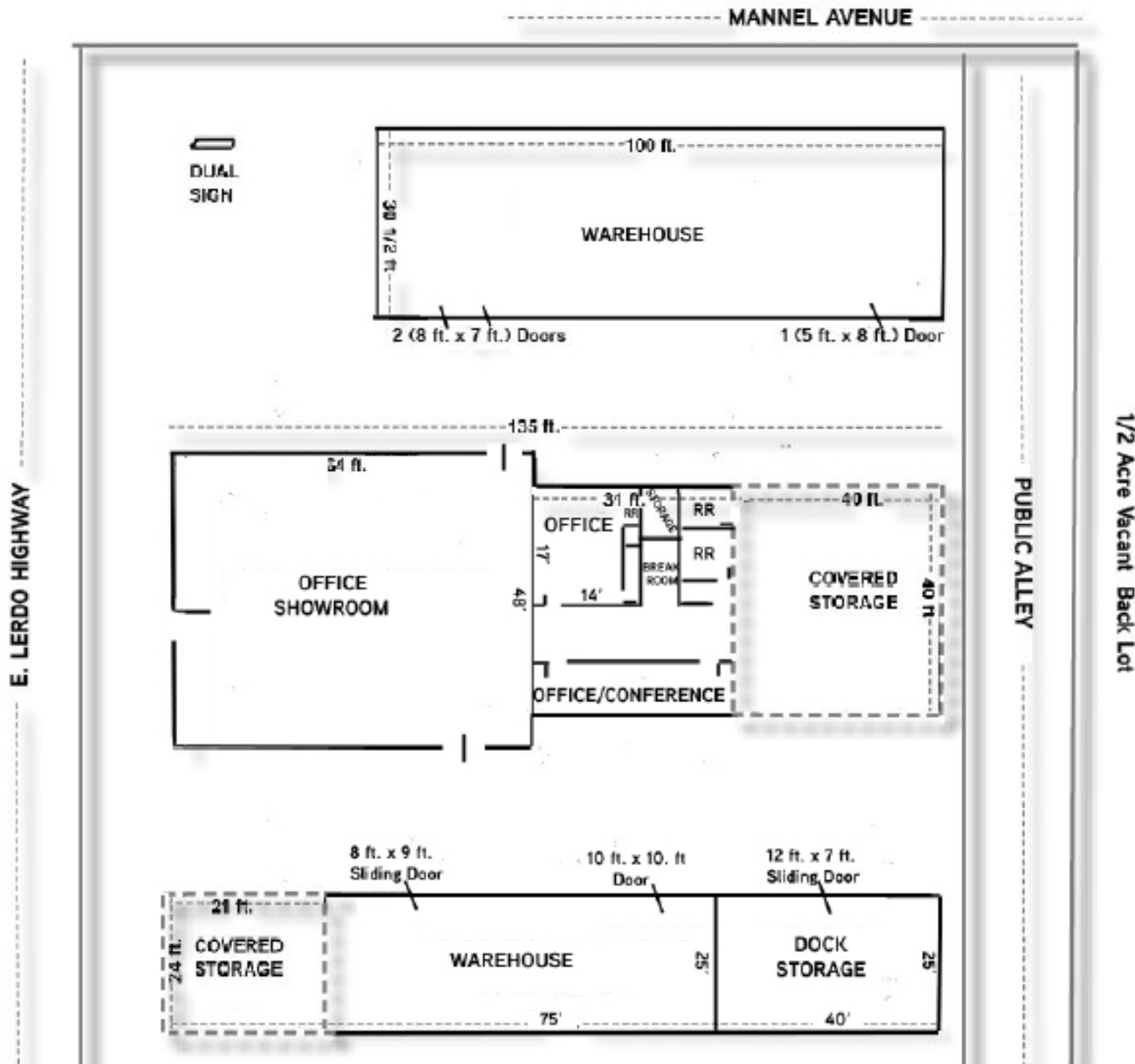

WESLEY MCDONALD
LICENSE NUMBER 01511739
661 631 3828
wesley.mcdonald@colliers.com

STEPHEN J. HAUPT, SIOR
LICENSE NUMBER 00838505
661 631 3812
stephen.haupt@colliers.com

COLLIERS INTERNATIONAL
10000 Stockdale Highway, Suite 102
Bakersfield, CA 93311
www.colliers.com/bakersfield



OFFICE / SHOWROOM / WAREHOUSE PHOTOS

514 E. LERDO HIGHWAY, SHAFTER, CA 93263



WESLEY MCDONALD
LICENSE NUMBER 01511739
661 631 3828
wesley.mcdonald@colliers.com

STEPHEN J. HAUPT, SIOR
LICENSE NUMBER 00838505
661 631 3812
stephen.haupt@colliers.com

COLLIERS INTERNATIONAL
10000 Stockdale Highway, Suite 102
Bakersfield, CA 93311
www.colliers.com/bakersfield



OFFICE / SHOWROOM / WAREHOUSE LOCATION MAP / AERIAL MAP

514 E. LERDO HIGHWAY, SHAFTER, CA 93263



DISCLOSURE: THE SOUTHWEST CORNER OF THE PROPERTY MAY BE IMPACTED BY THE HIGH SPEED RAIL PROJECT.

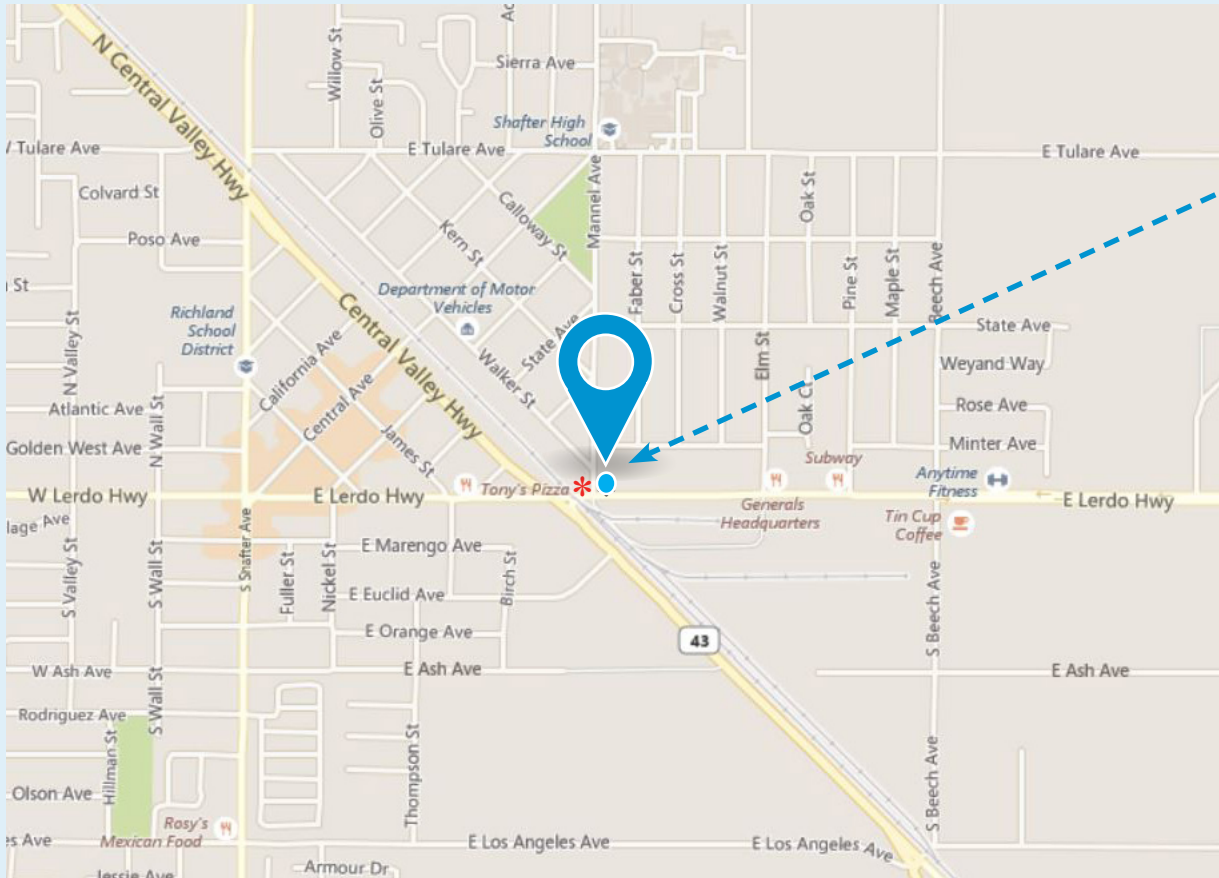

CONTACT US

AGENT: WESLEY MCDONALD
LICENSE NUMBER 01511739
SENIOR VICE FPRESIDENT I PRINCIPAL
CENTRAL CALIFORNIA
INDUSTRIAL PROPERTIES TEAM
661 631 3828

STEPHEN J. HAUPT, SIOR
LICENSE NUMBER 00838505
SENIOR VICE PRESIDENT I PRINCIPAL
CENTRAL CALIFORNIA
INDUSTRIAL PROPERTIES TEAM
661 631 3812
stephen.haupt@colliers.com

This document has been prepared by Colliers International for advertising and general information only. Colliers International makes no guarantees, representations or warranties of any kind, expressed or implied, regarding the information including, but not limited to, warranties of content, accuracy and reliability. Any interested party should undertake their own inquiries as to the accuracy of the information. Colliers International excludes unequivocally all inferred or implied terms, conditions and warranties arising out of this document and excludes all liability for loss and damages arising there from. This publication is the copyrighted property of Colliers International and/or its licensor(s). ©2017. All rights reserved.

COLLIERS INTERNATIONAL
10000 Stockdale Highway, Suite 102
Bakersfield, CA 93311
www.colliers.com/bakersfield

