

# Great Downtown Location

610 GOLD AVE SW, ALBUQUERQUE, NM 87102

Accelerating success.



## Great Downtown Location > Office Spaces

- > Lease Rate: \$14.00 SF/YR
- > Lease Type: Full Service
- > Available Space: Suite 101 +/- 267 RSF  
Suite 102 +/- 1,203 RSF  
Suite 202 +/- 695 RSF  
Suite 220 +/- 263 RSF
- > Zoning: SU-3

## Building Amenities

- > Convenient to all courthouses, Alvarado Transportation Station, and Downtown amenities
- > Free "D" ride only one block away
- > Charming 2-story office building with elevator
- > Several professional offices available
- > Lease rate includes all utilities, building security alarm, 5-night janitorial service, and shared conference room
- > Flexible terms
- > Parking available directly across the street - paid by tenant but the owner will arrange it
- > On-site property manager - the same local family that built it!

## Contact Us

SHONA MARTINEZ  
ASSOCIATE BROKER  
+1 505 492 9405  
ALBUQUERQUE, NM  
LICENSE #51234  
[shona.martinez@colliers.com](mailto:shona.martinez@colliers.com)

COLLIERS INTERNATIONAL | NM  
MAIN +1 505 883 7676  
5051 Journal Center Blvd. NE, Suite 200  
Albuquerque, NM 87109  
[www.colliers.com](http://www.colliers.com)



FOR LEASE > OFFICE SPACE



# Great Downtown Location

610 GOLD AVE SW, ALBUQUERQUE, NM 87102

Accelerating success.



## Contact Us

SHONA MARTINEZ  
ASSOCIATE BROKER  
+1 505 492 9405  
ALBUQUERQUE, NM  
LICENSE #51234  
[shona.martinez@colliers.com](mailto:shona.martinez@colliers.com)

COLLIERS INTERNATIONAL | NM | MAIN +1 505 883 7676 | 5051 Journal Center Blvd. NE, Ste. 200 | Albuquerque, NM 87109 | [www.colliers.com](http://www.colliers.com)

*Independently Owned and Operated* – The information contained herein was obtained from sources believed reliable; however, Colliers International makes no guarantees, warranties or representations as to the completeness or accuracy thereof. The presentation of this property is submitted subject to errors, omissions, change of price or conditions prior to sale or lease, or withdrawal without notice.

# Great Downtown Location

610 GOLD AVE SW, ALBUQUERQUE, NM 87102

Accelerating success.

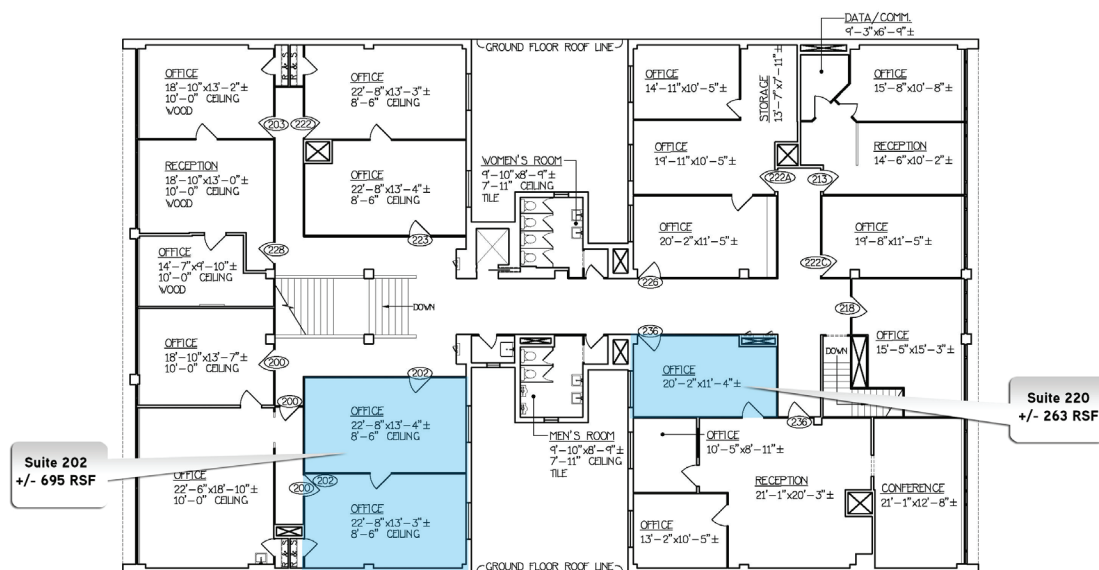

2nd Floor

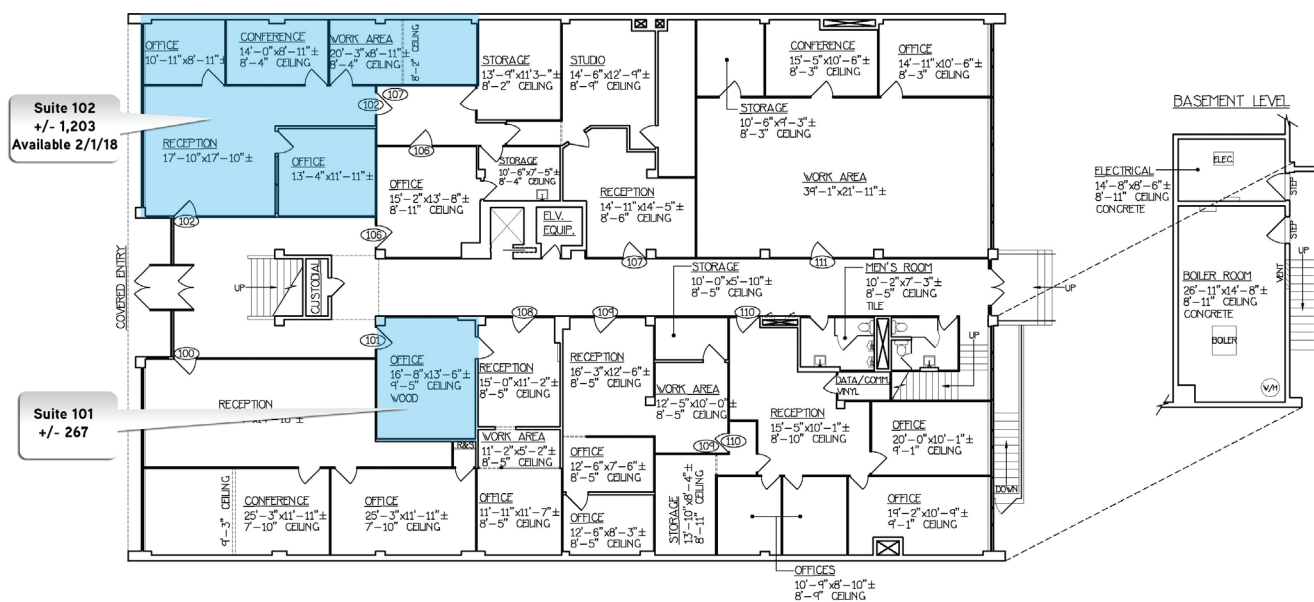

Ground Floor

## Contact Us

SHONA MARTINEZ  
ASSOCIATE BROKER  
+1 505 492 9405  
ALBUQUERQUE, NM  
LICENSE #51234  
[shona.martinez@colliers.com](mailto:shona.martinez@colliers.com)

COLLIERS INTERNATIONAL | NM | MAIN +1 505 883 7676 | 5051 Journal Center Blvd. NE, Ste. 200 | Albuquerque, NM 87109 | [www.colliers.com](http://www.colliers.com)