

FOR LEASE > OFFICE SPACE

Great Downtown Location

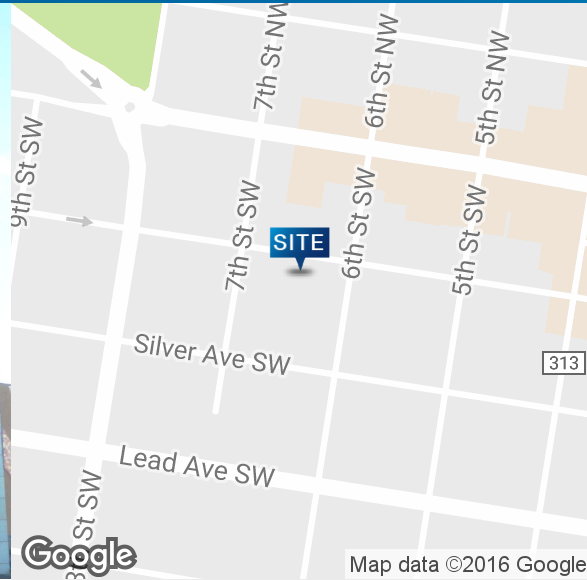

610 GOLD AVE SW, ALBUQUERQUE, NM 87102



Great Downtown Location

- > Lease Rate: \$13.50 SF/YR
- > Lease Type: Full Service
- > Available Space: Suite 101 ±267 RSF
Suite 202 ±695 RSF
Suite 236A ±263 RSF
- > Zoning: SU-3

Building Amenities

- > Convenient to all courthouses, Alvarado Transportation Station, and Downtown amenities
- > Free "D" ride only one block away
- > Charming 2-story office building with elevator
- > Several professional offices available
- > Lease rate includes all utilities, building security alarm, 5-night janitorial service, and shared conference room
- > Flexible terms
- > Parking available directly across the street - paid by tenant but the owner will arrange it
- > On-site property manager - the same local family that built it!

Contact Us

ANNE APICELLA
VICE PRESIDENT
+1 505.880.7059
NM LIC.#39337
ALBUQUERQUE, NM 87109
Anne.Apicella@colliers.com

Independently Owned And Operated

The information contained herein was obtained from sources believed reliable, however, Colliers International makes no guarantees, warranties, or representations as to the completeness or accuracy thereof. The presentation of this property is submitted subject to errors, omissions, change of price or conditions prior to sale or lease, or withdrawal without notice.

COLLIERS INTERNATIONAL
+1 505 883 7676 Main
5051 Journal Center Blvd NE, Suite 200
Albuquerque, NM 87109
colliers.com/en-us/newmexico

Great Downtown Location

610 GOLD AVE SW, ALBUQUERQUE, NM 87102



ANNE APICELLA
+1 505.880.7059
Anne.Apicella@colliers.com
NM Lic.#39337

COLLIERS NEW MEXICO
505.883.7676
5051 Journal Center Blvd NE, Suite 200
Albuquerque, NM 87109
colliers.com/en-us/newmexico

Great Downtown Location

610 GOLD AVE SW, ALBUQUERQUE, NM 87102

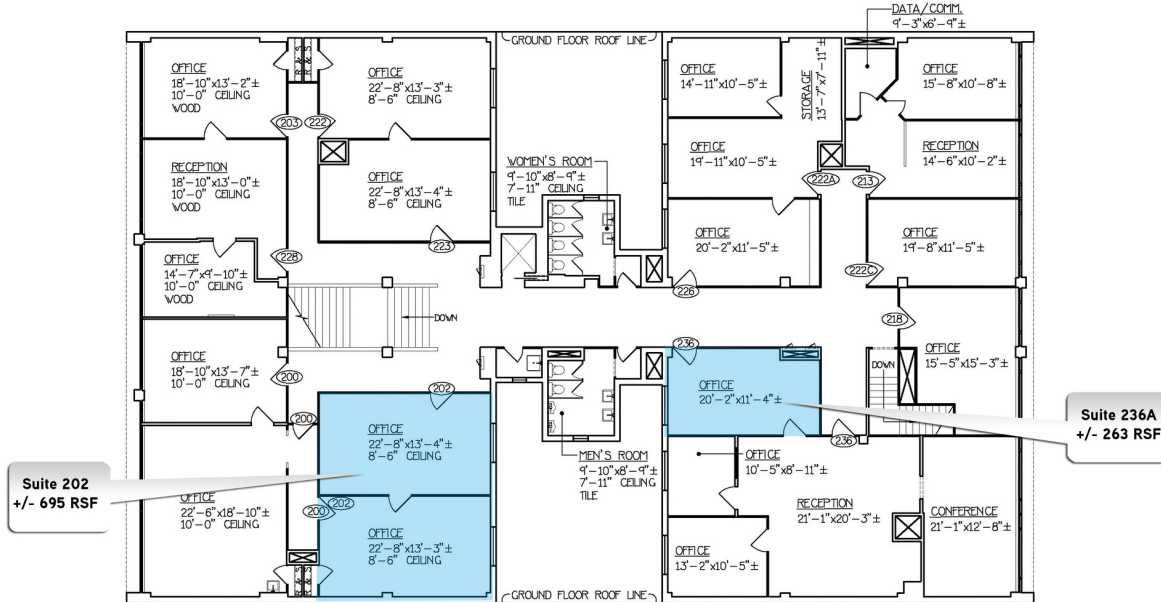

2nd Floor

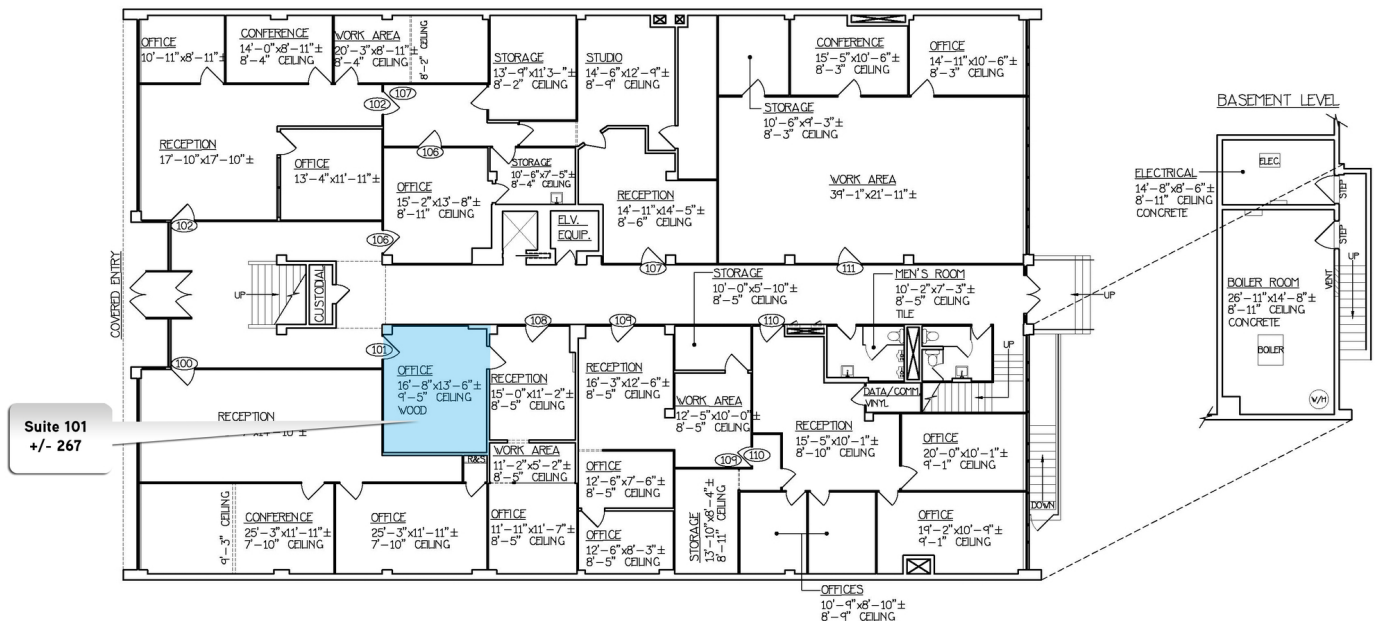

Ground Floor

ANNE APICELLA
+1 505.880.7059
Anne.Apicella@colliers.com
NM Lic.#39337

COLLIERS NEW MEXICO
505.883.7676
5051 Journal Center Blvd NE, Suite 200
Albuquerque, NM 87109
colliers.com/en-us/newmexico