

VIEW ONLINE 

colliers.com/cincinnati

Entire Office/Industrial Facility

For Sale or Lease

East Fork Business Center 910 Lila Avenue | Milford, Ohio 45150

FEATURES

- 122,603 Total SF Available
- 32,832 SF Office
- 89,768 SF Warehouse
- 27,760 SF High Bay - 25' Clear Height - clear span
- 63,400 SF Low Bay - 14' Clear Height - 33' x 30' column spacing - low bay
- 100% HVAC
- Updated T-5 Lighting
- 3 Docks; 3 Drive-In's
- 3 Phase, 480 Volt, 1600 Amps
- Good condition
- Good Ingress/Egress
- Close to many amenities
- Lease Rate: \$3.50/SF NNN + \$1.00/SF Operating Expenses

Sale Price:

\$3,936,000 (\$32.00/SF)

www.eastforkbusinesscenter.com

Contact us:

Ben Davis

Brokerage Associate
+1 513 562 2203
ben.davis@colliers.com

Norm Khoury, CCIM, SIOR

Brokerage Senior Vice President
+1 513 562 2271
norm.khoury@colliers.com

Matt Smyth

Brokerage Senior Associate
+1 513 562 2260
matt.smyth@colliers.com



Colliers International
425 Walnut Street | Suite 1200
Cincinnati, OH 45202
P: +1 513 721 4200

This document has been prepared by Colliers International for advertising and general information only. Colliers International makes no guarantees, representations or warranties of any kind, expressed or implied, regarding the information including, but not limited to, warranties of content, accuracy and reliability. Any interested party should undertake their own inquiries as to the accuracy of the information. Colliers International excludes unequivocally all inferred or implied terms, conditions and warranties arising out of this document and excludes all liability for loss and damages arising there from. This publication is the copyrighted property of Colliers International and/or its licensor(s). ©2018. All rights reserved.

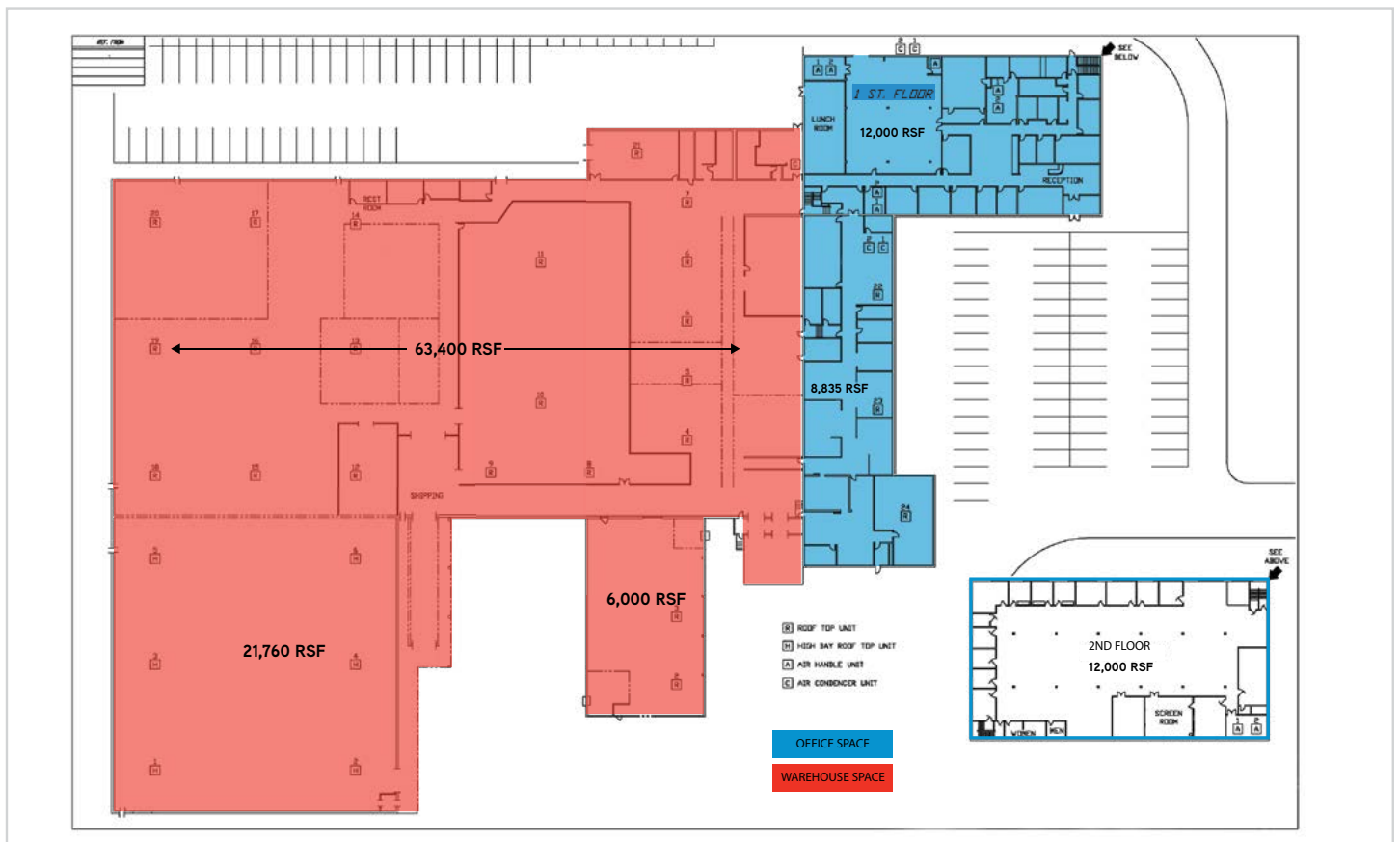

Ben Davis
Brokerage Associate
+1 513 562 2203
ben.davis@colliers.com

Norm Khoury, CCIM, SIOR
Brokerage Senior Vice President
+1 513 562 2271
norm.khoury@colliers.com

Matt Smyth
Brokerage Senior Associate
+1 513 562 2260
matt.smyth@colliers.com



Accelerating success.