

FOR SUBLEASE > 10<sup>TH</sup> FLOOR OFFICE SPACE

## WESTWOOD GATEWAY TOWERS

11150 Santa Monica Blvd

SUITE | 1050

AVAILABLE SF | 3,097 SF

TERM | Through April 30, 2019

ASKING LEASE RATE | \$4.35 PSF FSG

AVAILABILITY | Immediate

PARKING | 2.50 / 1,000 RSF

FURNITURE | Negotiable



### NATHAN PELLOW

*Executive Vice President*

License No. 01215721

213 532 3213

nathan.pellow@colliers.com

### JAMES ROBBINS

*Senior Associate*

License No. 01944738

213 532 3269

james.robbs@colliers.com

### PATRICK MOODY

*Associate*

License No. 02024230

213 327 3334

patrick.moody@colliers.com

### COLLIERS INTERNATIONAL

865 S Figueroa Street, Suite 3500

Los Angeles, CA 90017

213 627 1214

www.colliers.com



# space highlights and features

## FEATURES:

- > High end custom built space
- > EV charging stations/tenant car wash onsite
- > Abundant outdoor tenant common areas
- > Onsite gym and lockers with opportunity for private trainer and workout classes
- > Tenant lounge and onsite conferencing centers
- > Onsite shoe shine & repair
- > Onsite customer resource center
- > Restaurants and coffee shop
- > Easy access to 405 & 10 freeways
- > Close proximity to shopping & entertainment at Westwood Village & Westfield Mall



# I FLOOR PLAN

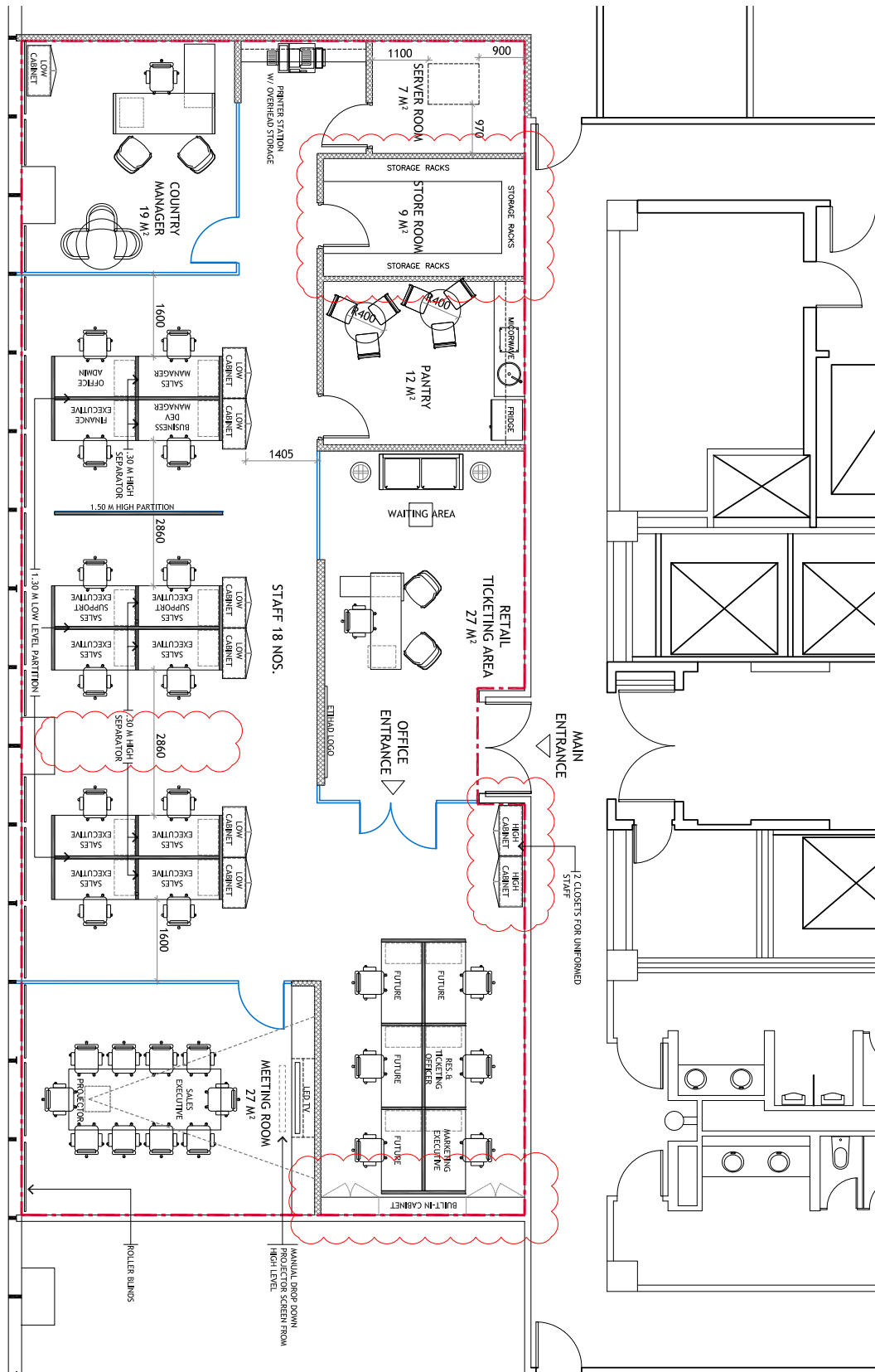

## NATHAN PELLOW

Executive Vice President

License No. 01215721

213 532 3213

nathan.pellow@colliers.com

## JAMES ROBBINS

Senior Associate

License No. 01944738

213 532 3269

james.robbins@colliers.com

## PATRICK MOODY

Associate

License No. 02024230

213 327 3334

patrick.moody@colliers.com

## COLLIERS INTERNATIONAL

865 S Figueroa Street, Suite 3500

Los Angeles, CA 90017

213 627 1214

www.colliers.com