

RETAIL FOR LEASE

Deer Creek Woods



NWC OF 135TH STREET & METCALF AVENUE, OVERLAND PARK, KS



WELCOME NEW TENANT: SCISSORS & SCOTCH

- Available suites from 960 - 3,532 SF
- 3,532 SF restaurant endcap with full kitchen, grease trap, and patio
- Average household income of \$147,037 and a daytime population of 90,228 in 3 miles
- Excellent access from 69 Highway, Metcalf Avenue and 135th Street
- Join fast-casual restaurants Pie Five Pizza, Noodles and Company, Chick-fil-A, Panda Express and Jimmy John's
- Anchored by Mazuma Credit Union Headquarters with 300 employees

Deer Creek Woods > Demographics

	1	3	5
Daytime Population	13,769	90,228	193,237
Population	12,308	95,614	194,864
Median HHI	\$86,276	\$117,631	\$110,556
Average HHI	\$87,914	\$147,037	\$137,597

KIMBERLY TRANBARGER
+1 816 556 1183
KANSAS CITY, MO
kimberly.tranbarger@colliers.com

COLLIERS INTERNATIONAL
4520 Main Street, Suite 1000
kansas City, mo 64111
www.colliers.com/kansascity

Deer Creek Woods

NWC 135TH STREET & METCALF AVENUE, OVERLAND PARK, KS

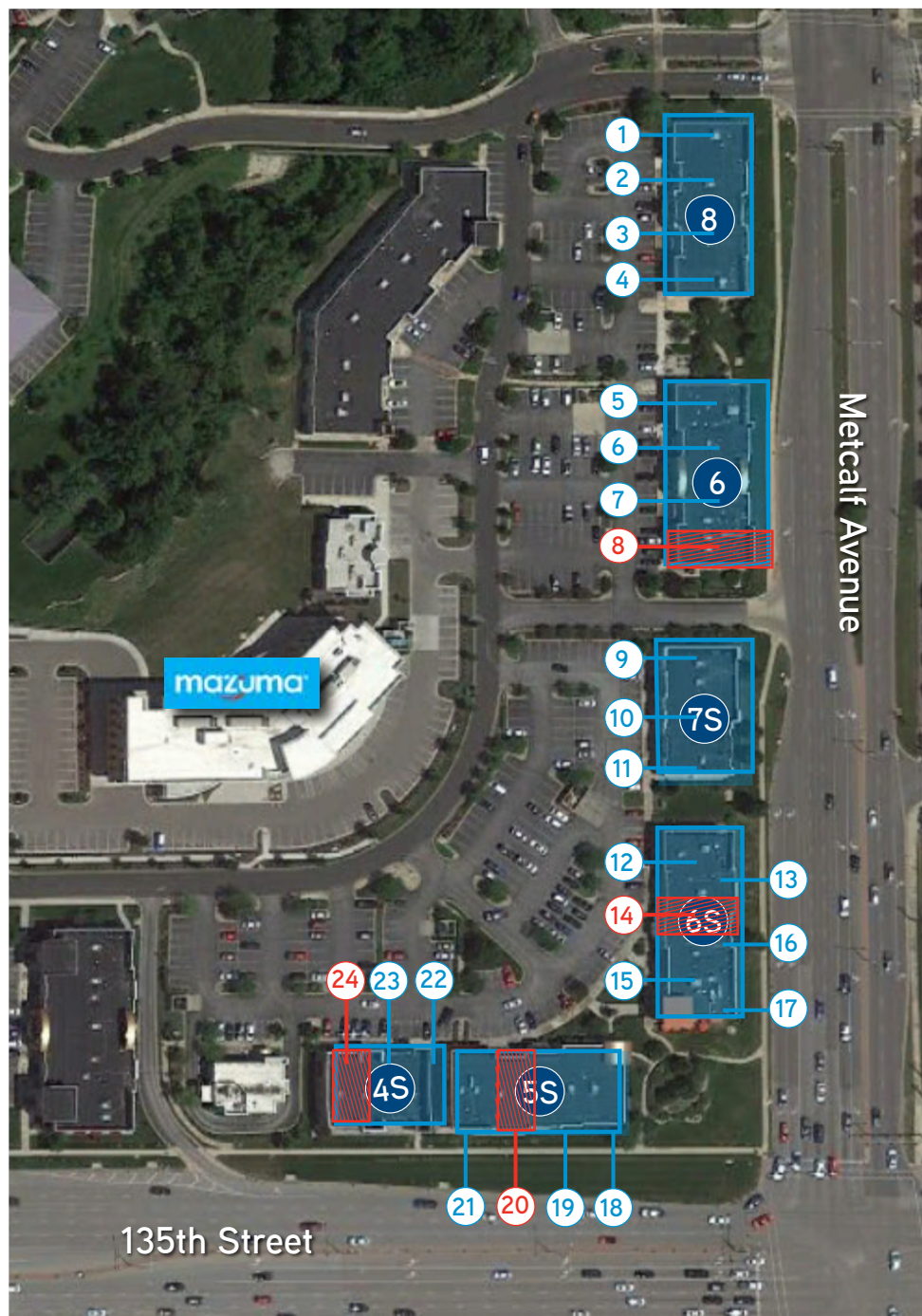

Building 8

- 1 RSVP Med Spa
- 2 California Closets
- 3 Amazing Lash Studio
- 4 Pacific Dental Services

Building 6

- 5 Pie Five Pizza
- 6 Fitness Together
- 7 Profile by Sanford
- 8 **Suite 13386 - 3,532 SF**
(restaurant with patio)

Building 7S

- 9 At The Beach
- 10 Batteries Plus Bulbs
- 11 Edible Arrangements

Building 6S

- 12 Nothing Bundt Cakes
- 13 Wireless Lifestyle
- 14 **Suite 13436 - 960 SF**
- 15 Smoothie King
- 16 CPR Cell Phone Repair
- 17 Noodles & Company

Building 5S

- 18 Scissors & Scotch
- 19 Complete Nutrition
- 20 **Suite 7108 - 1,642 SF**
- 21 Kolache Factory

Building 4S

- 22 One Stop Decorating Center
- 23 Jimmy John's
- 24 **Suite 7212 - 1,972 SF**

RETAIL FOR LEASE

Deer Creek Woods

NWC 135TH STREET & METCALF AVENUE, OVERLAND PARK, KS

Building 4S

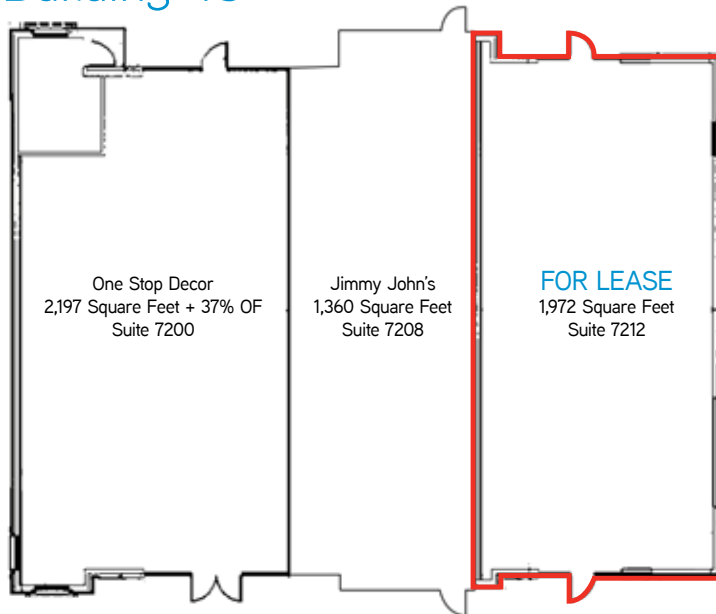

Building 5S

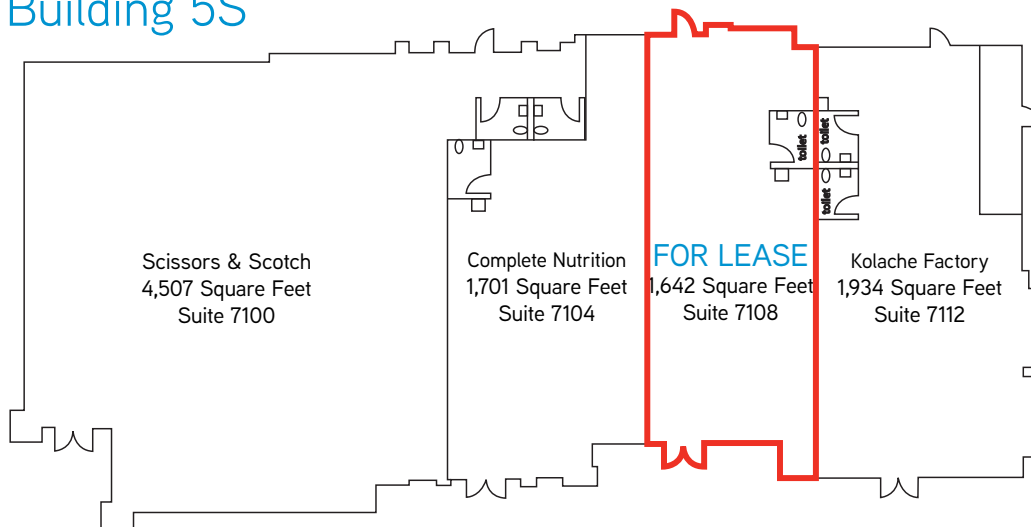

RETAIL FOR LEASE

Deer Creek Woods

NWC 135TH STREET & METCALF AVENUE, OVERLAND PARK, KS

Building 6

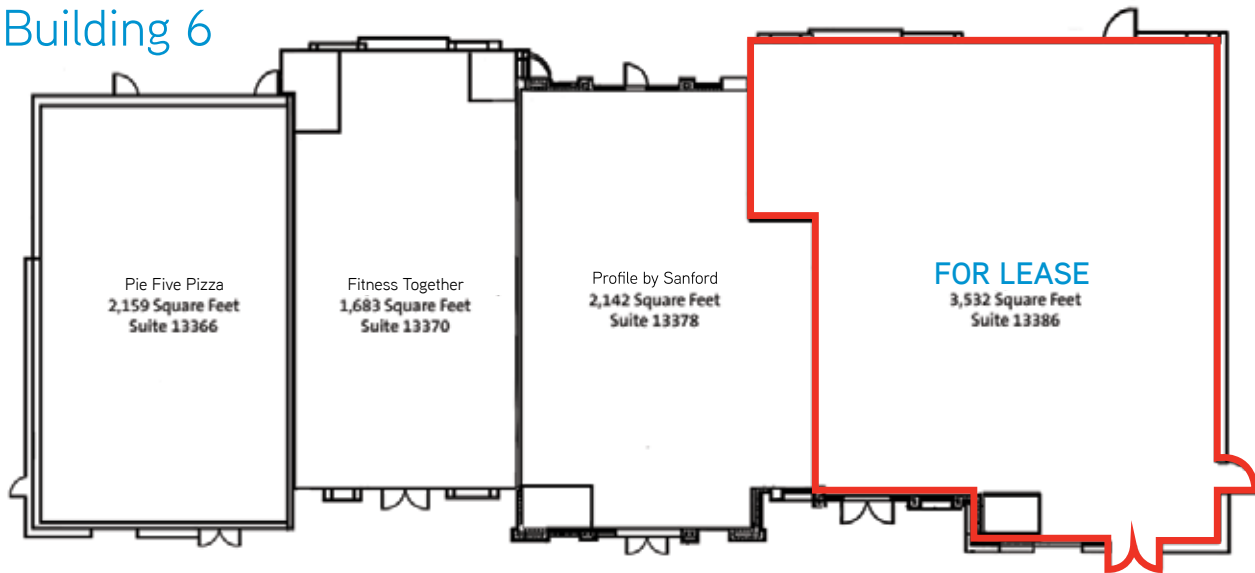

Building 6S

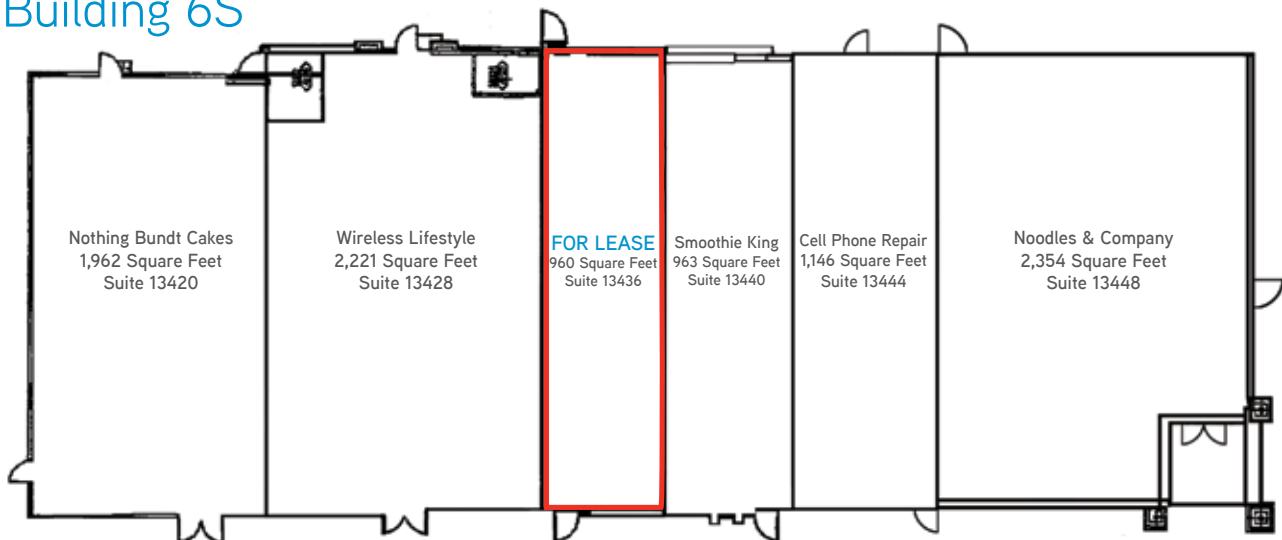

KIMBERLY TRANBARGER
+1 816 556 1183
KANSAS CITY, MO
kimberly.tranbarger@colliers.com

This document has been prepared by Colliers International for advertising and general information only. Colliers International makes no guarantees, representations or warranties of any kind, expressed or implied, regarding the information including, but not limited to, warranties of content, accuracy and reliability. Any interested party should undertake their own inquiries as to the accuracy of the information. Colliers International excludes unequivocally all inferred or implied terms, conditions and warranties arising out of this document and excludes all liability for loss and damages arising there from. This publication is the copyrighted property of Colliers International and/or its licensor(s). © 2018. All rights reserved.

