

FOR LEASE | OFFICE



# Corporate Office Campus

6735 SOUTHPOINT DRIVE S. | JACKSONVILLE | FL 32216

5,000± SF to 116,570± SF Available

SITE & INTERIOR COMMON AREA RENOVATIONS  
SCHEDULED FOR COMPLETION 3<sup>RD</sup> QTR. 2018



# Corporate Office Campus

6735 SOUTHPOINT DRIVE S. | JACKSONVILLE | FL 32216

## Premier Class A Building

**6735 Southpoint Drive** building is located in the most sought after submarket in Jacksonville. Large block of space available in the Jacksonville market totaling **up to 116,570 Gross SF**. Building is ideal for users who are looking for a corporate office park environment.

### 6735 Southpoint Drive: 4 Story 116,570± SF Available

1st Floor	5,000 SF - 32,170 SF	Full Floor
2nd Floor	33,696 SF	Full Floor
3rd Floor	34,704 SF	Full Floor
4th Floor	16,000 SF	Partial Floor

- › Class A Southside Submarket
- › Close to I-95 & Butler Blvd.
- › Numerous restaurants and hotels nearby
- › 5.2 miles from the St. Johns Town Center
- › 15 minutes to Downtown Jacksonville
- › Campus environment including a fitness center and on-site cafe
- › Mission critical facility
- › 1,500 KVA emergency generator
- › Space available now
- › Numerous upgrades in progress

**\$22.00/SF Full Service**

6735 SOUTHPOINT DRIVE



6737 SOUTHPOINT DRIVE

**LEASED**



# 6735 Southpoint Drive

## Floor Plans



FOURTH FLOOR



THIRD FLOOR

## Building Specifications

- › BUILDING SIZE: 135,404 SF
- › AVAILABLE SF: 116,570
- › FLOORS: 4
- › YEAR BUILT: 1992
- › ZONING: IBP
- › PARKING: 5.6/1000
- › BACK-UP GENERATOR: 1,500 KVA diesel generator provides emergency power for total building load to both buildings
- › Fitness Center
- › Café



# 6735 Southpoint Drive

## Floor Plans

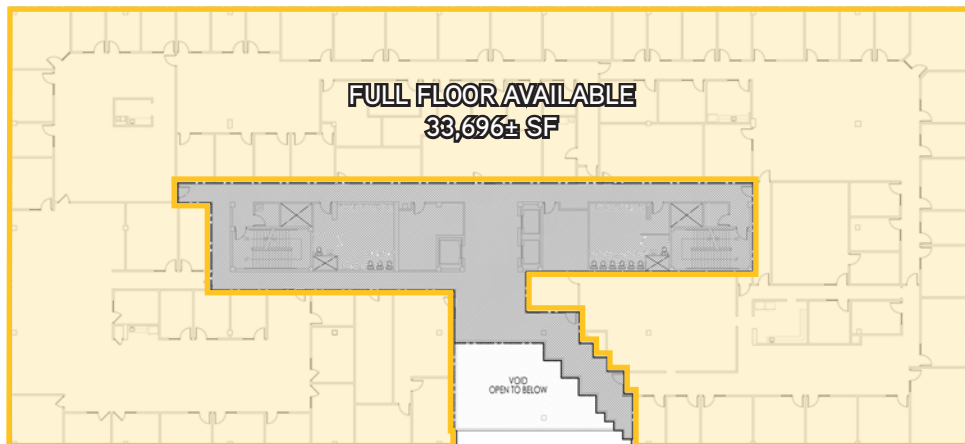

SECOND FLOOR



FIRST FLOOR

## Building Specifications

- › BUILDING SIZE: 135,404 SF
- › AVAILABLE SF: 116,570
- › FLOORS: 4
- › YEAR BUILT: 1992
- › ZONING: IBP
- › PARKING: 5.6/1000
- › BACK-UP GENERATOR: 1,500 KVA diesel generator provides emergency power for total building load to both buildings
- › Fitness Center
- › Café

FOR LEASE | OFFICE  
6735 SOUTHPOINT DRIVE S. | JACKSONVILLE | FL 32216



# 6735 Southpoint Drive

## Exterior Renderings

---



# 6735 Southpoint Drive

## Interior Renderings





FOR LEASE | OFFICE



# Property Aerial

6735 SOUTHPOINT DRIVE S. | JACKSONVILLE | FL 32216

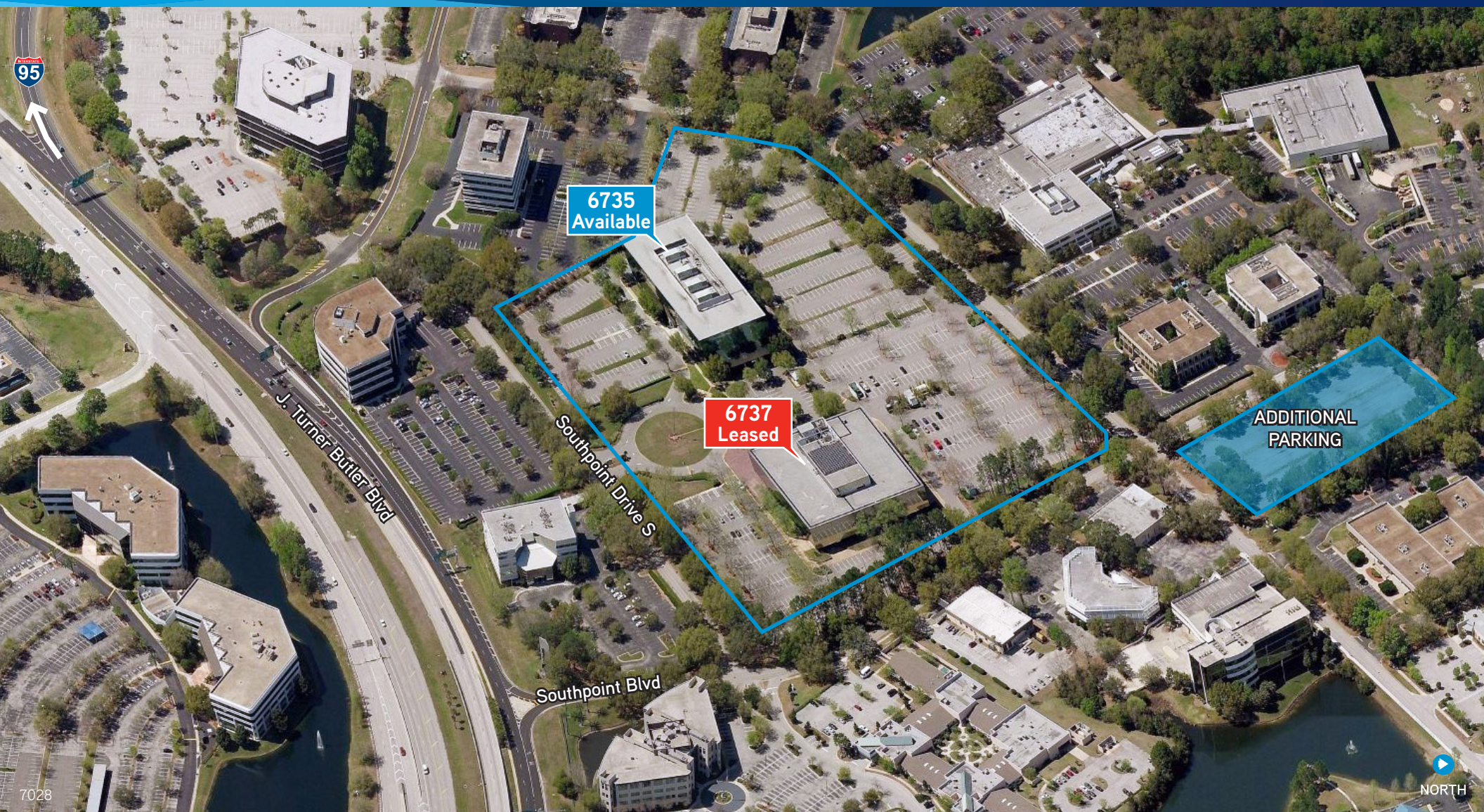



FOR LEASE | OFFICE



# Site Plan

6735 SOUTHPOINT DRIVE S. | JACKSONVILLE | FL 32216

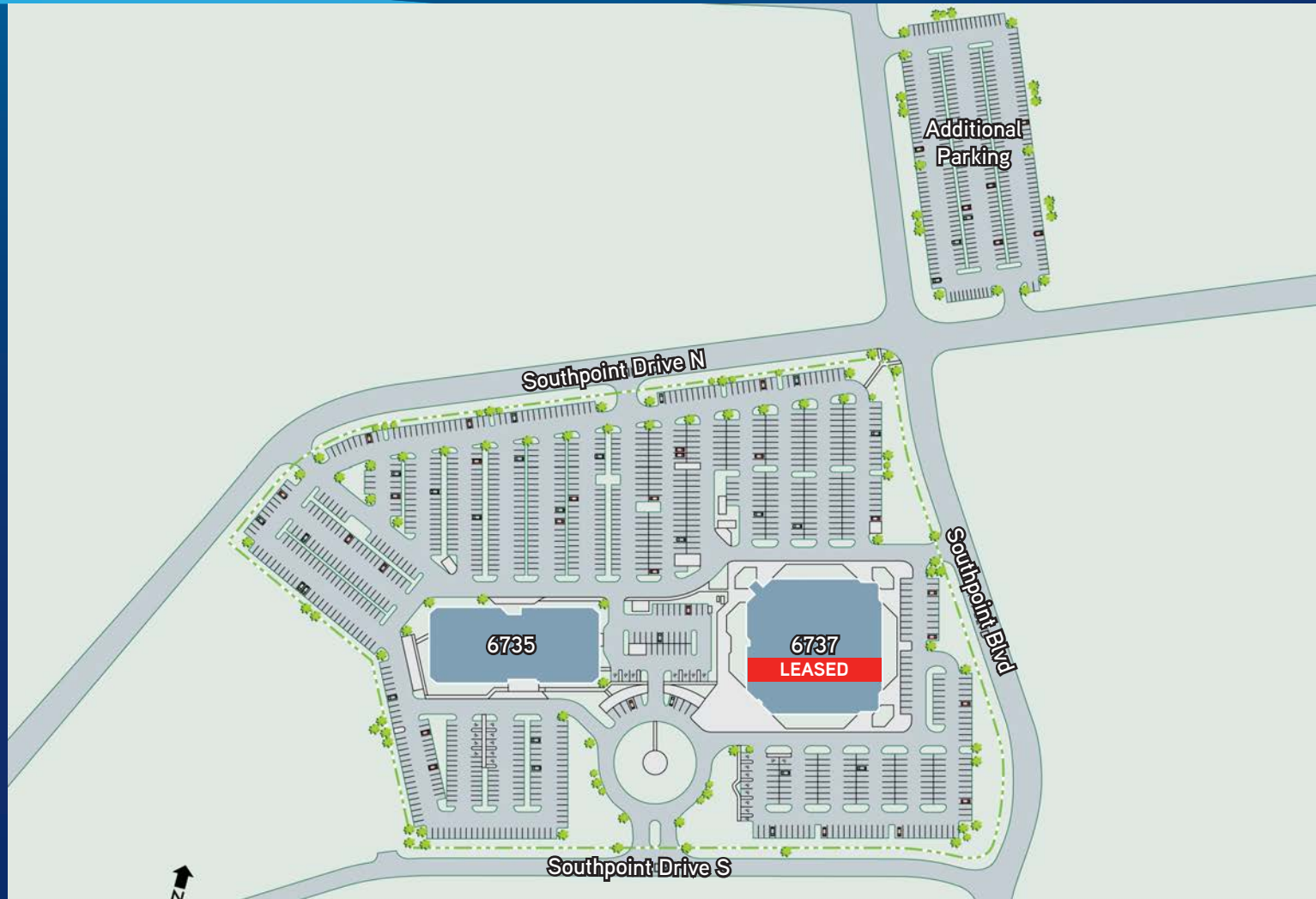



FOR LEASE | OFFICE



# Corporate Office Campus

6735 SOUTHPOINT DRIVE S. | JACKSONVILLE | FL 32216

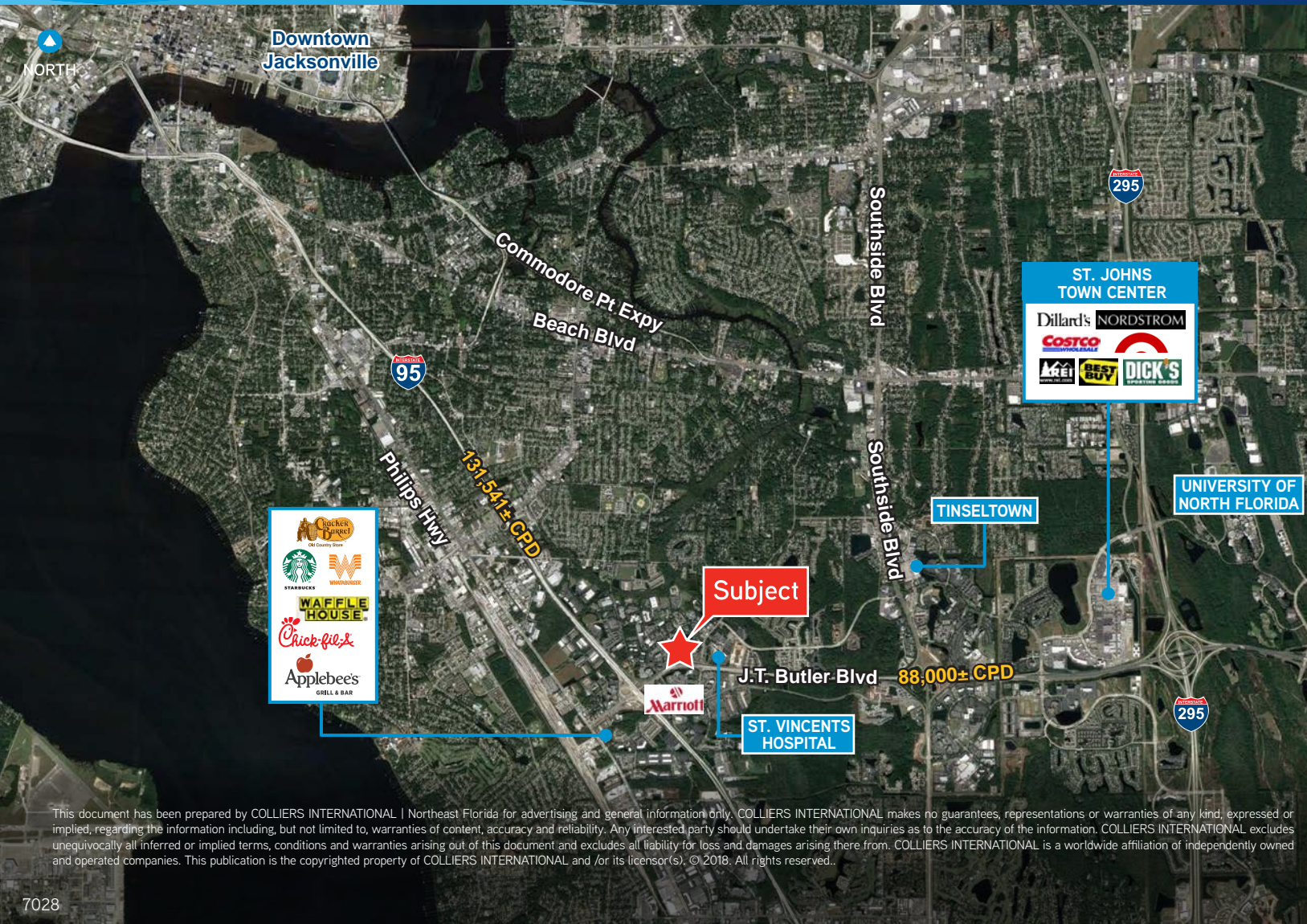

## Contact Us:

**CHUCK DIEBEL**

Executive Vice President

+1 904 861 1112

[chuck.diebel@colliers.com](mailto:chuck.diebel@colliers.com)

**ROBERT W. SELTON, III**

CEO

+1 904 861 1111

[robert.selton@colliers.com](mailto:robert.selton@colliers.com)

**COLLIERS INTERNATIONAL  
NORTHEAST FLORIDA**

50 N. Laura St, Suite 1725

Jacksonville, FL 32202

[www.colliers.com/jacksonville](http://www.colliers.com/jacksonville)

This document has been prepared by COLLIERS INTERNATIONAL | Northeast Florida for advertising and general information only. COLLIERS INTERNATIONAL makes no guarantees, representations or warranties of any kind, expressed or implied, regarding the information including, but not limited to, warranties of content, accuracy and reliability. Any interested party should undertake their own inquiries as to the accuracy of the information. COLLIERS INTERNATIONAL excludes unequivocally all inferred or implied terms, conditions and warranties arising out of this document and excludes all liability for loss and damages arising therefrom. COLLIERS INTERNATIONAL is a worldwide affiliation of independently owned and operated companies. This publication is the copyrighted property of COLLIERS INTERNATIONAL and /or its licensor(s). © 2018. All rights reserved.