

AVAILABLE > INDUSTRIAL SPACE > ±150,000 SF



995 Old York Road

CHESTER, SOUTH CAROLINA 29706



Property Information

| | | | |
|------------------------|---|---------------------------|--------------------------------------|
| Location: | 995 Old York Road Chester, South Carolina 29706 | Interstate Access: | I-77: 9.82 Miles |
| Building Area: | ±225,000 SF TOTAL ±7,901 SF Office Space | Truck Docks: | 8 Dock High Doors & 2 Drive-In Doors |
| Available Area: | ±150,000 SF | Ceiling Height: | 17'-19'; 3,000 SF has 28' |
| Site: | ±59 Acres | Column Spacing: | 50' x 60' |
| Parking: | 200 paved spaces | Dimensions: | 300' x 700' |
| Year Built: | 1970 (Renovations in 2015) | HVAC: | 100% air conditioned |
| Construction: | | Sprinkler: | 100% wet system |
| Walls: | Concrete | Lighting: | T-5- Installed 2008 |
| Floors: | 6" reinforced concrete | Power: | 4,000 amps; 5,000 KVA |
| Roof: | TPO -Installed: 2007 | Former Use: | Cable Wire Manufacturing |
| Rail: | 1 Spur with 2 rail lines; Served by Norfolk Southern | Lease Rate: | \$3.25 PSF NNN |

CHUCK W. SALLEY, SIOR
803 401 4266 DIRECT
chuck.salley@colliers.com

DAVE MATHEWS, SIOR
803 401 4293 DIRECT
dave.mathews@colliers.com

THOMAS BEARD
803 401 4247 DIRECT
thomas.beard@colliers.com

DON MOSS, CCIM, SIOR
704 409 2372 DIRECT
don.moss@colliers.com

COLLIERS INTERNATIONAL
1301 Gervais Street, Suite 600
Columbia, South Carolina 29201
www.colliers.com

Old York Road > Site Plan

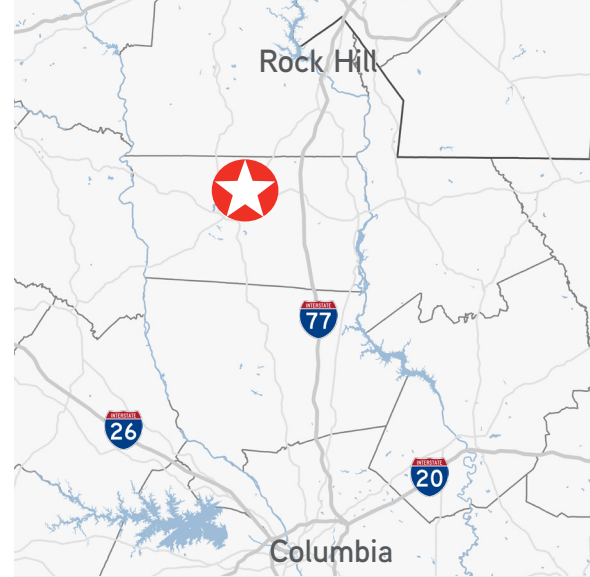
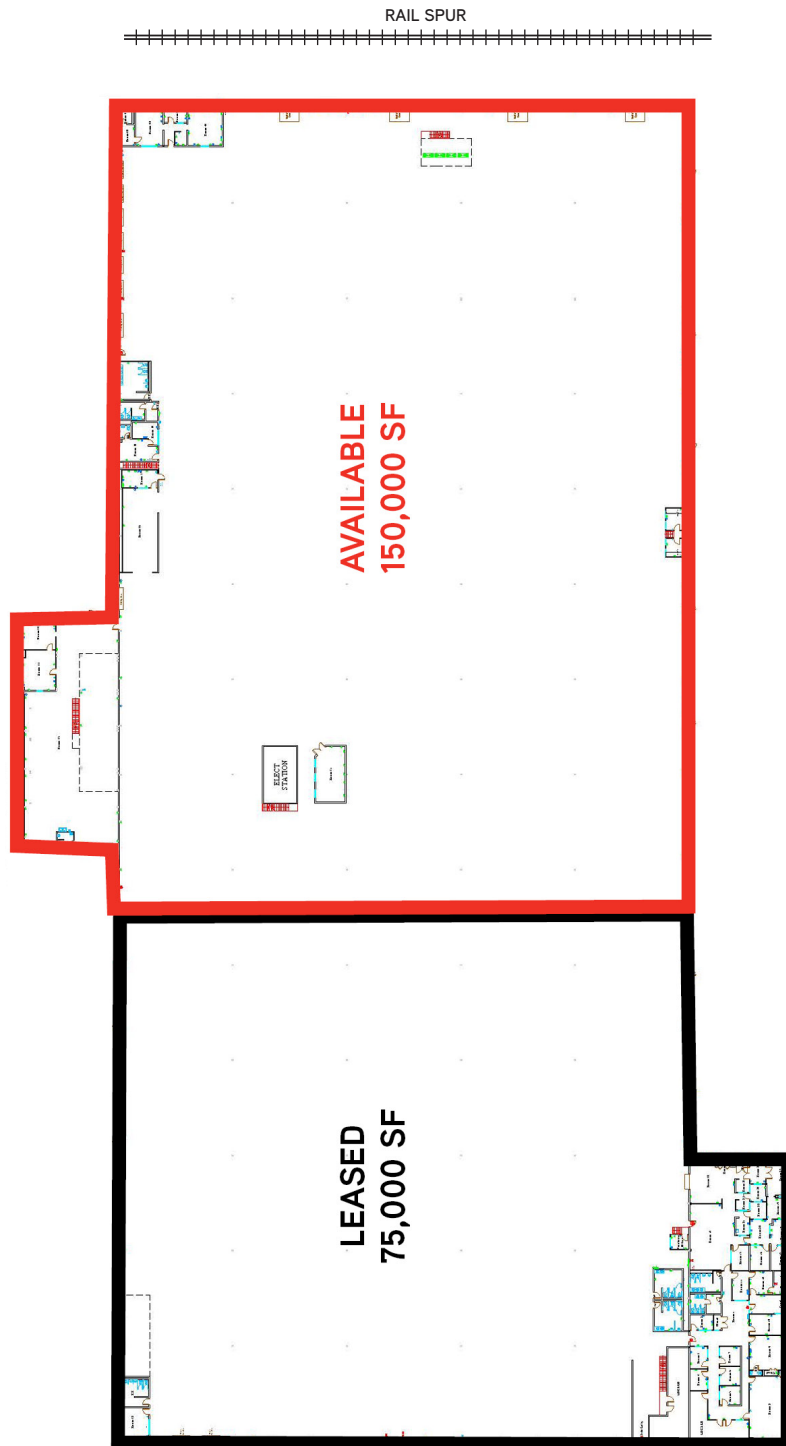

Contact Us

CHUCK W. SALLEY, SIOR
803 401 4266 DIRECT
chuck.salley@colliers.com

DAVE MATHEWS, SIOR
803 401 4293 DIRECT
dave.mathews@colliers.com

THOMAS BEARD
803 401 4247 DIRECT
thomas.beard@colliers.com

DON MOSS, CCIM, SIOR
704 409 2372 DIRECT
don.moss@colliers.com

COLLIERS INTERNATIONAL
1301 Gervais Street, Suite 600
Columbia, South Carolina 29201
www.colliers.com