

FOR LEASE > SUITE L \pm 1,800

5000 East Second Street

BENICIA, CALIFORNIA



Located Within the Benicia Industrial Park



Property Description

- > \pm 1,800 SF (30' x 60')
- > Easy Access to I-680 and I-780
- > Ideal for R&D/Light Industrial
- > Zoned: (GI) General Industrial (allows light manufacturing & warehouse related uses)
- > 2/1,000 parking ratio per unit
- > One (1) Grade Level Door (12'x12') per unit

Building Features

- > \pm 560 SF of Office area and \pm 1,240 SF of Warehouse area (shell)
- > 100 Amp, 208 Volt, 3-Phase Power per unit
- > Clear Height: 16' – 18'
- > Fire Sprinklers
- > Insulated Ceiling
- > Plumbed shop sink in warehouse
- > Ideal for R&D / Light Industrial

PLEASE CALL FOR ADDITIONAL DETAILS

The information furnished has been obtained from sources we deem reliable and is submitted subject to errors, omissions and changes. Although Colliers International has no reason to doubt its accuracy, we do not guarantee it. All information should be verified by the recipient prior to lease, purchase, exchange, or execution of legal documents. © 2012 Colliers International

CHRIS PETRINI
Ph. +1 707 863 8387
Cell +1 510 507 8665
chris.petrini@colliers.com
CA License No. 01020505

BRET DEMARTINI, CCIM
Ph. +1 707 863 8397
Cell +1 707 322 2108
bret.demartini@colliers.com
CA License No. 00853110

COLLIERS INTERNATIONAL
360 Campus Lane, Suite 101
Fairfield, CA 94534
www.colliers.com/fairfield

FOR LEASE > OFFICE/WAREHOUSE

5000 East Second Street - Suite L

BENICIA, CALIFORNIA

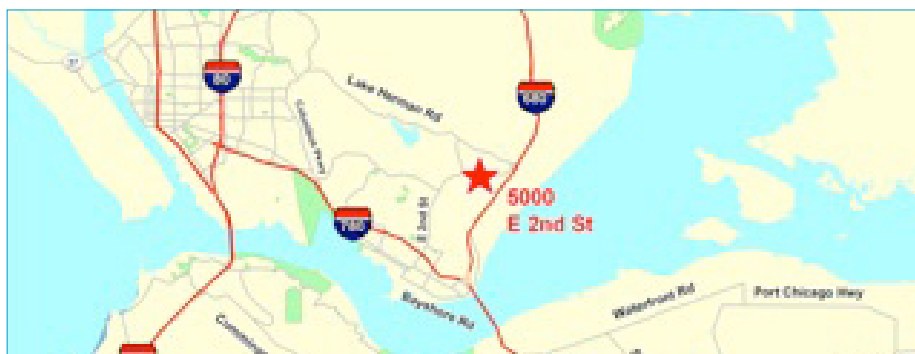
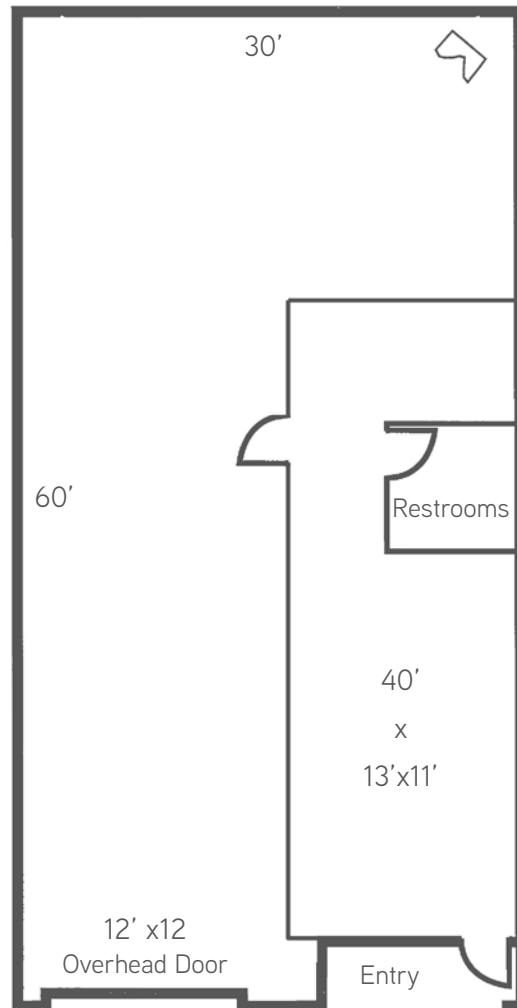

CHRIS PETRINI
Ph. +1 707 863 8387
Cell +1 510 507 8665
chris.petrini@colliers.com
CA License No. 01020505

BRET DEMARTINI, CCIM
Ph. +1 707 863 8397
Cell +1 707 322 2108
bret.demartini@colliers.com
CA License No. 00853110

COLLIERS INTERNATIONAL
360 Campus Lane, Suite 101
Fairfield, CA 94534
www.colliers.com/fairfield