

FOR SALE OR LEASE > RETAIL / OFFICE

# CITIZENS BANK

20800 GREENFIELD ROAD | OAK PARK, MICHIGAN



## TRAFFIC COUNTS OF 34,000

### > PROPERTY HIGHLIGHTS

- 14,480 Square Foot Two Story Building on a 124' x 271' Lot
- First Floor – 4,680 SF Retail/Office Space  
Second Floor – 8,836 SF Office Space
- 2,730 SF on the First Floor is Currently Leased to Citizens Bank Until Second Quarter 2018

### > DEMOGRAPHICS

	1 MILE	3 MILE	5 MILE
POPULATION	15,284	150,303	371,705
AVG. INCOME	\$46,498	\$52,521	\$59,890
HOUSEHOLDS	6,467	61,497	157,306

**COLLIERS INTERNATIONAL**

2 Corporate Drive | Suite 300

Southfield, Michigan 48076

For More Information Call:

**BEN HUBERT**

PHONE 248 540 1000 EXT 1864

EMAIL [ben.hubert@colliers.com](mailto:ben.hubert@colliers.com)



**BEN ROSENZWEIG**

PHONE 248 540 1000 EXT 1866

EMAIL [ben.rosenzweig@colliers.com](mailto:ben.rosenzweig@colliers.com)



[colliers.com/detroit](http://colliers.com/detroit)



FOR SALE OR LEASE > RETAIL / OFFICE

# CITIZENS BANK

20800 GREENFIELD ROAD | OAK PARK, MICHIGAN



## > FLOOR PLAN

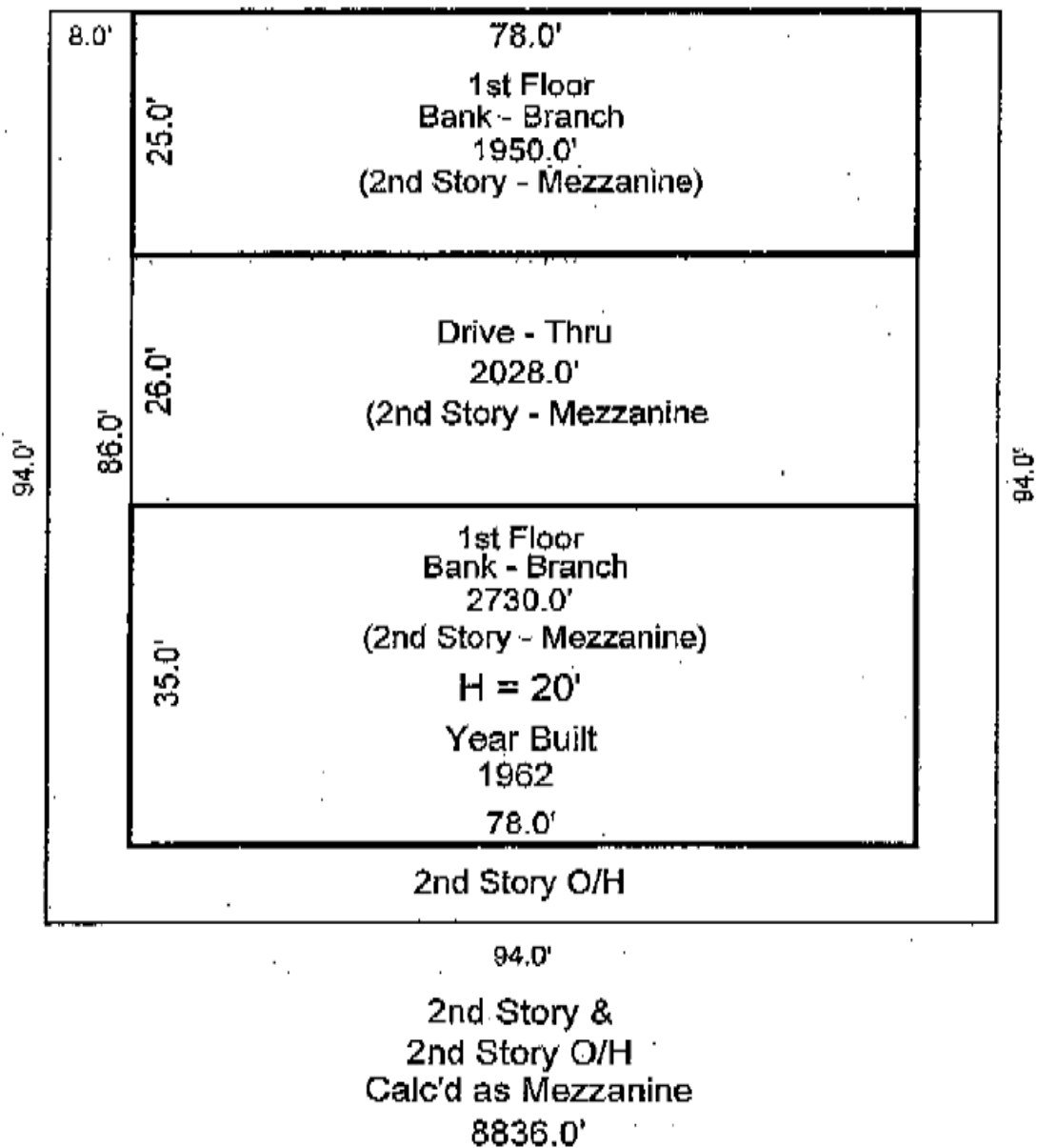

**BEN HUBERT**

PHONE 248 540 1000 EXT 1864  
EMAIL [ben.hubert@colliers.com](mailto:ben.hubert@colliers.com)



**BEN ROSENZWEIG**

PHONE 248 540 1000 EXT 1866  
EMAIL [ben.rosenzweig@colliers.com](mailto:ben.rosenzweig@colliers.com)

FOR SALE OR LEASE > RETAIL / OFFICE

# CITIZENS BANK

20800 GREENFIELD ROAD | OAK PARK, MICHIGAN



## > SITE PLAN



**BEN HUBERT**

PHONE 248 540 1000 EXT 1864  
EMAIL [ben.hubert@colliers.com](mailto:ben.hubert@colliers.com)



**BEN ROSENZWEIG**

PHONE 248 540 1000 EXT 1866  
EMAIL [ben.rosenzweig@colliers.com](mailto:ben.rosenzweig@colliers.com)

FOR SALE OR LEASE > RETAIL / OFFICE

# CITIZENS BANK

20800 GREENFIELD ROAD | OAK PARK, MICHIGAN



## > PROPERTY PHOTOS



**BEN HUBERT**

PHONE 248 540 1000 EXT 1864  
EMAIL [ben.hubert@colliers.com](mailto:ben.hubert@colliers.com)



**BEN ROSENZWEIG**

PHONE 248 540 1000 EXT 1866  
EMAIL [ben.rosenzweig@colliers.com](mailto:ben.rosenzweig@colliers.com)



**CITIZENS BANK**



## > LOCATION MAP

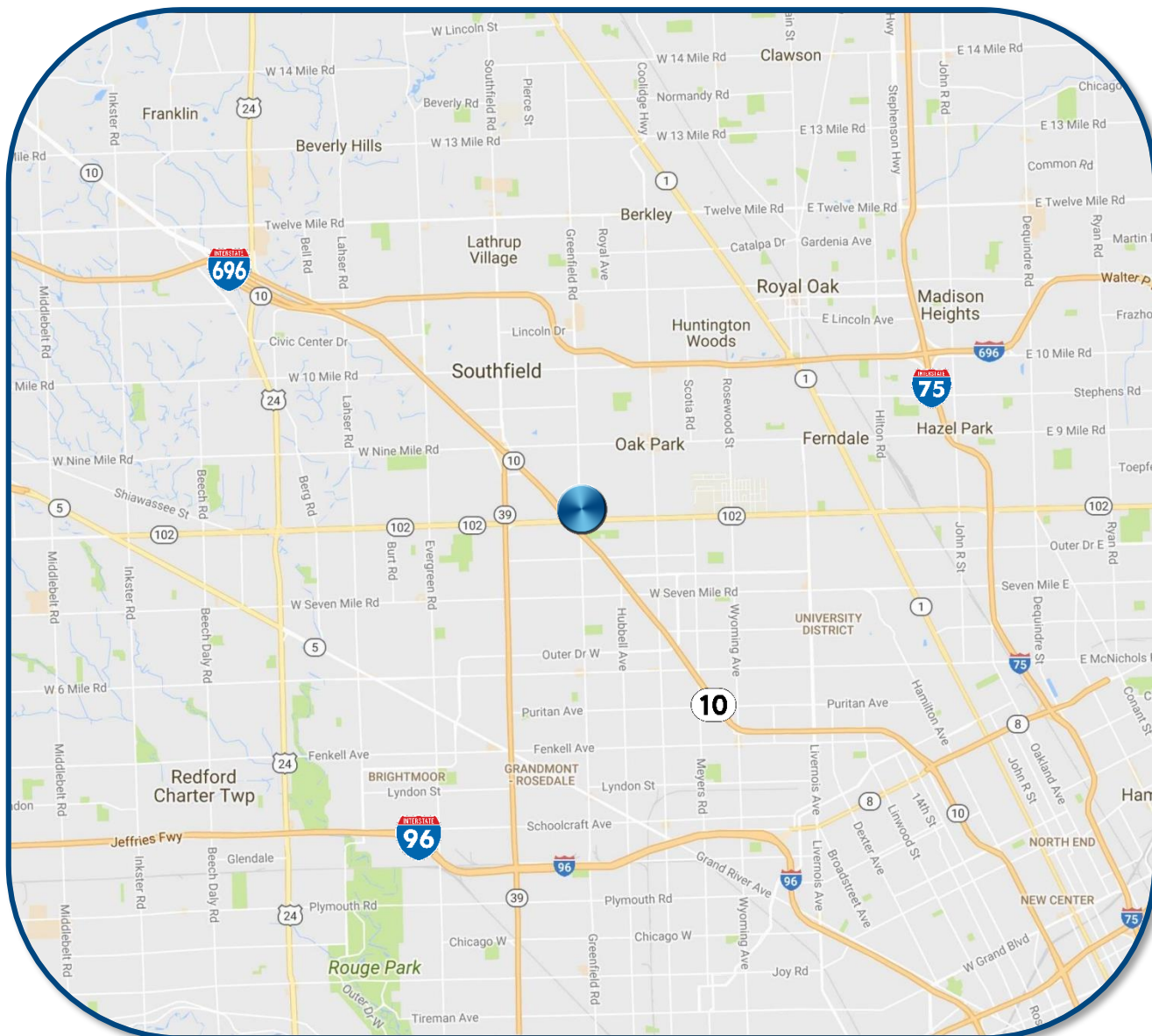

PHONE 248 540 1000 EXT 1866  
EMAIL [ben.rosenzweig@colliers.com](mailto:ben.rosenzweig@colliers.com)

FOR SALE OR LEASE > RETAIL / OFFICE

# CITIZENS BANK

20800 GREENFIELD ROAD | OAK PARK, MICHIGAN



## > AREA MERCHANT MAP

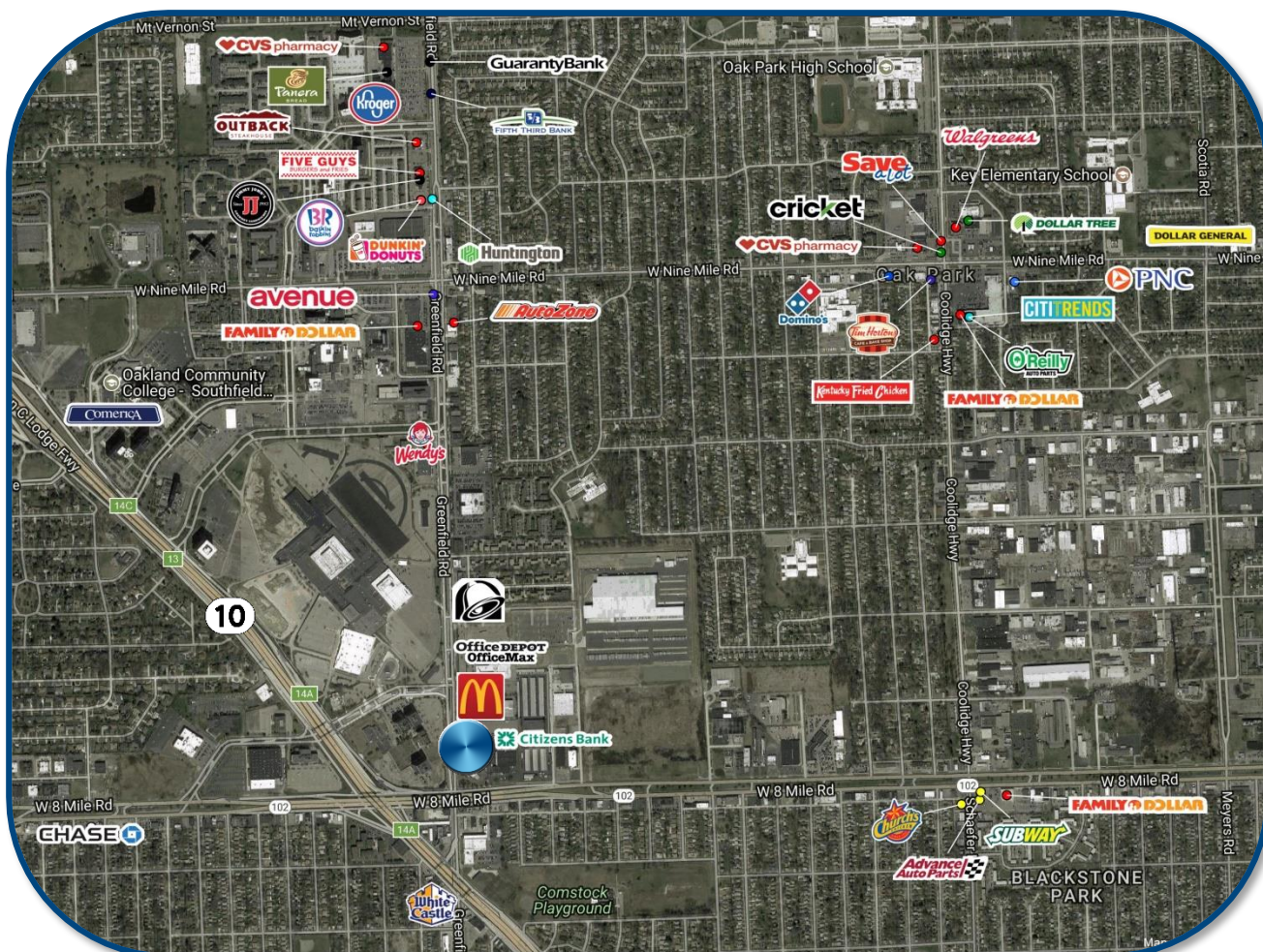

**BEN HUBERT**

PHONE 248 540 1000 EXT 1864

EMAIL [ben.hubert@colliers.com](mailto:ben.hubert@colliers.com)



**BEN ROSENZWEIG**

PHONE 248 540 1000 EXT 1866

EMAIL [ben.rosenzweig@colliers.com](mailto:ben.rosenzweig@colliers.com)



# SUMMARY PROFILE

2000-2010 Census, 2017 Estimates with 2022 Projections

Calculated using Weighted Block Centroid from Block Groups



Lat/Lon: 42.4465/-83.2001

RS1

20800 Greenfield Rd

Oak Park, MI 48237-3051

1 mi radius

3 mi radius

5 mi radius

POPULATION	2017 Estimated Population	15,284	150,303	371,705
	2022 Projected Population	14,989	147,164	374,180
	2010 Census Population	15,623	156,746	384,794
	2000 Census Population	18,590	181,799	460,831
	Projected Annual Growth 2017 to 2022	-0.4%	-0.4%	0.1%
	Historical Annual Growth 2000 to 2017	-1.0%	-1.0%	-1.1%
	2017 Median Age	43.1	41	39.6
HOUSEHOLDS	2017 Estimated Households	6,467	61,497	157,306
	2022 Projected Households	6,502	61,894	162,644
	2010 Census Households	6,336	61,907	157,098
	2000 Census Households	7,332	68,245	176,912
	Projected Annual Growth 2017 to 2022	0.1%	0.1%	0.7%
	Historical Annual Growth 2000 to 2017	-0.7%	-0.6%	-0.7%
RACE AND ETHNICITY	2017 Estimated White	9.3%	19.2%	31.3%
	2017 Estimated Black or African American	86.9%	76.7%	64.1%
	2017 Estimated Asian or Pacific Islander	1.1%	1.1%	1.4%
	2017 Estimated American Indian or Native Alaskan	0.2%	0.2%	0.3%
	2017 Estimated Other Races	2.5%	2.8%	2.9%
	2017 Estimated Hispanic	1.4%	1.5%	1.9%
INCOME	2017 Estimated Average Household Income	\$46,498	\$52,521	\$59,890
	2017 Estimated Median Household Income	\$41,373	\$45,596	\$50,289
	2017 Estimated Per Capita Income	\$19,843	\$21,573	\$25,443
EDUCATION (AGE 25+)	2017 Estimated Elementary (Grade Level 0 to 8)	3.0%	2.8%	2.8%
	2017 Estimated Some High School (Grade Level 9 to 11)	7.0%	7.9%	8.4%
	2017 Estimated High School Graduate	32.1%	28.8%	26.1%
	2017 Estimated Some College	29.3%	28.1%	26.4%
	2017 Estimated Associates Degree Only	7.1%	8.0%	7.6%
	2017 Estimated Bachelors Degree Only	12.9%	14.8%	17.1%
	2017 Estimated Graduate Degree	8.6%	9.5%	11.7%
BUSINESS	2017 Estimated Total Businesses	1,173	6,345	16,619
	2017 Estimated Total Employees	12,024	55,535	155,671
	2017 Estimated Employee Population per Business	10.2	8.8	9.4
	2017 Estimated Residential Population per Business	13.0	23.7	22.4

This report was produced using data from private and government sources deemed to be reliable. The information herein is provided without representation or warranty.