

AVAILABLE FOR LEASE

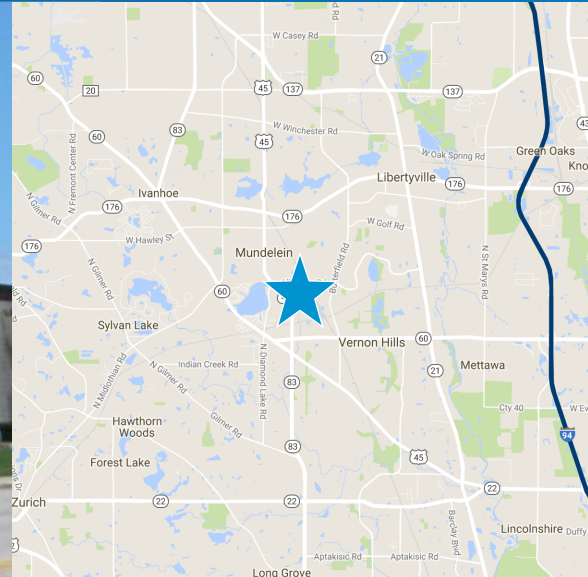

# 750 Tower Road

MUNDELEIN, IL



## About This Property

- › Total Building Size: 42,417 SF
- › Available: 11,049 SF - Unit D
- › Office: 1,900 SF
- › Free-standing industrial building
- › 800 amps
- › 15'5" ceiling height
- › Two (2) exterior loading docks (common)
- › One (1) drive-in door
- › 33 car parking
- › Lease rate: \$6.75/SF net
- › Low Lake County taxes

## Contact Us

NED FRANK

847 698 8261

[ned.frank@colliers.com](mailto:ned.frank@colliers.com)

No warranty or representation is made to the accuracy of the foregoing information.  
Terms of sale or lease and availability are subject to change or withdrawal without notice.

**COLLIERS INTERNATIONAL**  
6250 N. River Road, Suite 11-100  
Rosemont, IL 60018  
[www.colliers.com](http://www.colliers.com)

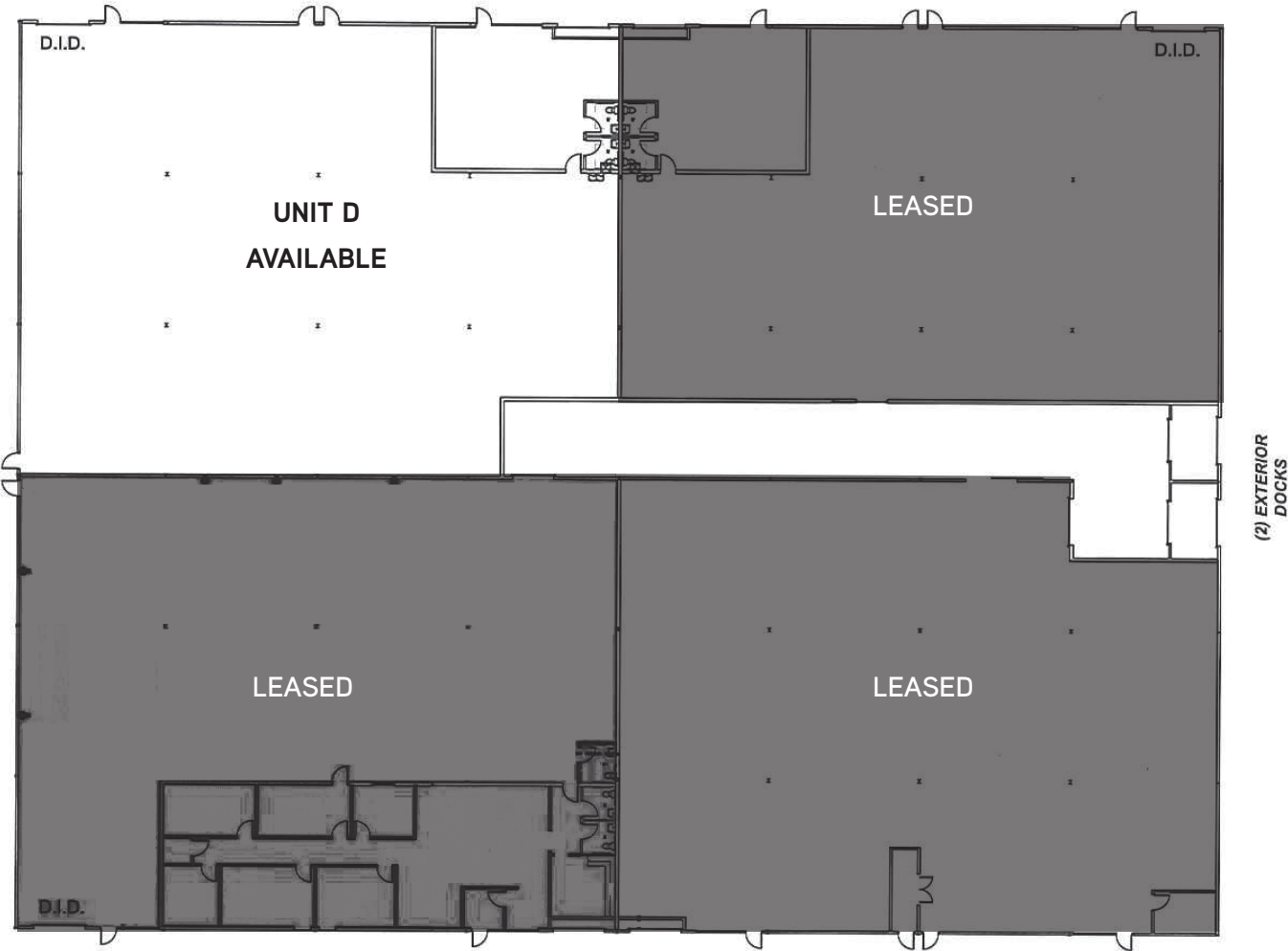

## 750 Tower Road - Mundelein, IL > Aerial

