



**For Lease**

**Contact Brokers  
for Pricing**

**Contact us:**

**Jerry Matson, SIOR, MBA**  
Vice Chairman  
+1 503 499 0077  
jerry.matson@colliers.com

**Brian Yoakum, SIOR**  
Senior Vice President  
+1 503 499 0070  
brian.yoakum@colliers.com

**Tom Knecht, SIOR**  
Vice President  
+1 503 499 0069  
tom.knecht@colliers.com

# Airport Park

**±13,950 SF with ±2,855 SF Office**

5964 NE 87th Ave, Portland, OR 97220

**Quality Industrial Park Located Minutes  
from PDX and Interstate 205**

## Property Highlights

- Rare stand-alone building
- Conveniently located adjacent to the Portland International Airport
- Immediate access to transportation networks and support services
- General Industrial (IG2h) zoning provides for a variety of uses
- Gated and secured yard area
- Located in an established industrial neighborhood

# Warehouse Plan



## Building Overview

13,950 SF industrial building

2,855 SF total office

20' clear height

15 dock doors

2 grade doors

Gas-fired direct-expansion (DX) package HVAC

400 amp, 480v, 3 phase power

Centrally located in the Airport Way submarket

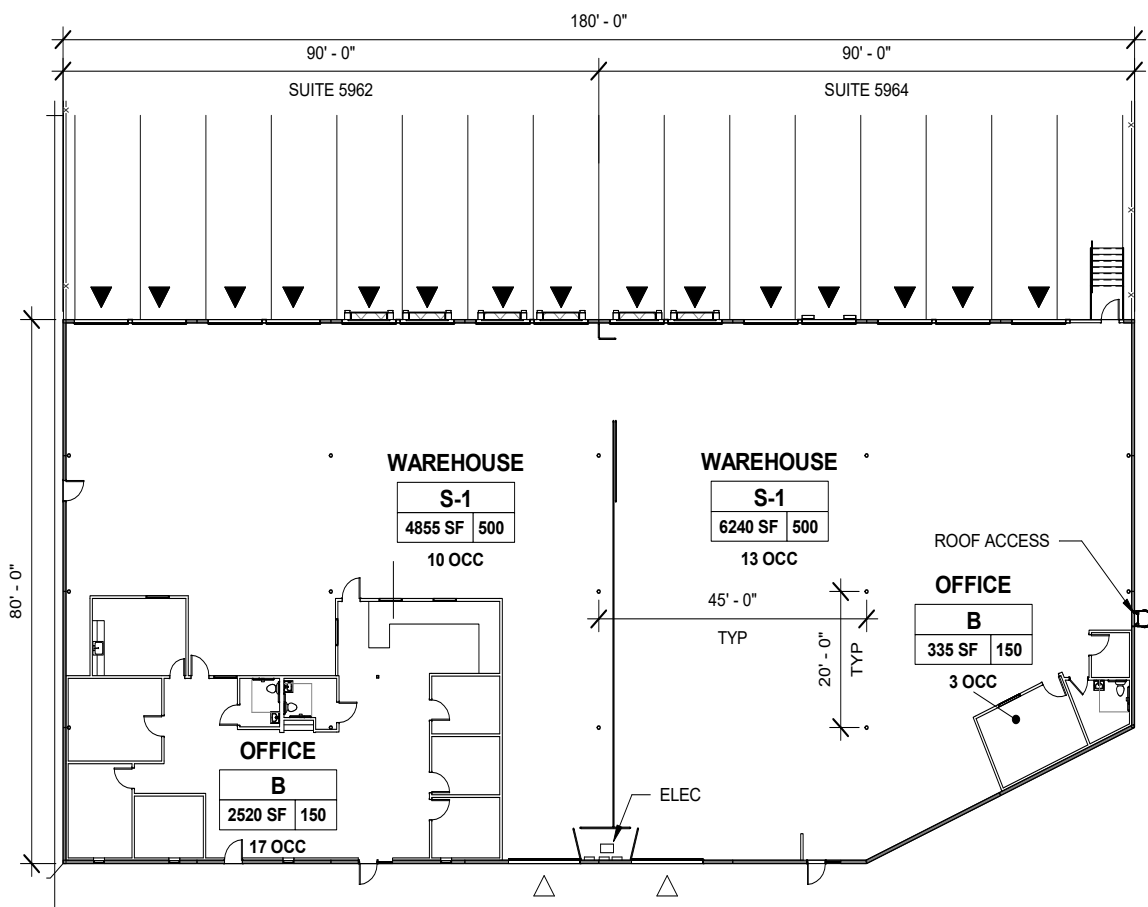

# Access & Corporate Neighbors



5964 NE 87TH AVE



	<b>INTERSTATE 5</b> 9 miles 14 minute drive		<b>DOWNTOWN PORTLAND</b> 10 miles 15 minutes
	<b>INTERSTATE 205</b> 1 miles 1 minute drive		<b>PDX INTERNATIONAL AIRPORT</b> 2 miles 3 minute drive
	<b>INTERSTATE 84</b> 2 miles 4 minute drive		<b>SR 14</b> 4 miles 5 minute drive

- UNITED STATES POSTAL SERVICE
- FedEx
- @part
- GoBuy
- labcorp
- NV COLLEGE OF CONSTRUCTION
- canSOURCE
- MISSION
- ceva LOGISTICS
- Forward
- DANONE
- KWE Kinetico World Express
- TOYOTA
- PORTLAND COFFEE ROASTERS
- SIERRA
- SUPER+PRODIGE
- Yoshida Group
- PORTLAND COFFEE ROASTERS
- IKEA
- coffee bean INTERNATIONAL
- VENTURA FOODS
- Veritiv
- SPRAGUE
- NOVA CABINETRY
- LIVE EDGE SLABS OF PORTLAND, LLC
- Meeder Equipment
- PCC Structuralis, Inc.
- RO
- IMMACULATE ESSENCE
- PORT OF PORTLAND
- LEO Sky Chefs
- SUMNER COLLEGE
- LANDMARK
- WESTERN POWERPOOL
- ALLIANCE
- RICHARDS
- KeHE

NE Lombard St



# Property Photos & Map

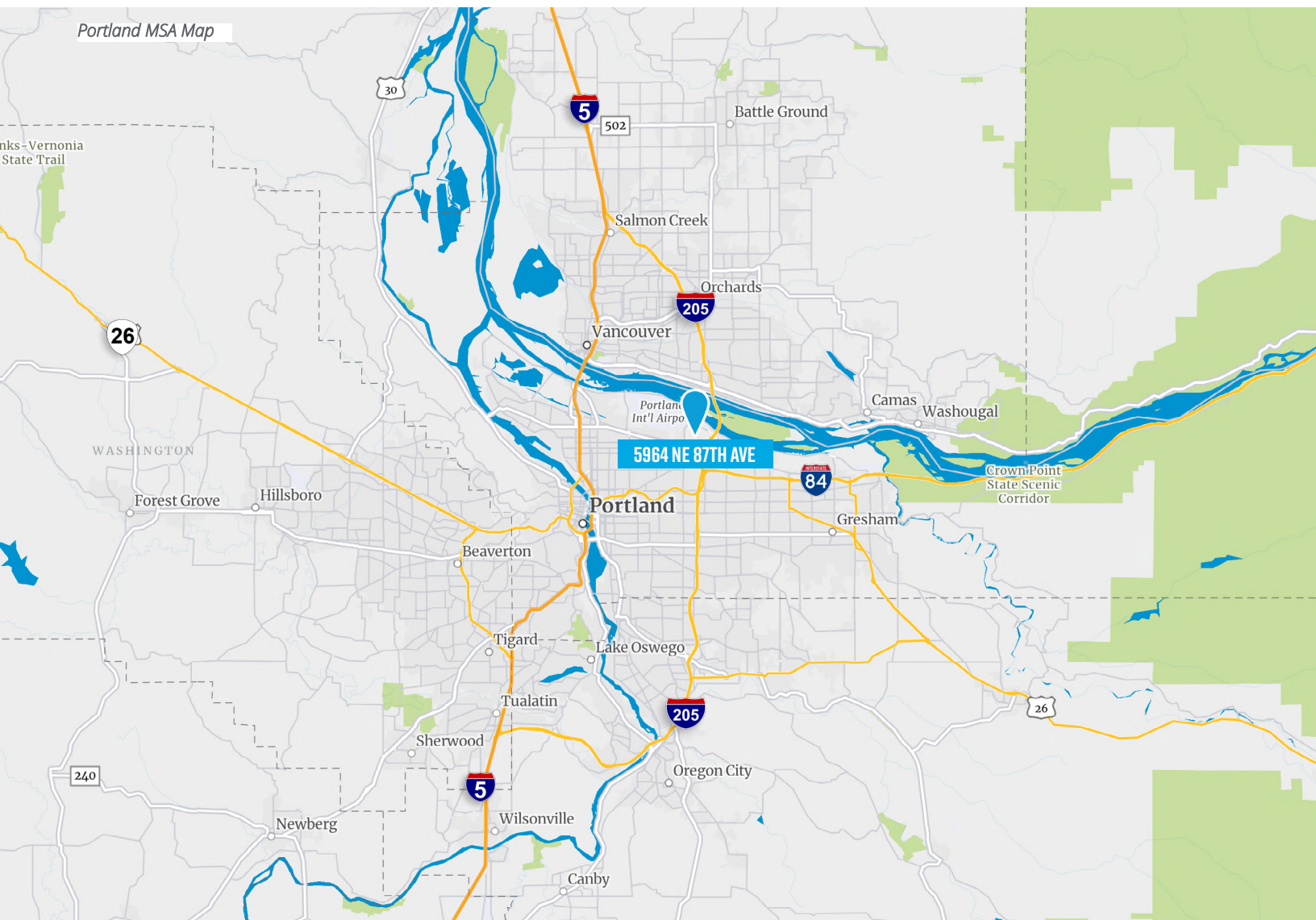

## Contact us:

**Jerry Matson, SIOR, MBA**  
Vice Chairman  
+1 503 499 0077  
jerry.matson@colliers.com

**Brian Yoakum, SIOR**  
Senior Vice President  
+1 503 499 0070  
brian.yoakum@colliers.com

**Tom Knecht, SIOR**  
Vice President  
+1 503 499 0069  
tom.knecht@colliers.com