

FOR LEASE INDUSTRIAL BUILDING > OFFICE SPACE

4524 DISTRICT BLVD., BAKERSFIELD, CA 93313



OSCAR BALTAZAR
SENIOR VICE PRESIDENT | PRINCIPAL
INDUSTRIAL PROPERTIES TEAM
CENTRAL CALIFORNIA
DIR 661 631 3819
LICENSE NUMBER 01263421
oscar.baltazar@colliers.com

COLLIERS INTERNATIONAL
10000 Stockdale Hwy, Suite 102
Bakersfield, CA 93311
DIR 661 631 3800
www.colliers.com/bakersfield



FOR LEASE

INDUSTRIAL BUILDING > OFFICE SPACE

PROPERTY INFORMATION

4524 DISTRICT BLVD., BAKERSFIELD, CA 93313

4524 District Boulevard is located in the Stockdale Industrial Park, just south of White Lane in Southwest Bakersfield.

AVAILABLE

4,000 s.f. Industrial building situated on .4 acres of land and small paved and secured parking area approximately 1 mile west of Highway 99.

FOR LEASE

\$4,000.00/Month Full Service

DESCRIPTION

- > Office Size: 4,000 SF
- > Parcel Size: .4 acres
- > Zoning: M-1
- > Six (6) private offices
- > One (1) large reception area
- > One (1) bullpen/storage area
- > Two (2) private restrooms
- > One (1) kitchen area



Colliers
INTERNATIONAL

FOR LEASE

INDUSTRIAL BUILDING > OFFICE SPACE

FLOOR PLAN > INTERIOR PHOTOS

4524 DISTRICT BLVD., BAKERSFIELD, CA 93313

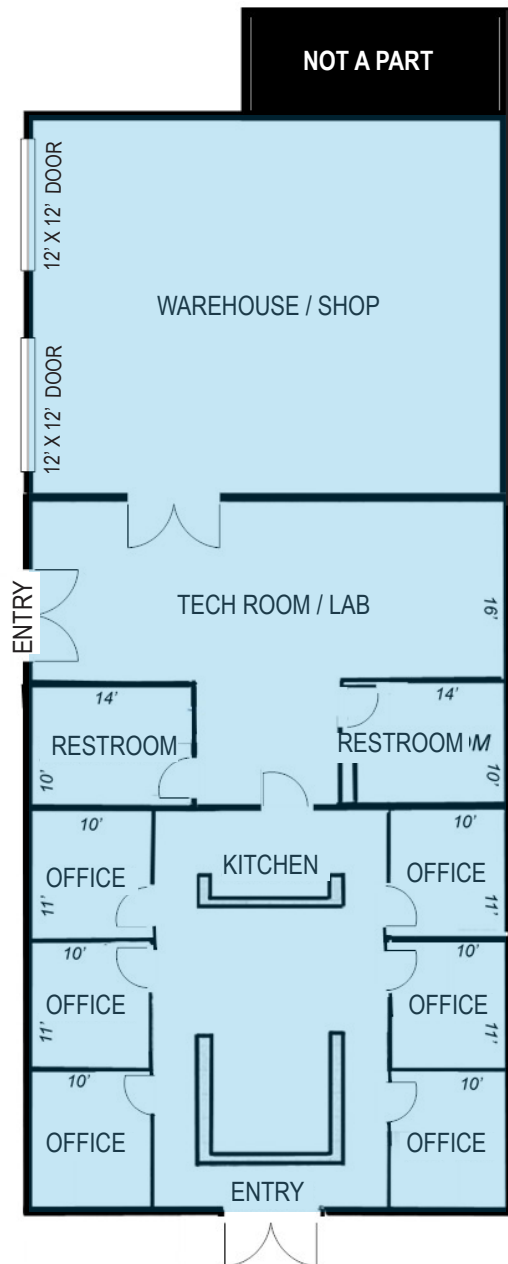

COLLIERS INTERNATIONAL
10000 Stockdale Hwy, Suite 102
Bakersfield, CA 93311
661 631 3800
www.colliers.com/bakersfield



FOR LEASE INDUSTRIAL BUILDING > OFFICE SPACE AERIAL MAP > LOCATION MAP

4524 DISTRICT BLVD., BAKERSFIELD, CA 93313



CONTACT US

OSCAR BALTAZAR
SENIOR VICE PRESIDENT | PRINCIPAL
INDUSTRIAL PROPERTIES TEAM
CENTRAL CALIFORNIA
661 631 3819
LICENSE NUMBER 01263421
oscar.baltazar@colliers.com

COLLIERS INTERNATIONAL
10000 Stockdale Hwy, Suite 102
Bakersfield, CA 93311
661 631 3800
www.colliers.com/bakersfield

